

PUGGLE



Dreamy Bedside Crib

Instruction Manual

Welcome

Thank you for purchasing the Puggle Dreamy Bedside Crib.

This instruction manual will guide you through the setup, use, and maintenance of your new crib, ensuring you get the most out of its versatile features. Please read through the following information and safety warnings carefully to fully understand and enjoy all the benefits your crib has to offer, and to ensure its safe operation.

We're here to help!

If you have a query with this product or require replacement parts, please contact us at:
support@pugglebaby.co.uk

Important Information



IMPORTANT! Your Dreamy Bedside Crib may differ slightly from images shown above and throughout, as the images are for illustration purposes only.

Your Dreamy Bedside Crib is tested to comply with EN 1130:2019 and EN 16890:2017.

- **DO NOT** use parts or accessories which are not approved or supplied by the manufacturer.

Safety Instructions

IMPORTANT – Read the instructions carefully before use and keep for future reference.

- **WARNING:** This product is intended for use for babies aged between 0 and 6 months, weighing up to a maximum of 9kg.
- **WARNING:** When a child is able to sit, kneel or to pull itself up, the crib shall not be used anymore for this child.
- **WARNING:** DO NOT use the product if any part is broken, torn or missing.
- **WARNING:** Be aware of the risk of burning cigarettes, open fires and other sources of strong heat, such as electric bar fires, gas fires etc. near the crib.

Warning

- **WARNING:** Before assembly, check that the product and all of its components have not been damaged during transportation. Should any part be damaged, do not use and keep out of reach of children.
- **WARNING:** Make sure the users of this product are knowledgeable on its proper operation.
- **WARNING:** The product is ready for use only when all locking mechanisms are engaged. Check carefully that these are engaged before use.
- **WARNING:** Placing additional items in the product may cause suffocation.
- **WARNING:** Do not place the product close to another product, which could present a danger of suffocation or strangulation, e.g. strings, blind/curtain cords, etc.
- **WARNING:** When the child is left unattended in the product, in "crib mode", always make sure that the side rail is raised and the zips are completely closed.
- **WARNING:** All opening, adjusting, anchoring and positioning operations of the product must be carried out exclusively by an adult.
- **WARNING:** Before use in "co-sleeping mode" (fixed to bed) make sure the product is properly anchored and positioned.
- **WARNING:** When the product is used in "co-sleeping mode" (fixed to bed), before laying the child in it, make sure that the connection belts are hooked and tensioned properly, the product must be secured to the adult mattress and no gaps between the product and the adult mattress must be present.
- **WARNING:** The product must always be placed on a horizontal surface. Never leave the product on an inclined surface with the child inside of it.
- **WARNING:** Children must not be permitted to play without supervision near the product.
- **WARNING:** Do not use the product without the frame.
- **WARNING:** Keep the fastening belts away from the reach of children.
- **WARNING:** Only use the mattress sold with this crib. DO NOT add a second mattress on top of this one - suffocation hazards.
- **WARNING:** Do not use more than one mattress in the product.

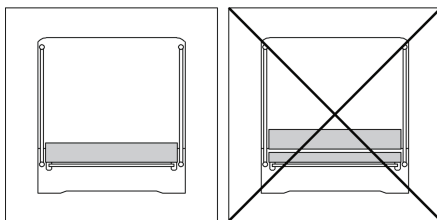

- **WARNING:** The mattress length and width shall be such that the maximum gap between the mattress and the crib sides and ends does not exceed 30mm.
- Mattress size: 800 x 510 x 20mm.
- **WARNING:** The thickness of the mattress must be such that the vertical height (upper surface of the mattress until the upper edge of the product's sides) is at least 200mm.
- **WARNING:** The reference mark on the product's interior indicates the maximum thickness of the mattress that shall be used.

Warning

- **WARNING:** Do not leave any object inside the product that could reduce its depth.
- **WARNING:** Do not position the product near walls and obstacles to prevent trapping hazards.
- **WARNING:** Do not leave small objects inside the product to prevent choking hazards.
- **WARNING:** Use only spare parts approved by the manufacturer. Do not apply accessories to the product, which are not supplied by the manufacturer.
- **WARNING:** Do not adjust the product with the child inside.
- **WARNING:** Do not move the product with the child inside.
- **WARNING:** Do not use the product for more than one child at a time.
- **WARNING:** The product must be kept away from electric cables and cords: do not place the product near windows where cords, curtains or similar objects could pose choking or strangling hazards for the child. To avoid strangling hazards, do not give to your child or place near her/him, objects equipped with cords.
- **WARNING:** All assembly fittings should be tightened properly and care should be taken to ensure no screws are loose, as a child could trap parts of the body or clothing e.g. strings, necklaces, ribbons etc. which could pose a risk of strangulation.
- **WARNING:** A prolonged exposure to the sun may cause changes of tones to the product's colour. After a prolonged exposure of the product to high temperatures, wait a few minutes prior to placing your child in it.
- **WARNING:** When not in use, keep the product away from the reach of children.

CO-SLEEPING MODE (FIXED TO BED)

- **WARNING:** The side support of the crib should always be put close to the adult mattress and the mattress should always be aligned with the height of the side support for restraint of the crib. Furthermore, the crib should be firmly fixed to the structure of the adult bed or to the mattress support.
- **WARNING:** Check to make sure that the crib in the "co-sleeping mode" does not interfere with the adult bed.
- **WARNING:** Use the crib with the tube lowered, only in "co-sleeping mode" (fixed to bed).
- **WARNING:** The height of the adult mattress should always be more than that of the side support for containment of the crib.
- **WARNING:** In "co-sleeping mode" the 2 legs of the crib should always be adjusted to the same height.
- **WARNING:** Before every use always check to make sure that there is no space between the adult mattress and the side of the crib. On a regular basis check the condition of the product and the presence of any possible damage. In the case of damage do not use it and keep it out of reach of children.
- **WARNING:** Gaps should not be filled with pillows, blankets other items.

- **DANGER! Always completely raise the drop side when not attached to the adult's bed.**

Warning

- **WARNING!** To avoid hazards from the child's neck being caught on the top rail on the side that is next to the adult bed, the top rail must not be higher than the adult bed mattress.
- **WARNING!** To avoid the risk of your child being strangled the attachment system to the adult's bed shall always be kept away from and out of the crib.
- **WARNING:** This bedside sleeper is **ONLY** safe for beds between 55.8 cm and 63.5 cm high.
- **WARNING:** This bedside sleeper is suitable for beds with an independent bed edge component which can be attached by the attachment strap of bedside sleeper.
- **WARNING:** The mattress of the adult's bed shall be aligned to or above the height of the drop side in the lowest position.
- THIS BEDSIDE SLEEPER MUST BE ONLY USED WITH STANDARD TYPE ADULT BEDS:

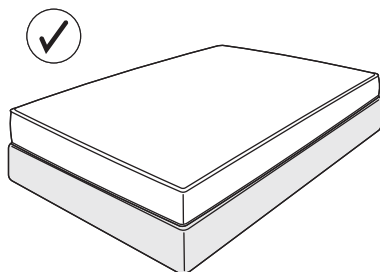

- DO NOT USE the bedside sleeper with atypical shape beds:

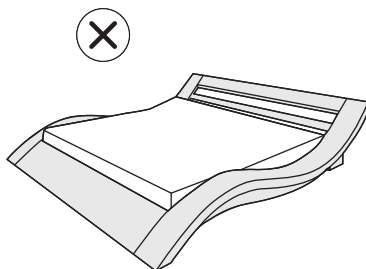
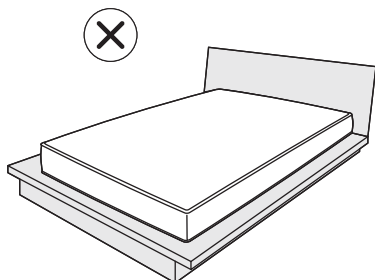

Symbols and their meaning

There are a number of symbols used through this manual, please find below breakdown of what each symbol is and what it means.

 Direction indicator showing direction of assembly, rotation, function.

 Indicates if product is locked or unlocked

 Indicates if step is incorrect or correct

Before Assembly

Before assembly, please ensure that you have read and understood the instructions. Then carefully unpack your crib and ensure that all parts are present. Please see parts list as follows.

What's in the box

- x1 Puggle Dreamy Bedside Crib
- x1 Instruction Manual

Parts List

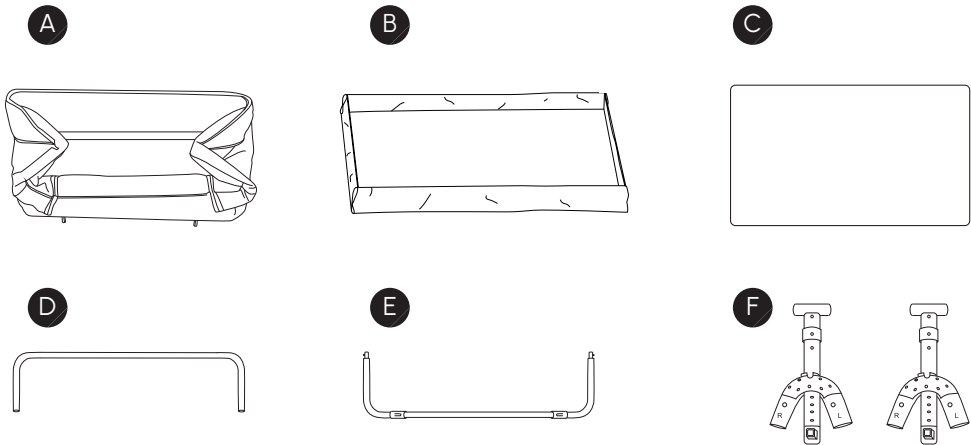

Parts List

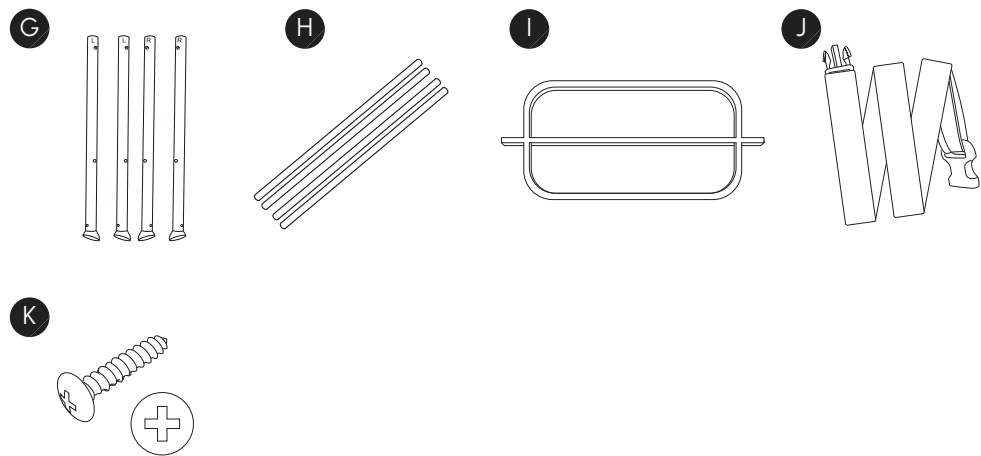

Parts included with your Dreamy Bedside Crib are:

Part	Description	Quantity
A	Crib body	1
B	Storage basket	1
C	Mattress	1
D	Rear crib support tube	1
E	Front crib support tube	1
F	Frame joint	2
G	Legs	4 (2 x left, 2 x right)
H	Frame support tube	4
I	Centre support frame	1
J	Bed attachment straps	2
K	Screws	10 (includes 2 extra)

Tools required: x1 cross head screwdriver

Assembling The Frame

1. Attach the legs (G) into the allocated holes on the frame joints (F). Listen for the "click" to ensure the spring pins are locked in place.

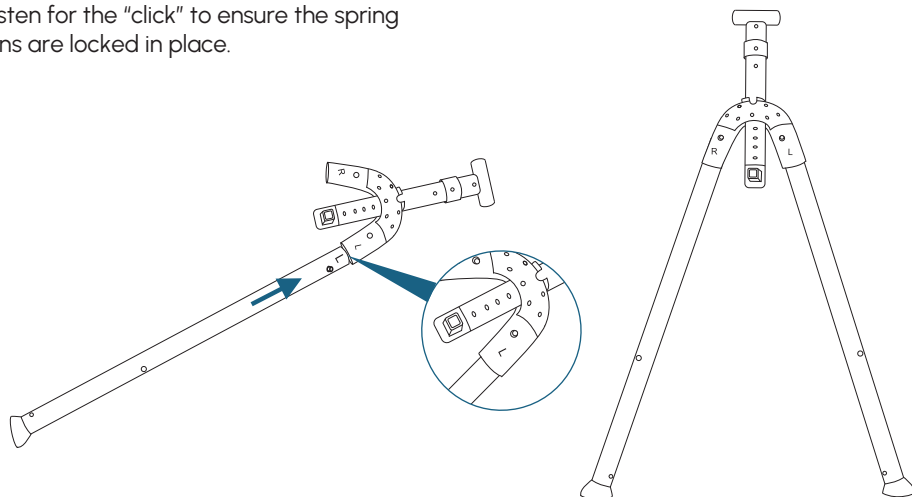

2. Attach the centre support frame (I) in between the two frame joints.

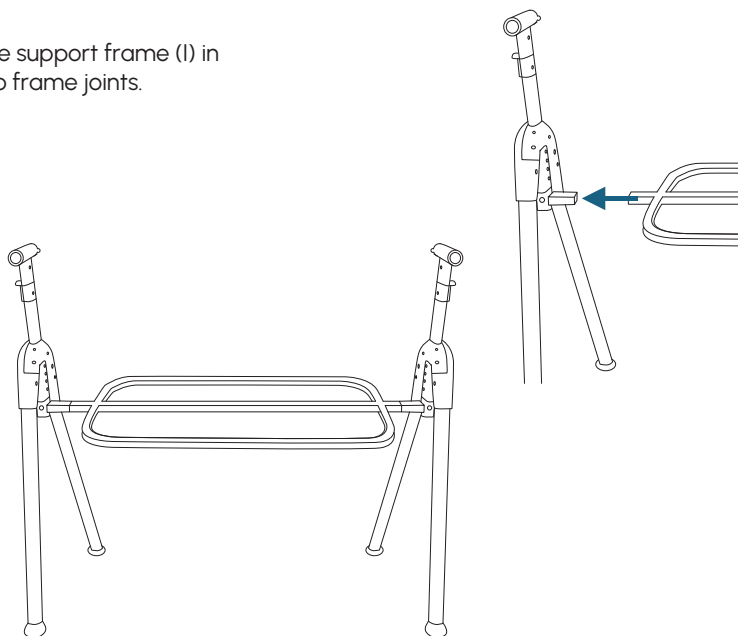

Assembling The Frame

3. Insert frame support tubes (H) into the storage basket (B) side wings. Two either side.

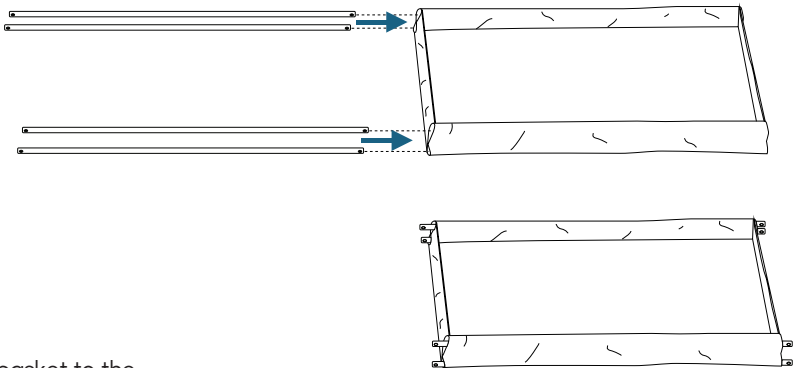

4. Secure the storage basket to the frame with screws (K) and a cross head screwdriver.

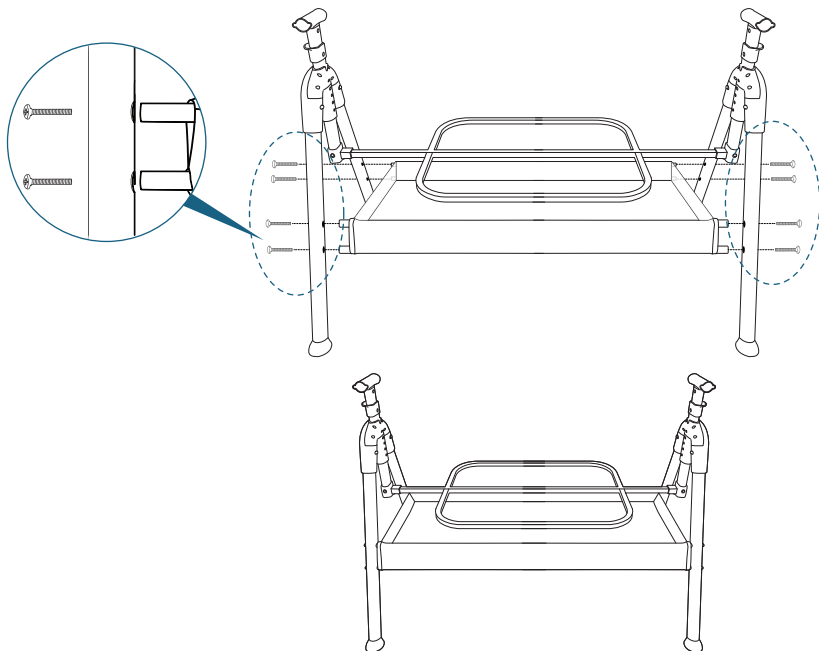

Assembling The Crib

5. Insert the rear crib support tube (D) into the crib joint on both sides. Note: the rear tube is a smooth bar without any joints. Push it in as far as it will go, however, it will not lock at this stage.

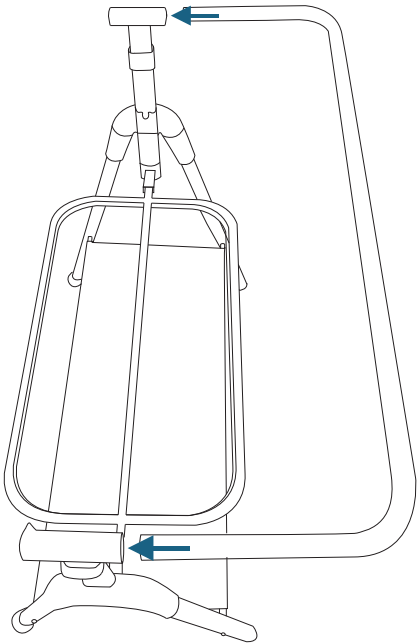

6. Fully undo the zipper along the edge of the crib body (A).

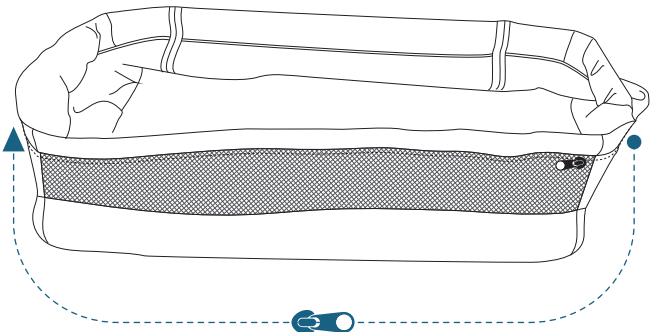

Assembling The Crib

- 7a. Insert the front crib support tube (E) into the opening at the top of the crib body (opposite side from zipper).

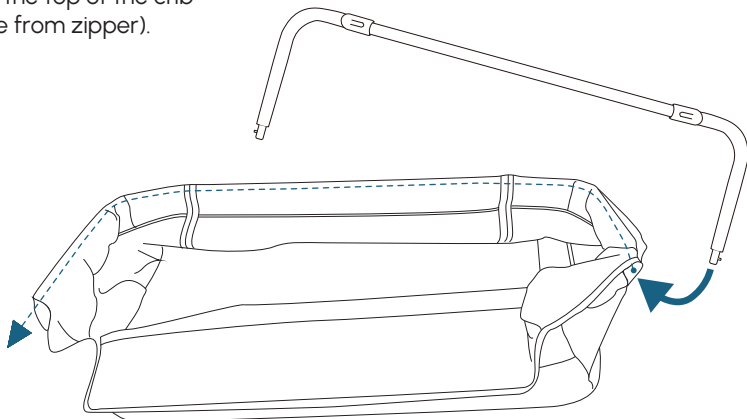

- 7b. With the release buttons on the joints facing down, push the support tube all the way through until it comes out the other end.

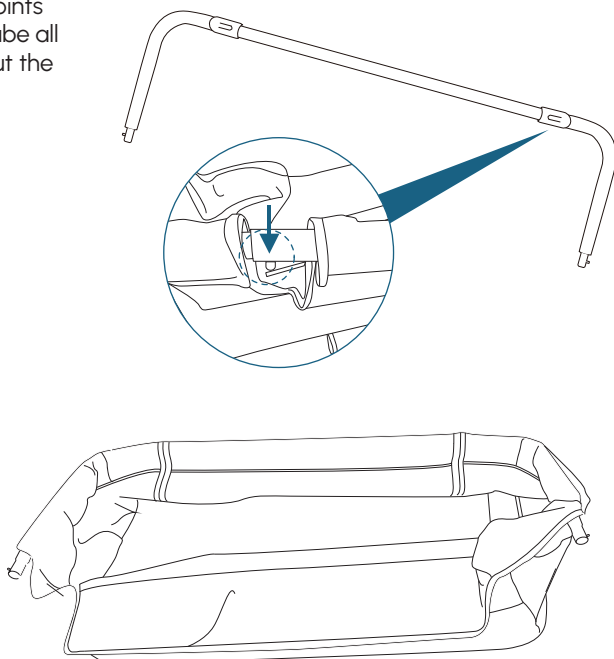

Assembling The Crib

8. Push the front crib support tube into the frame joint on both sides. It should "click" into place, locking both the front and rear crib tubes into place.

Tip: Hold the rear crib support tube in place whilst inserting the front tube.

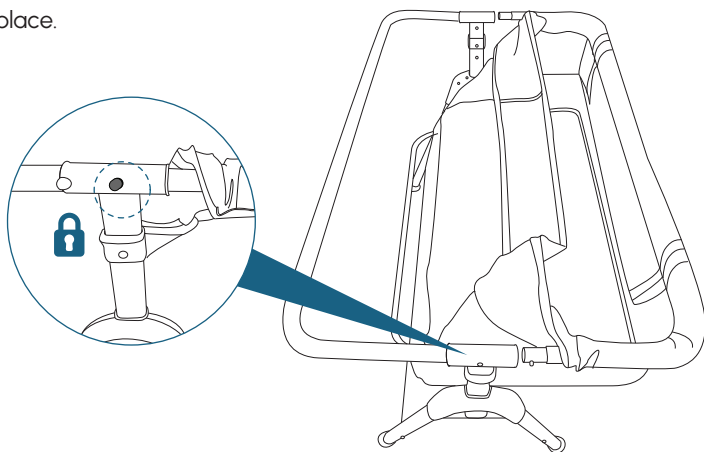

- 9a. Pull the unzipped portion of the crib body back over the rear crib support tube.

- 9b. Close the zipper that was opened in step 6. The zipper should sit below the support tube.

- 9c. Fasten the Velcro loops on the underside of the crib body to the centre support frame.

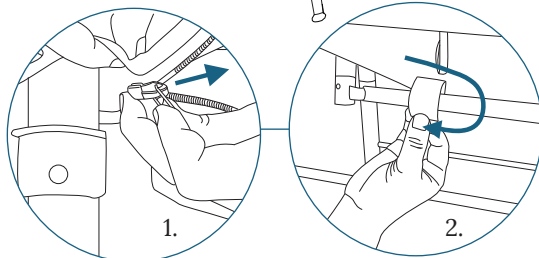
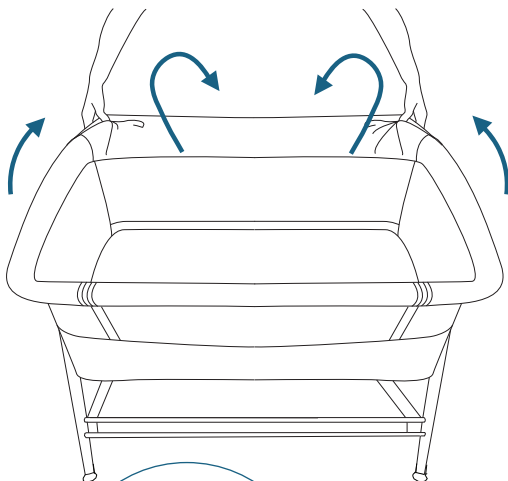

Assembling The Crib

10. Insert the mattress (C) into the crib body.

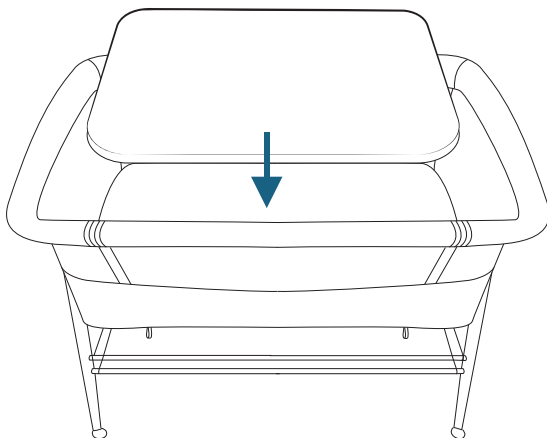

11. The crib is now fully assembled.

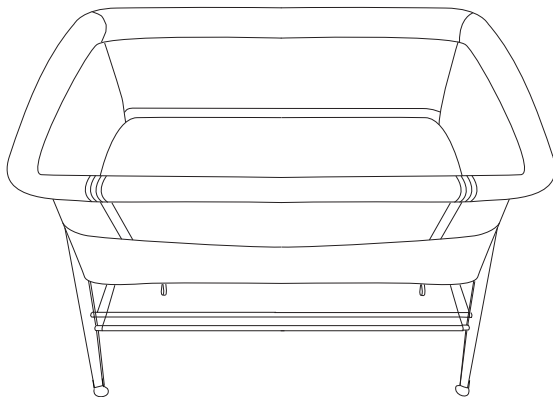

Adjusting The Crib Height

- 12a. Push in buttons on both joints and adjust the crib height to desired position.

There are 5 settings on both ends of the crib.

- 12b. To lock the height, release the triggers. You will hear a “click” as the locks engage.

WARNING: Ensure the height is securely locked in place before you place your baby in the crib.

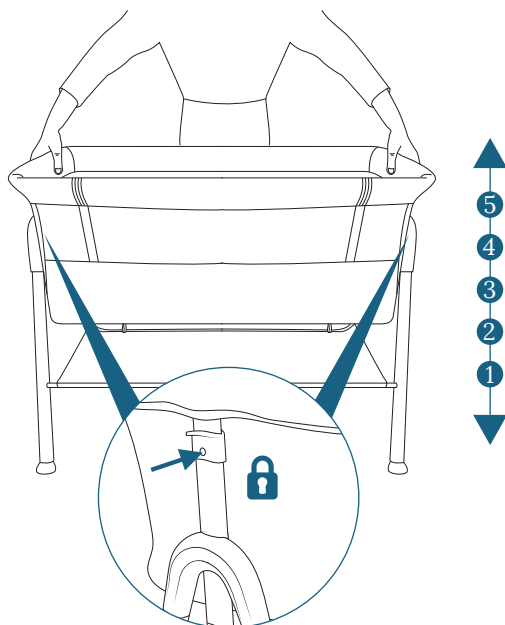

Height incline for reflux

13. The base of the crib can be inclined by adjusting the two legs to different heights.

The crib can be inclined with a maximum variance of 2 positions between one leg and the other (e.g. the right leg in position 3 and the left leg in position 1).

WARNING: The head of the child should always be positioned on the highest side.

WARNING: In “co-sleeping mode” the 2 legs of the crib should always be adjusted to the same height.

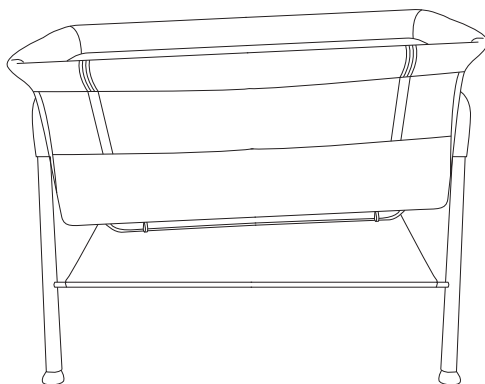

Co-Sleeper Mode (Fixed To Bed)

14. Open the side of the crib using the zips and open them completely.

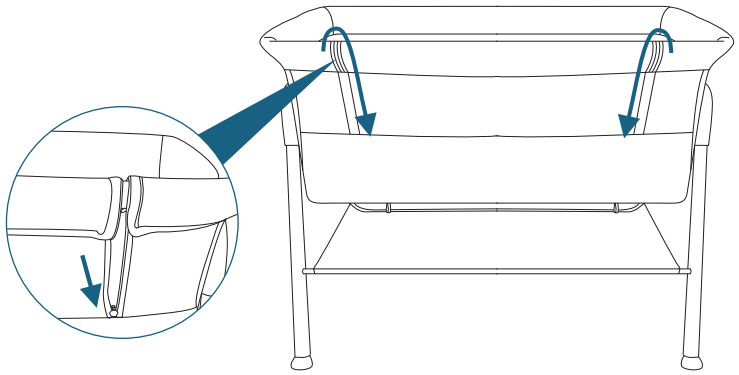

- 15a. Push in the release button and pull the top rail out to release the tube. Repeat for the other side.

- 15b. Once released on both sides, lower the top rail and let it hang down.

WARNING: If the child is left alone in the crib, always make sure that the drop side is raised.

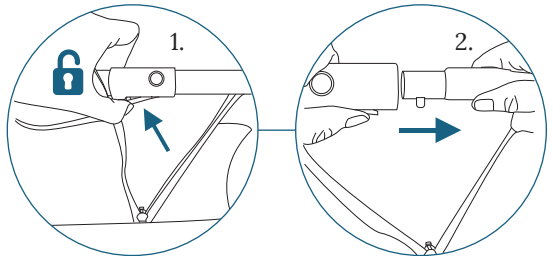
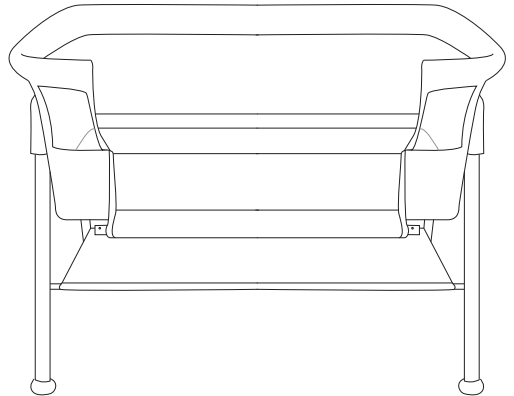

Co-Sleeper Mode (Fixed To Bed)

Attaching to Adult Bed in Co-Sleeper Mode (Fixed to Bed)

16. Use the bed attachment straps (J) provided to fix the crib to the adult bed.

Locate the male buckles on either side of the crib. Then take each of the straps in turn and slide the female buckles onto each crib male buckle. You will hear a "click" when the buckle is secured.



male buckle



female buckle

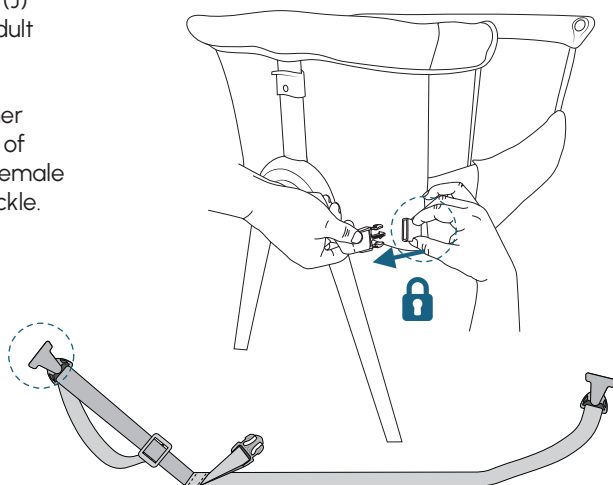

- 17a. Place the crib alongside the adult bed and check the height of the crib compared with the mattress of the adult bed.

WARNING: The height of the adult mattress should always be more than that of the side support for containment of the crib.

- 17b. For wooden bed frame with slats, feed the second female buckle and strap around the bed frame and then back out to the crib.

If a divan bed, feed the strap under the adult mattress, around and under the bed base and then back out to the crib.

Note. The max length of the attachment straps are 4.5m.

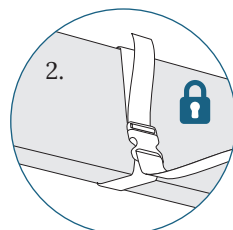
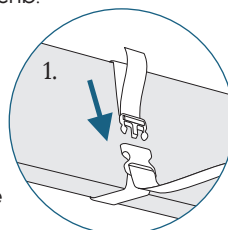

wooden bed frame with slats

- 17c. Insert the male buckle into the second female buckle until you hear a "click". Repeat with the other strap.

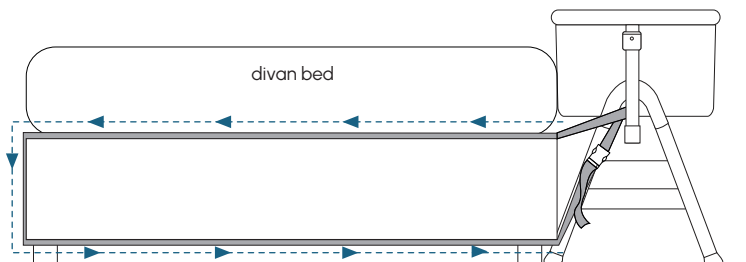

Co-Sleeper Mode (Fixed To Bed)

18. Tighten both straps by pulling the adjustment tabs. The straps must be rigid with no slack. The crib should be right up against the adult bed with no gaps.

NOTE: Check tightness of the bed attachment straps by pulling the crib away from the adult bed.

Re-check the height of the crib against the adult mattress and adjust if required.

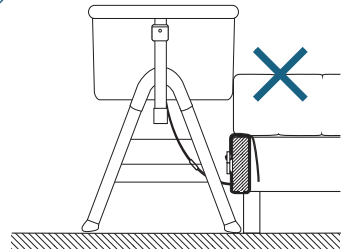
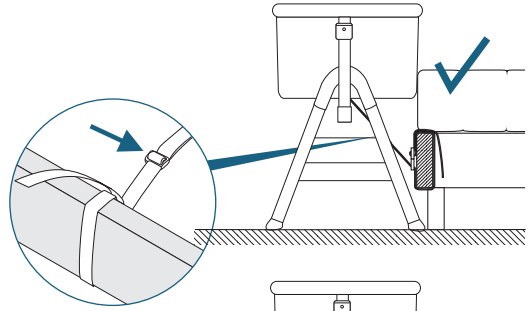

WARNING: Entrapment hazard - to prevent death from entrapment, the crib must be properly secured to the adult bed using the bed attachment straps.

WARNING: In co-sleeper mode the 2 legs of the crib should always be adjusted to the same height.

WARNING: The top of the bedside crib's mattress should be level with or slightly lower than the adult bed mattress.

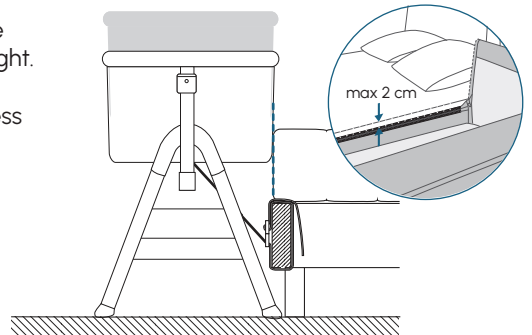

WARNING: Before every use always check to ensure that there is no space between the adult mattress and the side of the crib. If there is, pull the straps firmly to tighten until there's no space and the required condition of use has been restored.

WARNING: Ensure there are no gaps between the crib's mattress and the adult bed.

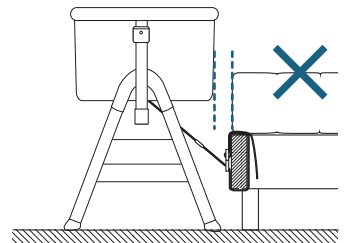
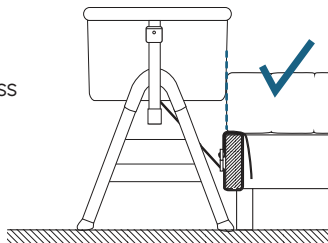

Co-Sleeper Mode (Fixed To Bed)

WARNING: During use, ensure that the adult bed sheets, blankets etc. do not enter and cover the interior of the crib.

WARNING: Both bed attachment straps **MUST** be attached to the crib when in co-sleeper mode. If one strap is broken or will not attach to the crib - **DO NOT** use the crib in co-sleeper mode until you have replaced the strap.

WARNING: Never fill gaps with anything - duvets or pillows are a suffocation hazard. If the crib cannot be attached to the adult bed without gaps, do not use it.

Cleaning

- Wipe main fabrics, plastics and metals with a damp cloth. A mild disinfectant may be used.
- Remove mattress and cover. Hand wash cover only in cool water using diluted detergent according to the instructions on the label.
- Never clean any part of crib with abrasive, ammonia based, bleach based or spirit type cleaners.
- Ensure the crib is fully dry before use or storage.
- Always ensure the crib is stored in a dry place away from direct sunlight.

Maintenance

- Regularly maintain your crib to keep it in good working order.
- Regularly check all parts of the product to ensure that they are operating correctly and for signs of wear or damage.
- Do not use this product if any part is broken, torn or missing and use only spares provided by the manufacturer.

Issue	Possible Root Cause	Solution
Not level with the adult bed.	Different leg heights	Check that the legs are all adjusted to the same position. Ensure the product is on a flat, even surface.
Not securely attached to the adult bed.	Attachment straps not assembled correctly.	Ensure they are properly secured and there are no gaps between the crib and the adult bed where the baby could get stuck.
Moving or shifting.	Loose straps.	Check and tighten both straps by pulling the adjustment tabs. The straps must be rigid with no slack.

For any and all other product issues not covered in the above please contact our dedicated customer services team at the below web address and they will endeavour to resolve any queries that you may have as soon as possible.

Contact: support@pugglebaby.co.uk

Recycling the Packaging

When you've unpacked your product and have ensured that all parts are present, please discard packaging components in accordance with your local authority guidelines, for further information please check the material and your postcode at

<https://www.recyclenow.com/recycle-an-item>. Your packaging will include the following materials;

Carton - 5Ply Corrugated Paper - Widely recycled in your card and paper bin

Polybag - PE Plastic - Recycle with bags at large supermarkets

Notes

Handwriting practice lines consisting of 15 sets of three horizontal dashed lines.

Notes
