

Denver Luxe 3-in-1 Travel System Infant Car Seat

Instruction manual

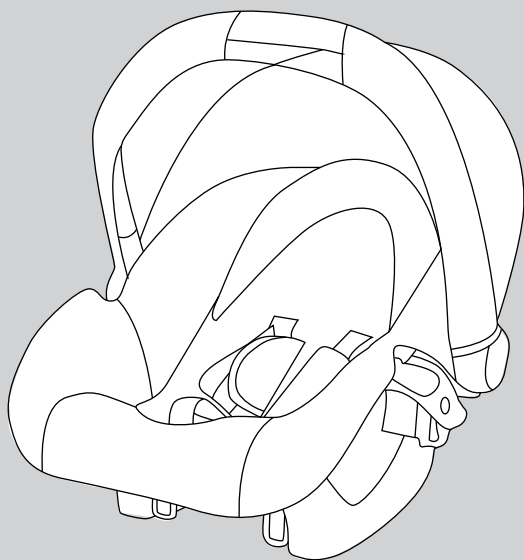

**IMPORTANT! READ CAREFULLY
AND KEEP FOR FUTURE REFERENCE.**

Warning: A child's safety is your responsibility.

This product is tested and approved to
ECE R44/04

1. Welcome

Thank you for purchasing the **Puggle Denver Luxe 3-in-1 Travel System**.

Please read the instructions and warnings carefully before use to ensure safe and satisfactory operation of your **Puggle Denver Luxe 3-in-1 Travel System**.

If you have a query with this product or require replacement parts, please contact Online4Baby online at online4baby.com/contact-us.

2. Safety instructions

The **Puggle Denver Luxe 3-in-1 Car Seat** is suitable for:

Age suitability	Assembling	Max. weight
0 -18months	Facing Rearward	0-13KGS

Notice

This is a "Universal" child restraint. It is approved to Regulation No. 44, 04 series of amendments, for general use in vehicles and it will fit most, but not all, car seats. A correct fit is likely if the vehicle manufacturer has declared in the vehicle handbook that the vehicle is capable of accepting a "Universal" child restraint for this age group.

Notice

This child restraint has been classified as "Universal" under more stringent conditions than those which applied to earlier designs which do not carry this notice. If in doubt, consult either the child restraint manufacturer or the retailer. Only suitable if the approved vehicles are fitted with 3-point safety belts, approved to UN/ECE Regulation No. 16 or other equivalent standards.

2. Safety instructions

IMPORTANT! PLEASE READ THE FOLLOWING INSTRUCTIONS CAREFULLY BEFORE INSTALLING THE PRODUCT.

- **WARNING:** Please read these instructions carefully, as incorrect installation may result in serious injury. If any injuries should occur as a result of incorrect installation, the manufacturer will accept no responsibility.
- **WARNING:** Instruction illustrations are for informational purposes only. The child restraint system may contain small differences compared to the photographs or diagrams in the instruction manual.
- **WARNING:** This child safety seat is suitable for use as Group 0+ from birth to 13kg (approx. 18 months)
- **WARNING:** You must never fit the car seat with a 2-point lap belt.
- **WARNING:** Only suitable for use in the listed vehicles fitted with 3 point with retractor safety belts, approved to ECE Regulation No. 16 or other equivalent standards.
- **WARNING:** The child must never be left unattended while seated in the safety seat.
- **WARNING:** Under no circumstances should the safety seat be installed in the front seat of the car if the car is equipped with an active airbag.
- **WARNING:** The seat cover should not be replaced with any other than the one recommended by the manufacturer, because the cover constitutes an integral part of the restraint performance.
- **WARNING:** Never use the child safety seat without both the cover and pads provided.
- **WARNING:** Do not disassemble or modify this child safety seat or harness, as this may seriously compromise the function and safety of this product.
- **WARNING:** Child seats or accessories that are damaged or have been used incorrectly must be replaced.
- **WARNING:** Do not use any load bearing contact points other than those described in the instructions and marked in the child restraint.
- **WARNING:** Do not leave heavy objects unsecured inside the car, as these may injure the child in the event of an accident.
- **WARNING:** Ensure that no part of the child seat is caught in the door of the vehicle or in a reclining seat. In addition, ensure that the safety seat is correctly installed and secured.
- **WARNING:** Protect the child safety seat from direct sunlight, as metal and plastic fittings could become hot and can be harmful to the child.
- **WARNING:** This safety seat is only intended for use in a vehicle.
- **WARNING:** You must replace the child restraint system if it is involved in an accident. It may have unseen damage and may not protect your child as well as it should.
- **WARNING:** You must replace the child restraint system and the safety belts if they become worn or damaged. It is not recommended to purchase or use second hand child restraint seats as there may be unseen damage and the product safety cannot be guaranteed. The manufacturer only guarantees this product with the original owner.
- **WARNING:** Any luggage or other objects liable to cause injuries in the event of a collision shall be properly secured.

2. Safety instructions

1. Only fit this child restraint in the vehicle with a shoulder/lap type belt, and install it on a passenger seat NOT equipped with airbag,
2. Always fit the child restraint with rear-facing (in opposition to the driving direction) on the front passenger seat or the rear passenger seat.

Remind: it is recommended that the vehicle's rear seat is the safest location for all babies. The front passenger seat is equipped with an airbag. The airbag may cause death and serious injury to the babies when it is open under emergency.

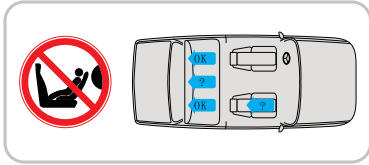

WARNING!

Under any condition, any restraint **MUST NOT** be fitted on the front passenger seat if the airbag is activated.

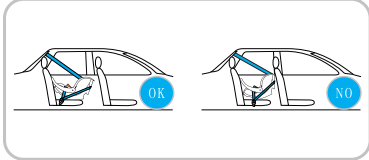

WARNING!

The insert cushion is only applicable for children weighing 0-6kgs. When your child weighs more than 6kgs, please remove the cushion.

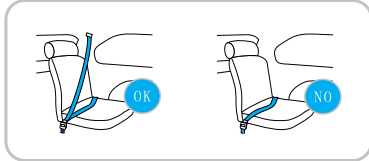

3. Parts List

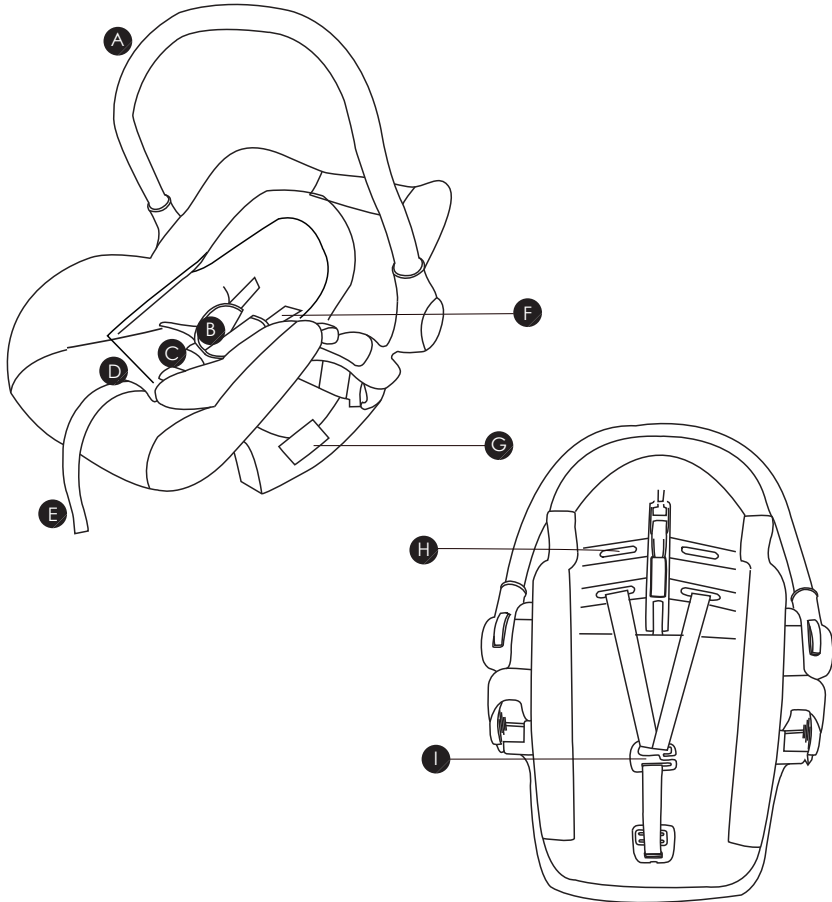

Carse

N^o Part

- A Handle
- B Shoulder pad protector
- C Buckle
- D Harness adjustor
- E Harness adjustor strap
- F Shoulder strap
- G Installation label
- H Shoulder strap adjustment slots
- I Harness connector

4. Installation

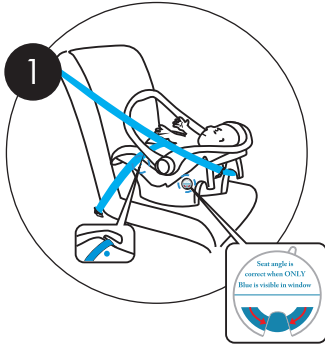

Ensure that the handle is in the correct position before car installation, as shown in picture 1. Position the infant car seat facing towards the backrest of the adult seat.

4.1 Slowly pull the seat lap belt out across the car seat and pass the lap belt through both blue lap belt guides. Fasten the seat belt.



4.2 Pull the diagonal belt around the back of the car seat and place it into the blue diagonal belt guide positioned on the back of the car seat. Holding the car seat firmly pull the diagonal belt to remove any slack.

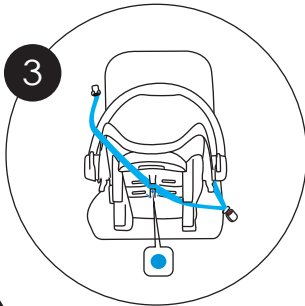

4.3 Adjust the child safety seat until the angle indicator turns blue. First, keep the lap belt of the vehicle seat tight. Make sure the diagonal belts of the vehicle seat is restrained firmly.



WARNING!

Never use in front passenger seats equipped with active airbag.



WARNING!

The car seat **MUST** be rear facing with the baby facing the rear of the vehicle.



WARNING!

FOR THE SAFETY OF YOUR CHILD, BEFORE EVERY JOURNEY IN THE CAR CHECK:

- the child seat is firmly installed in the vehicle.
- the belts are correctly adjusted and the straps are not twisted.
- the shoulder pads are at the same level as your child's shoulders.
- the buckle latches are engaged in the harness buckle.



WARNING!

The car seat must always be fitted using a 3 point lap and diagonal seat belt.

5. In Use

5.1 To elongate the shoulder straps, press the harness adjuster and pull the shoulder straps

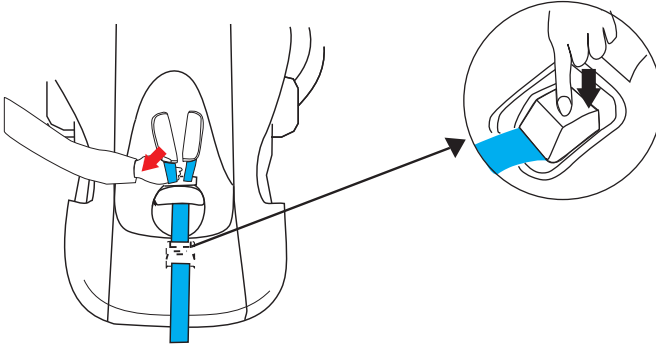

5.2 To release the child from the seat, press the red button on the child safety seat. Lay the shoulder belts to the side.

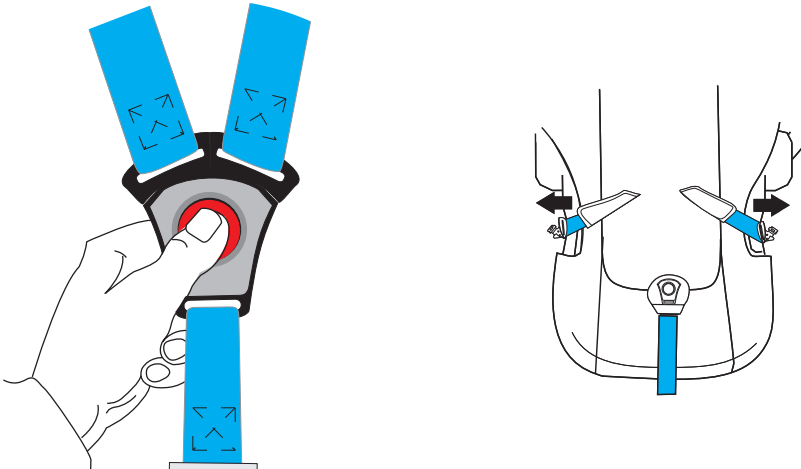

5. In Use

5.3 To ensure the child's safety, put the straps over the child's shoulders. Lock the buckle (as pictured below).

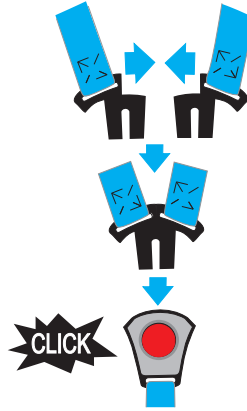
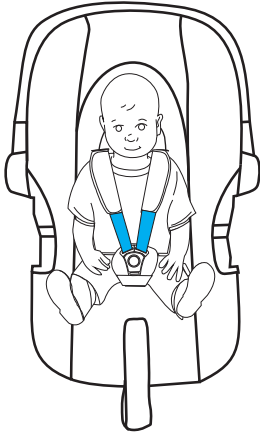

5.4 Pull the shoulder straps 1-2cm over the child's shoulders. Pull the central harness adjuster strap to keep a hand-sized space between the shoulder strap and the child's chest, as pictured below.

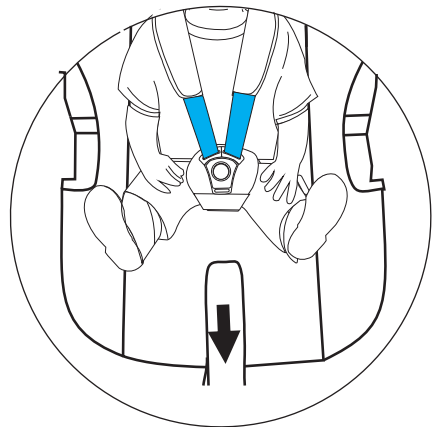
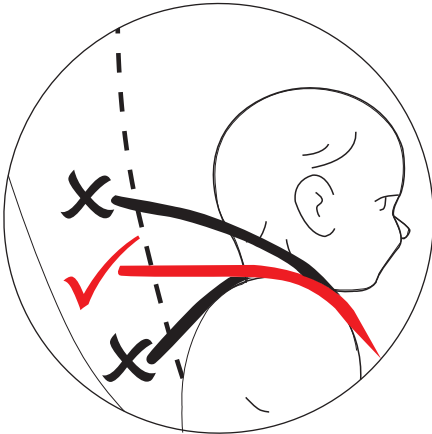

6. Adjusting the Car Seat

6.1 To adjust to the height of the child, you must adjust the shoulder straps using position 1 or 2 as pictured below.

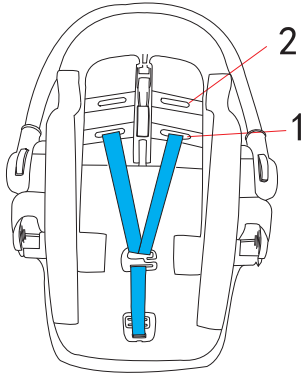

6.2 To adjust the height of the shoulder strap, take out the strap from the adjuster slot (H), and adjust to the suitable position. Reconnect straps with the harness connector (I).

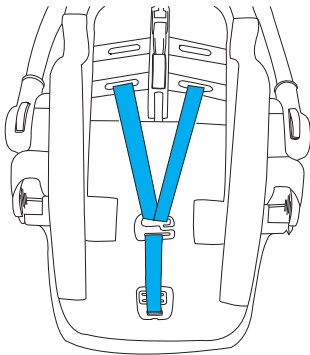

WARNING!

The insert cushion is only applicable for children weighing 0-6kgs. When your child weighs more than 6kgs, please remove the cushion.



WARNING!

Ensure straps are secured properly to the metal harness connector.



WARNING!

DO NOT place any extra pads or cushions into the car seat.



WARNING!

Ensure both of the shoulder straps are inserted at the same height and is not twisted.

6. Adjusting the Car Seat

6.3 To adjust the canopy/carrying handle position, press the left and right buttons at the same time, then rotate the handle (1) forwards or backwards until it automatically locks in one of the 3 desired positions:

- a. In-vehicle driving position and transport position.
- b. To put the child in the seat.
- c. For a secure location on a flat surface outside the vehicle.



WARNING!

To prevent the seat from tipping during transport, check whether the handle (1) is locked in the transport position "a".

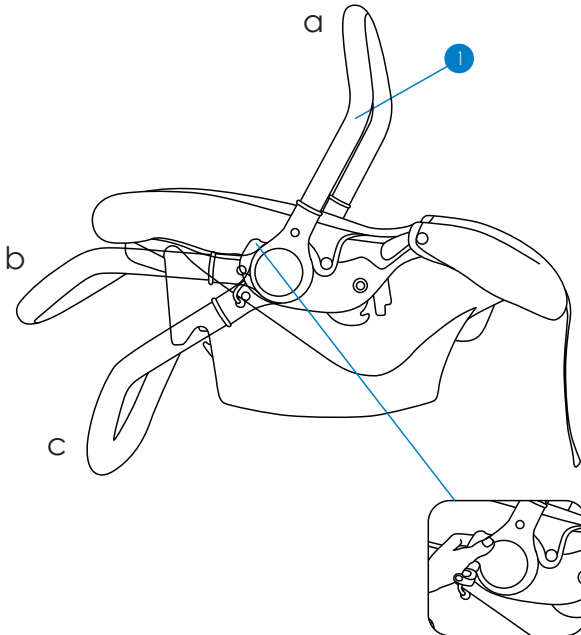

7. Removing the Fabric Seat Cover

7.1 To remove the shoulder pads from the seat, open the buckle and stretch out the straps. Remove the shoulder pads from the straps.

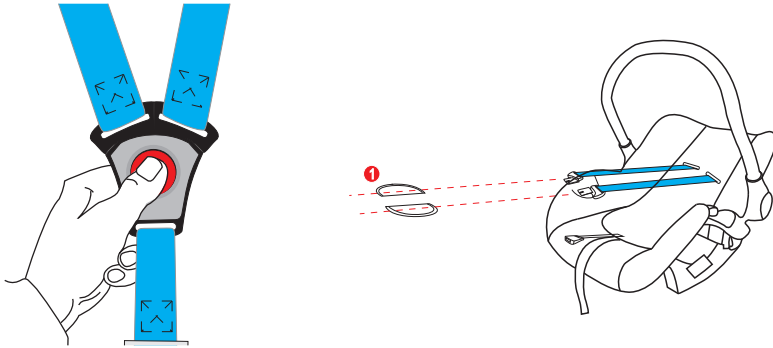

7.2 To remove the seat cover, take off the seat by releasing 6 buttons.

NOTE: Refitting is the reverse of removal

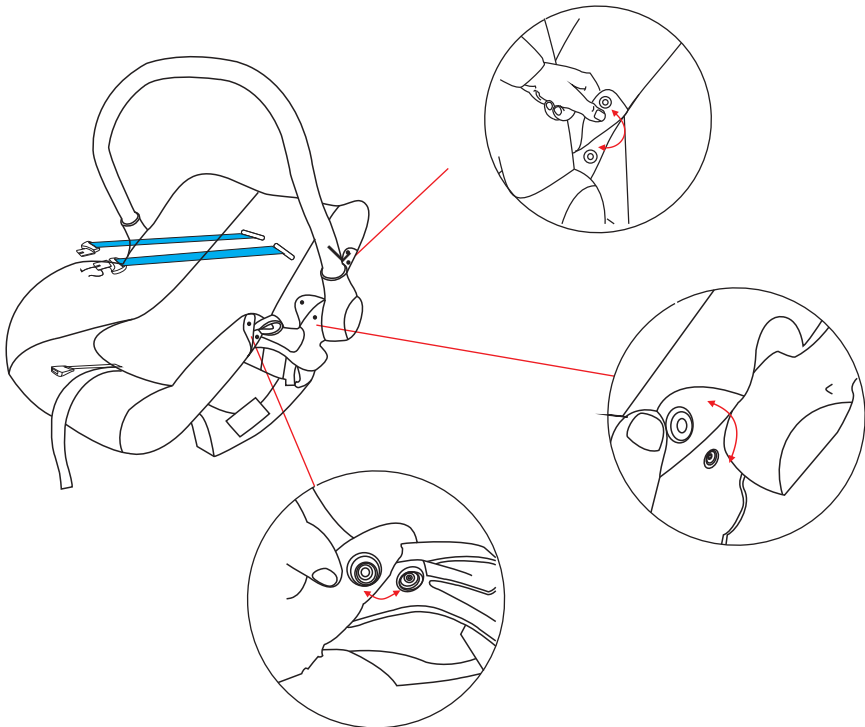

8. Care and Maintenance

8.1. CLEANING

- Spot or sponge clean fabrics with mild detergent. Use mild soap or upholstery shampoo. NEVER use bleach. Dry in shade thoroughly before reuse and avoid direct heat and sunlight. Do not iron. Do not dry clean.
- Wipe clean plastics and metals with a damp cloth.
- Never clean any part of the product with abrasive, ammonia based, bleach based or spirit type cleaners.
- Ensure the product is fully dry before use or storage.
- Always ensure the product is stored in a dry place to prevent mold or mildew developing.

8.2. MAINTENANCE

- The product requires regular maintenance to ensure correct and safe performance.
- Regularly inspect the locks, harness, remove catches, seat adjusters, joints and fixings to ensure they are clean, operating correctly and in full working order.
- Do not use this product if any part is broken, torn or missing and use only spares provided by the manufacturer.
- If parts become stiff or difficult to operate, ensure dirt is not the cause, then try a light application of a silicon lubricant, ensuring it penetrates between the components. Regular lubrication of moving parts will extend the life of your product and make opening and folding easier.
- After exposure to damp conditions, dry off with a soft cloth and leave fully open in a warm environment. Storing damp will encourage mildew to form.
- Store in a dry place.
- Do not leave in sunlight for prolonged periods as some fabrics may fade.
To remove the seat cover, take out the seat by releasing 6 buttons. See section 7.

8.3 CARE FOR THE HARNESS BUCKLE

It is vital for the safety of the child that the harness buckle works correctly. Malfunctions of the harness buckle are usually caused by accumulations of dirt or foreign bodies. Malfunctions are as follows:

- The buckle latches are ejected before the red release button is pressed.
- The buckle latches will no longer lock home (i.e. they are ejected again if you try lock them.)
- The buckle latches engage without an audible "click".
- The buckle latches are difficult to insert (you feel resistance).
- The buckle only opens if extreme force is applied.



If you have any questions or concerns regarding this product,
do not hesitate to contact our expert team online
via online4baby.com/contact-us

Feeling social?  
online4baby.com

Imported by Online4baby Ltd,
Meadowbank, Tweedale Way, Oldham, OL9 8EH