

# Safe Click Luxe 40-150cm i-Size 360 Rotate Eco Car Seat

Instruction manual

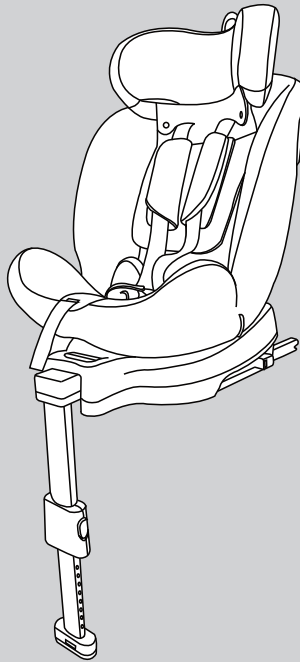

R129/03

**IMPORTANT - RETAIN FOR FUTURE  
REFERENCE, READ CAREFULLY.**

**Warning:** A child's safety is your responsibility.

This product is tested and approved to ECE R129/03



# 1. Contents

1. Contents .....	02
2. Welcome .....	02
3. Safety instructions .....	03-04
4. Installation positions .....	05
5. Parts List .....	06
6. Adjusting the car seat .....	07
6.1. Adjusting buckle .....	07
6.2. Adjusting harness .....	07
6.3. Adjusting headrest .....	08
6.4. Adjusting recline positions .....	08
6.5. Rotating seat .....	09
6.6. Adjusting ISOFIX .....	09
6.6.1. ISOFIX Installation .....	10
6.6.2. Remove ISOFIX .....	11
6.7. Installing the support leg .....	11
6.8. Remove and install harness .....	12
7. Installation .....	13
7.1. 40-105cm rearward facing (from birth to approx. 4 years ≤ 18kg) .....	13
7.2. 76-105cm forward facing (15 months to approx. 4 years ≤ 18kg) .....	14
7.3. 100-150cm forward facing (approx. 3 years to 12 years) .....	15
7.3.1. ISOFIX connectors and 3-point vehicle seat belt .....	15
7.3.2. 3-point vehicle seat belt .....	16
8. Care and maintenance .....	16
8.1. Buckle care .....	16
8.2. Cleaning the cover .....	17
8.3. Maintenance .....	17

# 2 .Welcome

Thank you for purchasing the Puggle Safe Click Luxe 40-150cm i-Size 360 Rotate Eco Car Seat.

Please read the instructions and warnings carefully before use to ensure safe and satisfactory operation of your Puggle Safe Click Luxe 40-150cm i-Size 360 Rotate Eco Car Seat.

If you have a query with this product or require replacement parts, please contact Online4Baby online at [online4baby.com/contact-us](http://online4baby.com/contact-us).

### 3. Safety instructions

For using as an i-Size category Enhanced Child Restraint System.

#### Notice

This is an i-Size Enhanced Child Restraint System. It is approved according to UN Regulation No. 129, for use in, i-Size compatible vehicle seating positions as indicated by vehicle manufacturers in the vehicle user's manual.

If in doubt, consult either the Enhanced Child Restraint System manufacturer or the retailer.

For using as an i-Size booster seat category Enhanced Child Restraint System.

#### Notice

This is an i-Size booster seat Enhanced Child Restraint System. It is approved according to UN Regulation No. 129, for use primarily in "i-Size seating positions" as indicated by vehicle manufacturers in the vehicle user's manual.

If in doubt, consult either the Enhanced Child Restraint System manufacturer or the retailer.

#### **IMPORTANT! READ CAREFULLY BEFORE USE AND KEEP FOR FUTURE REFERENCE.**

**Read this user manual BEFORE installing your car seat. Incorrect installation could endanger your child. Please always keep the instruction manual with the car seat for future reference.**

- **IMPORTANT:** DO NOT use forward facing before child's age exceeds 15 months.
- **WARNING:** DO NOT place rear-facing child seat on front seat with active airbag. DEATH OR SERIOUS INJURY can occur.
- **WARNING:** NO child restraint can guarantee full protection from injury in an accident. However, proper use of a child restraint will reduce the risk of serious injury or death to your child.
- **WARNING:** Assembly and installation operations must be carried out by adults.
- **WARNING:** To use this child restraint with the ISOFIX connections according to the ECE R129 Regulation, your child must meet the following requirements:  
Child height 40-150cm.
- **WARNING:** For the correct usage of the airbag in combination with the seat; read the vehicle handbook.
- **WARNING:** DO NOT allow child restraint straps to become twisted, keep them flat.
- **WARNING:** DO NOT install or use this car seat without following the instructions in this manual or you may put your child at serious risk of injury or death.
- **WARNING:** DO NOT make any modifications to this car seat or use it along with component parts from other manufacturers.

### 3. Safety instructions

- **WARNING:** When using this child restraint system, the belt must be used correctly; make sure that the lap belt is not above the child's belly.
- **WARNING:** DO NOT leave this car seat unsecured in your vehicle because an unsecured car seat can be thrown around and may injure occupants in a sharp turn, sudden stop, or collision. Remove it if not in regular use.
- **WARNING:** DO NOT use this child restraint without the seat cover.
- **WARNING:** The seat cover should not be replaced with any seat cover besides the ones recommended by the manufacturer. The seat cover constitute an integral part of the child restraint performance.
- **WARNING:** DO NOT put anything other than the recommended seat cover in this child restraint.
- **WARNING:** DO NOT allow the car restraint harness or belt guide to become trapped or caught in the vehicle seat or door.
- **WARNING:** NEVER leave your child unattended with a child restraint.
- **WARNING:** NEVER use a second-hand car seat or a car seat whose history you do not know because they may have structural damage that endangers your child's safety.
- **WARNING:** Please keep this child restraint away from sunlight, otherwise it may be too hot for the child's skin.
- **WARNING:** DO NOT place other items on top of the car seat if it is in the car boot to prevent damage.
- **WARNING:** DO NOT continue to use this car seat after it has suffered any violent crash. Replace immediately as there may be invisible structural damage from the crash.
- **WARNING:** Remove this car seat from the vehicle seat when it is not in use.
- **WARNING:** To avoid suffocation, remove plastic bag and packaging materials before using this product.
- **WARNING:** The plastic bag and packaging materials should then be kept away from babies and children.
- **WARNING:** Consult the retailer for issues concerning maintenance repair and part replacement.
- **WARNING:** Frequently check the ISOFIX attachments for dirt and clear them if necessary. Reliability can be affected by ingress of dirt, dust, food particles etc.
- **WARNING:** DO NOT install this car seat under the following conditions: vehicle seats facing sideways or rearward with respect to the running direction of the vehicle. Vehicle seats movable during installation.
- **WARNING:** This is an universal booster cushion. It is approved to Regulation ECE R129, compatible all type of vehicles. Please refer to the vehicle manufacturer's website or consult your dealer if there is anything unclear.
- **WARNING:** In case of emergency or accidents, it is most important to have your child taken care of with first aid and medical treatment immediately.

## 4. Installation Positions

In the vehicle rear seats. ✓

This child safety seat may only be installed in front seats in the following circumstances:

1. If the vehicle is not equipped with rear seats.
2. If all rear seats are already occupied by children exceeding 135cm in height.
3. If it is not possible to install all child restraint systems in the rear seats.

### Notice

- **If your center rear passenger seat is only fitted with a 2-point lap belt the child safety seat must not be used. It is only suitable with a 3-point safety belt.** ?1

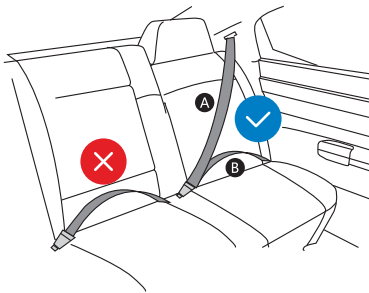

- ✓ 3-point belt
- ✗ 2-point belt
- A Diagonal belt
- B Lap belt

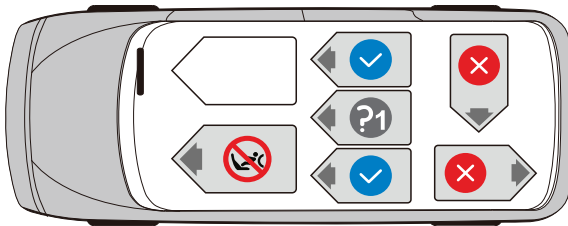

**⚠ WARNING!**  
Refer to the vehicle's instruction manual to install the seat in the front seat.



**40-105cm**  
**≤18kg**

Facing backwards  
(against the direction of travel)



**76-150cm**  
**older than 15 months**

Facing forwards  
(in the direction of travel)

# 5. Parts List

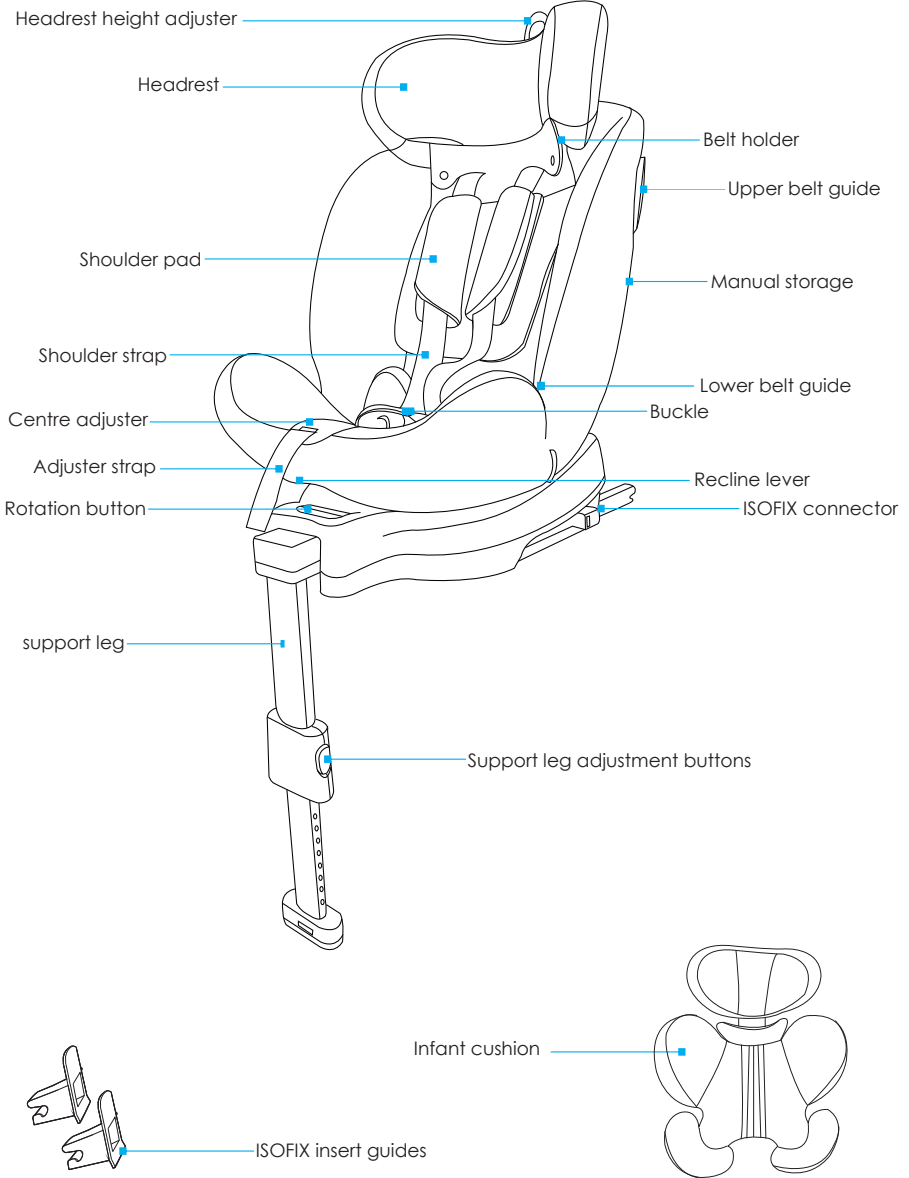

## 6. Assembling the Car Seat

### 6.1. ADJUSTING BUCKLE

#### Open buckle:

Press red button until buckle latches are released from the buckle (fig. 1)

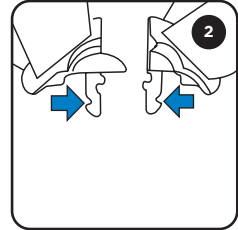
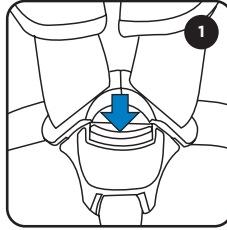

#### Lock buckle:

Guide the two buckle latches together (fig. 2), putting them into the harness buckle house (fig. 3). A “click” will signal when locked.

**Note.** The buckle will not lock with one latch only.

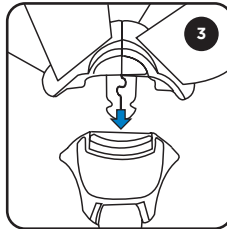

### 6.2. ADJUSTING HARNESS

#### Tighten harness:

Pull the adjuster strap until the harness lies flat and close against your child's body (fig. 5).

**Note.** The harness should allow 1 finger width, approx. 1cm at the top of the shoulders for ideal fit.

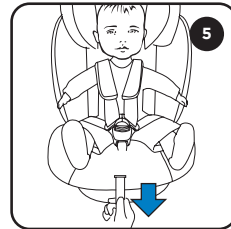

#### **WARNING!**

**Do not add additional items such as blankets or padded clothing.**

**Bulky items can lead to incorrect harness tightening.**

**In an accident the child can slip out of the restraint if not properly tightened.**

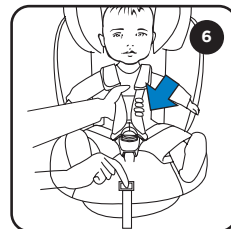

#### Loosen harness:

Press the centre adjuster and at the same time pull both shoulder belts forwards (fig. 6)

**DO NOT** pull on the shoulder pads.



## 6. Adjusting the Car Seat

### 6.3. ADJUSTING HEADREST

1. Loosen the harness to allow full movement of the headrest
2. Pull the headrest height adjuster, lifting the headrest up/down to the desired position (fig. 7).

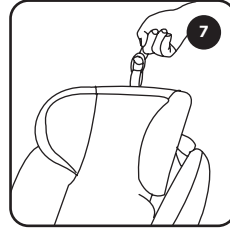

### IMPORTANT

**A correctly adjusted headrest ensures optimal protection for your child in the safety seat.**

When installed by 5-point harness, the headrest must be adjusted so that the shoulder belts are at the same level as your child's shoulders (fig. 8).

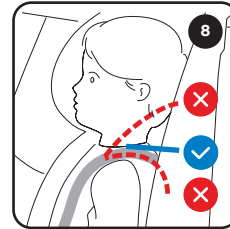

When installed by 3-point vehicle belt, the headrest must be adjusted so that there is a space two fingers wide between the headrest and your child's shoulders. Make sure the diagonal seat belt section is on your child's shoulder but not on the neck (fig. 9).

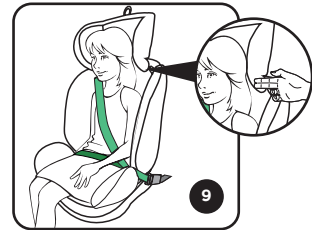

### 6.4. ADJUSTING RECLINE POSITIONS

Pull the recline lever and at the same time incline seat to desired position (fig. 10).

### CAUTION

**Adjust to most reclined position when installed rearward facing.**

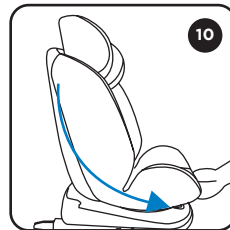

## 6. Adjusting the Car Seat

### 6.5. ROTATING SEAT

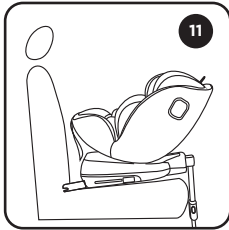

**40-105cm**

Birth - approx. 4 years  
≤18kg

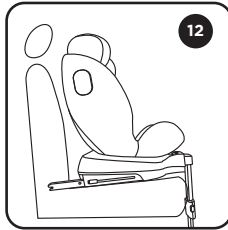

**76-150cm**

15 months - approx.  
12 years

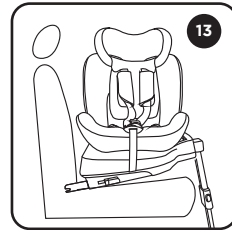

**Lateral facing**

For child sit convenience

1. Press down rotation button and rotate seat to intended direction (fig. 14, 15).

2. When seats rotates to desired direction, rotation handle will “click” into place. Gently try to rotate the seat to make sure the seat is locked into position (fig. 16).

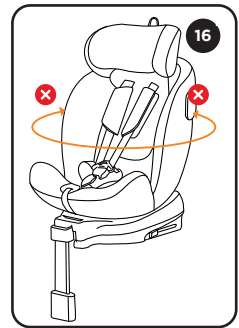
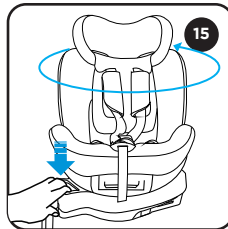
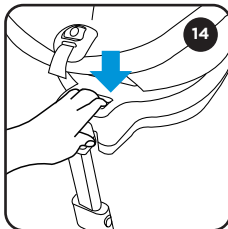

**WARNING!**

**Only for use when putting child in or out of the seat.**

### 6.6. ADJUSTING ISOFIX

If your vehicle is not equipped with the ISOFIX insert guides as standard, clip the two insert guides which are included with the seat, with the cut-out facing upwards onto the two ISOFIX attachment points of your vehicle.

**Tip:** The ISOFIX attachment points are located between the surface and the backrest of the vehicle seat.

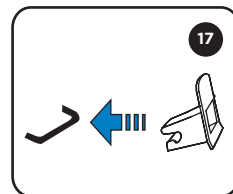

## 6. Adjusting the Car Seat

### 6.6.1. ISOFIX INSTALLATION

1. On each side of the seat, squeeze the ISOFIX button and fully extend the ISOFIX connectors (fig. 18,).

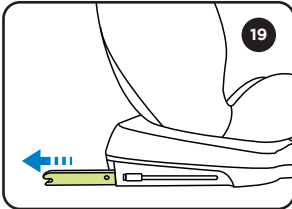
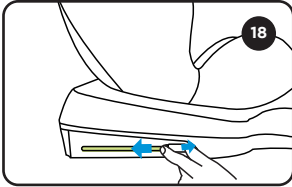

2. Slide the two ISOFIX connectors firmly into the insert guides until the ISOFIX connectors engage with a "click" noise on both sides. The ISOFIX button must turn green on both sides (fig. 19).

### CAUTION!

The ISOFIX connectors are only correctly engaged if both of the ISOFIX buttons are green (fig. 20).

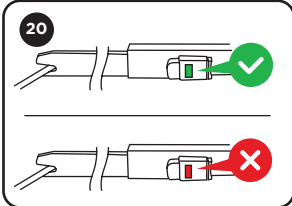

3. Push the child seat towards the backrest applying firm, even pressure on both sides. Make sure it is safely attached and recheck the green safety buttons to make sure that both are completely green (fig. 21).

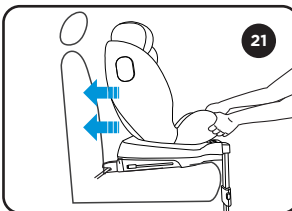

## 6. Adjusting the Car Seat

### 6.6.2. REMOVE ISOFIX

Squeeze the ISOFIX button and pull back the ISOFIX connectors (fig. 22).

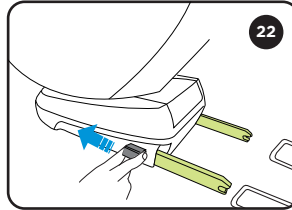

### 6.7. INSTALLING THE SUPPORT LEG

1. Pull the support leg away from the bottom of the seat until fully extended (fig. 23).

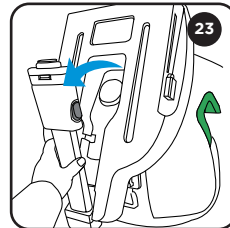

2. Push both adjustment buttons and pull out the support leg until it rests firmly on the floor of the vehicle (fig. 24, 25).

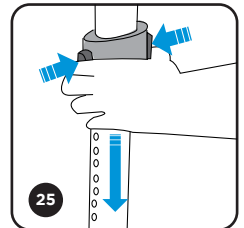
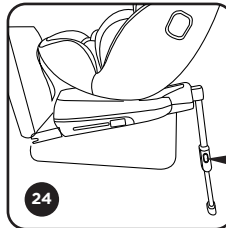

3. Make sure the indicator on the support leg turns green, the bottom of the seat does not lift up from the surface of the vehicle seat and two adjustment buttons are engaged (fig. 26).

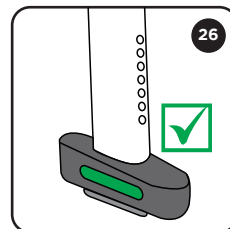

## 6. Adjusting the Car Seat

### 6.8. REMOVE AND INSTALL HARNESS

1. Loosen the 5-point harness on the child seat as far as possible. Then open the buckle (fig. 27).

2. Open the press studs on the backrest and fold the upper half of the cover up and the lower half down (fig. 28).

3. Open the two shoulder pads by the Velcro fasteners on the side. Push the Velcro strip of the two opened shoulder pads under the backrest cover and attach it to the fleece strip provided (fig. 29).

4. Insert the buckle tongues in the recess provided on the inside of the backrest (fig. 30).

5. Open the seat cover and fold the cover forwards. Pull the harness buckle out of the cover (fig. 31).

6. Stow the harness buckle in the recess provided (fig. 32).

7. Close the two press studs and recovery seat cover (fig. 33).

8. To re-fit the harness:  
Simply follow the steps in the opposite order. Make sure the belt is not twisted.

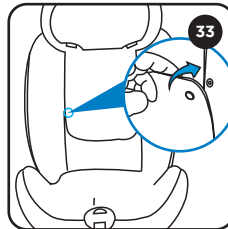
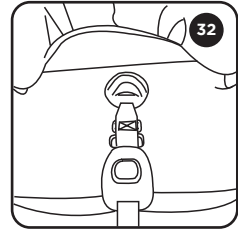
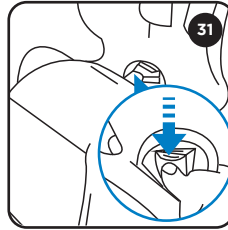
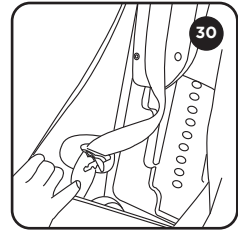
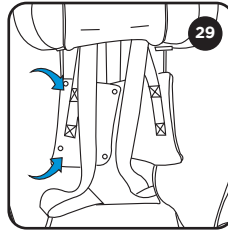
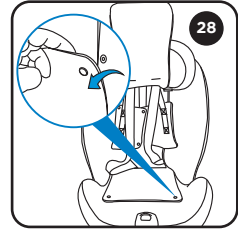
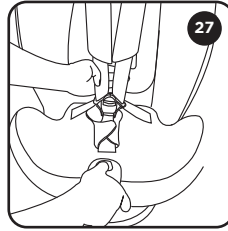

## 7. Installation

### 7.1. 40-105cm REARWARD FACING (From birth to approx. 4 years ≤ 18kg)

#### INSTALLATION USING ISOFIX CONNECTORS AND SUPPORT BAR

#### **WARNING!**

Never use in front passenger seats equipped with active airbag, DEATH OR SERIOUS INJURY can occur.

1. Rotate seat to a rearward facing position (see section 6.5). Adjust seat to most reclined position (see section 6.4).

2. Place seat in the direction facing opposite of travel (fig. 34, 35, 36).

**Note.** Use the infant cushion until the baby is 75cm in height.

3. Install ISOFIX connectors (see section 6.6) (fig. 37).

4. Position the support leg. Make sure the indicator on the support leg turns green (see section 6.7) (fig. 38).

5. Sit your child in the child seat. Adjust headrest (see section 6.3), adjust harness and lock buckle (see section 6.1), and tighten harness as required (see section 6.2) (fig. 39).

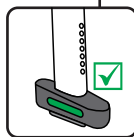
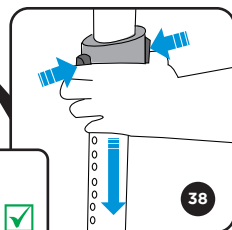
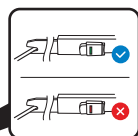
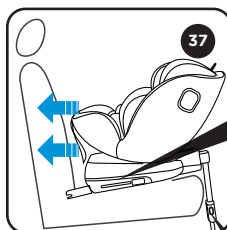
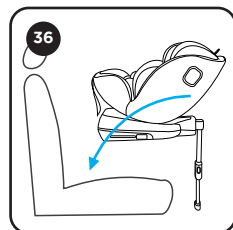
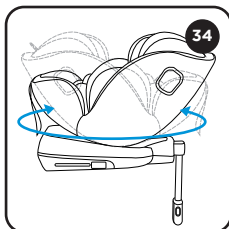

# 7. Installation

## 7.2. 76-105cm FORWARD FACING (15 months to approx. 4 years ≤ 18kg)

### INSTALLATION USING ISOFIX CONNECTORS AND SUPPORT BAR

#### **WARNING!**

**DO NOT use forward facing installation before the child's age reaches 15 months.**

1. Rotate seat to a forward facing position (see section 6.5). Place seat in the direction of travel (fig. 40, 41).

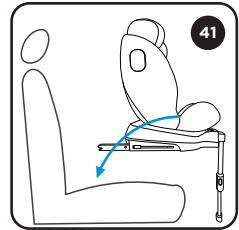
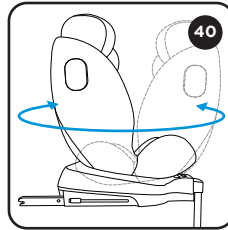

2. Install ISOFIX connectors (see section 6.6) (fig. 42).

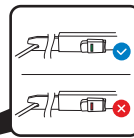
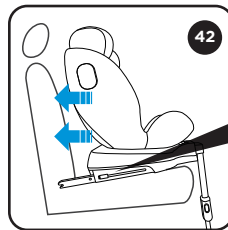

3. Position the support leg. Make sure the indicator on the support leg turns green (see section 6.7) (fig. 43).

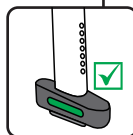
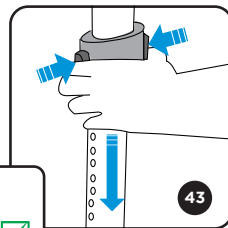

4. Sit your child in the child seat. Adjust headrest (see section 6.3), adjust harness and lock buckle (see section 6.1), and tighten harness as required (see section 6.2) (fig. 44).

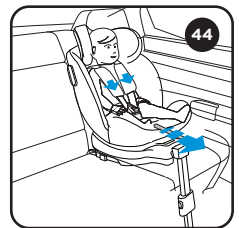

## 7. Installation

### 7.3. 100-150cm FORWARD FACING (approx. 3 years to 12 years)

1. Remove the harness when using for Group 2/3 (see section 6.8) and store the support leg in the base of the seat.

2. Rotate seat to forward facing (see section 6.5). Place seat in the direction of travel (fig. 45, 46).

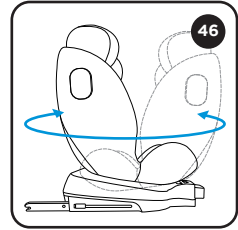
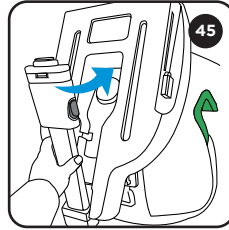

#### 7.3.1. INSTALLATION USING ISOFIX CONNECTORS AND 3-POINT VEHICLE BELT

1. Install ISOFIX connectors (see section 6.6) (fig. 47).

2. Sit your child in the child seat. Adjust headrest to required height (see section 6.3). Pull out the vehicle seat belt and guide it in front of your child to the vehicle seat buckle. Engage the buckle tongue into the vehicle seat buckle (fig. 48).

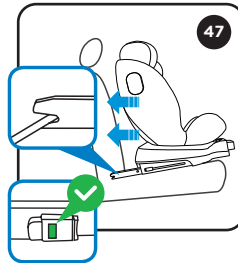

### CAUTION!

**The vehicle seat belt must not be positioned in the lower belt guide.**

3. Place the diagonal seat belt section and lap belt section on the side of the vehicle seat belt buckle in the lower belt guide (fig. 49).



4. Place the lap belt section on the other side of the child seat in the lower belt guide (fig. 50).

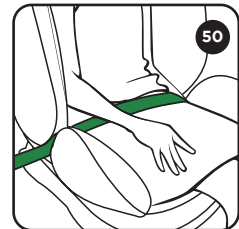

### CAUTION!

**The lap belt section must lie as low as possible over the child's hips on both sides.**

5. Guide the diagonal seat belt section into the belt and ensure it is not twisted (fig. 51).

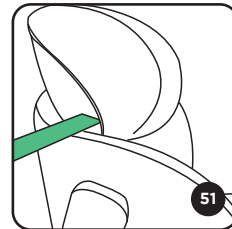



## 7. Installation

### 7.3. 100-150cm FORWARD FACING (approx. 3 years to 12 years)

#### 7.3.2. INSTALLATION USING 3-POINT VEHICLE BELT

1. If your car is not equipped with ISOFIX anchorage, this car seat can be installed with the vehicle belt only for 100-150cm forward facing installation (fig. 52).

2. See section 7.3.1. and ignore Step 1. Install ISOFIX connectors.



## 8. Care and Maintenance

### 8.1. CARE FOR THE HARNESS BUCKLE

It is vital for the safety of the child that the harness buckle works correctly. Malfunctions of the harness buckle are usually caused by accumulations of dirt or foreign bodies.

Malfunctions are as follows:

- The buckle latches are ejected before the red release button is pressed.
- The buckle latches will no longer lock home (i.e. they are ejected again if you try lock them in.)
- The buckle latches engage without an audible "click".
- The buckle latches are difficult to insert (you feel resistance).
- The buckle only opens if extreme force is applied.

#### **Solution:**

Clean out the harness buckle so that it functions properly once again.

1. Follow section 6.8 to remove the harness buckle.
2. Soak the harness buckle in warm water with washing-up liquid for at least an hour. Then rinse and dry it thoroughly (fig. 53).

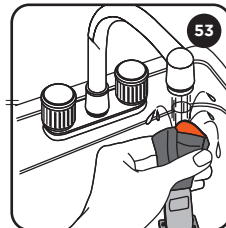

## 8. Care and Maintenance

### 8.2. CLEANING THE FABRIC COVER

The cover can be removed and cleaned according to the instructions provided on the care label.

1. First remove the harness (see section 6.8), then take off the fabric cover.

2. Undo the press studs at the back of the headrest and remove the cover (fig. 54).

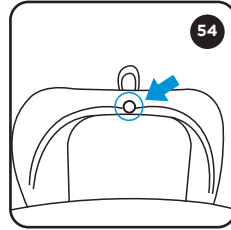

3. Undo the press studs and undo the zip at the back of the seat cover. Pull forward and remove the seat cover (fig. 55).

4. When re-fitting, simply follow the steps in reverse.

**Note.** when washing belts and plastic parts, use neutral detergent and warm water. Ensure that soap does not enter inside the buckle or metal pieces. Do not use chemical products or bleach on any part of the child seat. Clean the harness release mechanism by removing any dirt or debris build up with a soft bristled brush. Apply a lubricant to ensure that the spring and all mechanism functions.

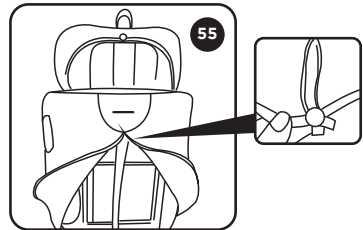

### 8.3. MAINTENANCE

It is important to only use the original upholstery as this is an essential part of the functionality.



Please remove the car seat from the vehicle seat if not in use.

Put the car seat in a cool, dry place where your child cannot access it.





If you have any questions or concerns regarding this product,  
do not hesitate to contact our expert team online  
via [online4baby.com/contact-us](https://online4baby.com/contact-us)

Feeling social?    
[online4baby.com](https://online4baby.com)

Imported by Online4baby Ltd,  
Meadowbank, Tweedale Way, Oldham, OL9 8EH, UK