

# Easy Fix Plus i-Size 100-150cm ISOFIX Eco Booster Seat

Instruction manual

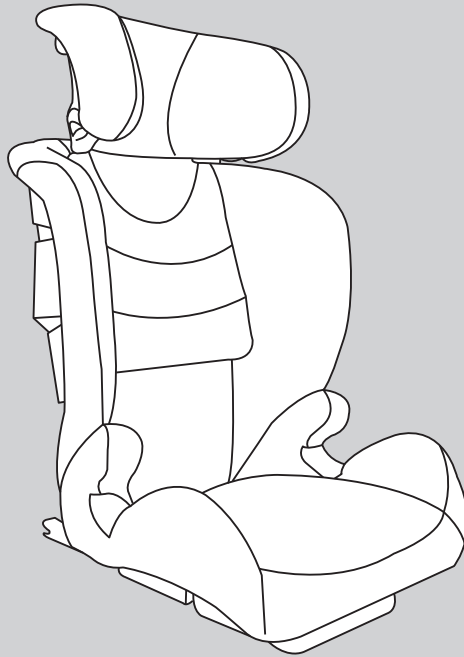

R129/03

**IMPORTANT - RETAIN FOR FUTURE  
REFERENCE, READ CAREFULLY.**

**Warning:** A child's safety is your responsibility.

This product is tested and approved to ECE R129/03



# 1. Contents

1. Contents .....	02
2. Welcome .....	02
3. Safety instructions .....	03-04
4. Installation positions .....	05
5. Parts List .....	06
6. Assembling the booster seat .....	07
7. Adjusting the booster seat .....	08
7.1. Adjusting headrest .....	08
7.2. Adjusting recline positions .....	08
7.3. Adjusting and installing ISOFIX .....	09
8. Installation .....	10
8.1. ISOFIX and 3-point vehicle seat belt .....	10-11
8.2. 3-point vehicle seat belt only .....	12
9. Care and maintenance .....	13

# 2 .Welcome

Thank you for purchasing the Puggle Easy Fix Plus i-Size 100-150cm ISOFIX Eco Booster Seat.

Please read the instructions and warnings carefully before use to ensure safe and satisfactory operation of of your Puggle Easy Fix Plus i-Size 100-150cm ISOFIX Eco Booster Seat.

If you have a query with this product or require replacement parts, please contact Online4Baby online at [online4baby.com/contact-us](http://online4baby.com/contact-us).

### 3. Safety instructions

#### Notice

This is a i-Size booster seat Enhanced Child Restraint System. It is approved according to UN Regulation No. 129, for use primarily in “i-Size seating positions” as indicated by vehicle manufacturers in the vehicle user’s manual. If in doubt, consult either the Enhanced Child Restraint System manufacturer or the retailer.

**IMPORTANT!** Do not use before the child’s age exceeds 15 months.

#### **IMPORTANT! READ CAREFULLY BEFORE USE AND KEEP FOR FUTURE REFERENCE.**

**Read this user manual BEFORE installing your seat. Incorrect installation could endanger your child. Please always keep the instruction manual with the booster for future reference.**

- **WARNING:** NO child restraint can guarantee full protection from injury in an accident. However, proper use of a child restraint will reduce the risk of serious injury or death to your child.
- **WARNING:** Assembly and installation operations must be carried out by adults.
- **WARNING:** To use this child restraint with the ISOFIX connections according to the ECE R129 Regulation, your child must meet the following requirements:  
Child height 100-150cm.
- **WARNING:** For the correct usage of the airbag in combination with the seat; read the vehicle handbook.
- **WARNING:** DO NOT allow child restraint straps to become twisted, keep them flat.
- **WARNING:** DO NOT install or use this booster without following the instructions in this manual or you may put your child at serious risk of injury or death.
- **WARNING:** DO NOT make any modifications to this booster or use it along with component parts from other manufacturers.
- **WARNING:** When using this child restraint system, the belt must be used correctly; make sure that the lap belt is not above the child’s belly.
- **WARNING:** DO NOT leave this booster unsecured in your vehicle because an unsecured booster can be thrown around and may injure occupants in a sharp turn, sudden stop, or collision. Remove it if not in regular use.
- **WARNING:** DO NOT use this child restraint without the seat cover.
- **WARNING:** The seat cover should not be replaced with any seat cover besides the
- **WARNING:** ones recommended by the manufacturer. The seat cover constitute an integral part of the child restraint performance.
- **WARNING:** DO NOT put anything other than the recommended seat cover in this child restraint.
- **WARNING:** DO NOT allow the car restraint harness or belt guide to become trapped or caught in the vehicle seat or door.
- **WARNING:** NEVER leave your child unattended with a child restraint.
- **WARNING:** NEVER use a second-hand booster or a booster whose history you do not know because they may have structural damage that endangers your child’s safety.

### 3. Safety instructions

- **WARNING:** Please keep this child restraint away from sunlight, otherwise it may be too hot for the child's skin.
- **WARNING:** DO NOT place other items on top of the booster if it is in the car boot to prevent damage.
- **WARNING:** DO NOT continue to use this booster after it has suffered any violent crash. Replace immediately as there may be invisible structural damage from the crash.
- **WARNING:** Remove this booster from the vehicle seat when it is not in use.
- **WARNING:** To avoid suffocation, remove plastic bag and packaging materials before using this product.
- **WARNING:** The plastic bag and packaging materials should then be kept away from babies and children.
- **WARNING:** Consult the retailer for issues concerning maintenance repair and part replacement.
- **WARNING:** Frequently check the ISOFIX attachments for dirt and clear them if necessary. Reliability can be affected by ingress of dirt, dust, food particles etc.
- **WARNING:** DO NOT install this booster under the following conditions: vehicle seats facing sideways or rearward with respect to the running direction of the vehicle. Vehicle seats movable during installation.
- **WARNING:** This is an universal booster cushion. It is approved to Regulation ECE R129, compatible all type of vehicles. Please refer to the vehicle manufacturer's website or consult your dealer if there is anything unclear.
- **WARNING:** In case of emergency or accidents, it is most important to have your child taken care of with first aid and medical treatment immediately.

## 4. Installation Positions

In the vehicle rear seats. 

This child safety seat may only be installed in front seats in the following circumstances:

1. If the vehicle is not equipped with rear seats.
2. If all rear seats are already occupied by children exceeding 135cm in height.
3. If it is not possible to install all child restraint systems in the rear seats.

### Notice

- **If your center rear passenger seat is only fitted with a 2-point lap belt the child safety seat must not be used. It is only suitable with a 3 point safety belt.** 

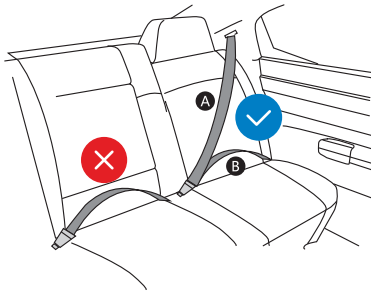

-  3-point belt
-  2-point belt
-  Diagonal belt
-  Lap belt

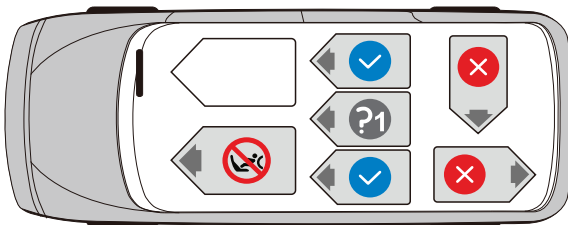

 **WARNING!**  
Refer to the vehicle's instruction manual to install the seat in the front seat.

# 5. Parts List

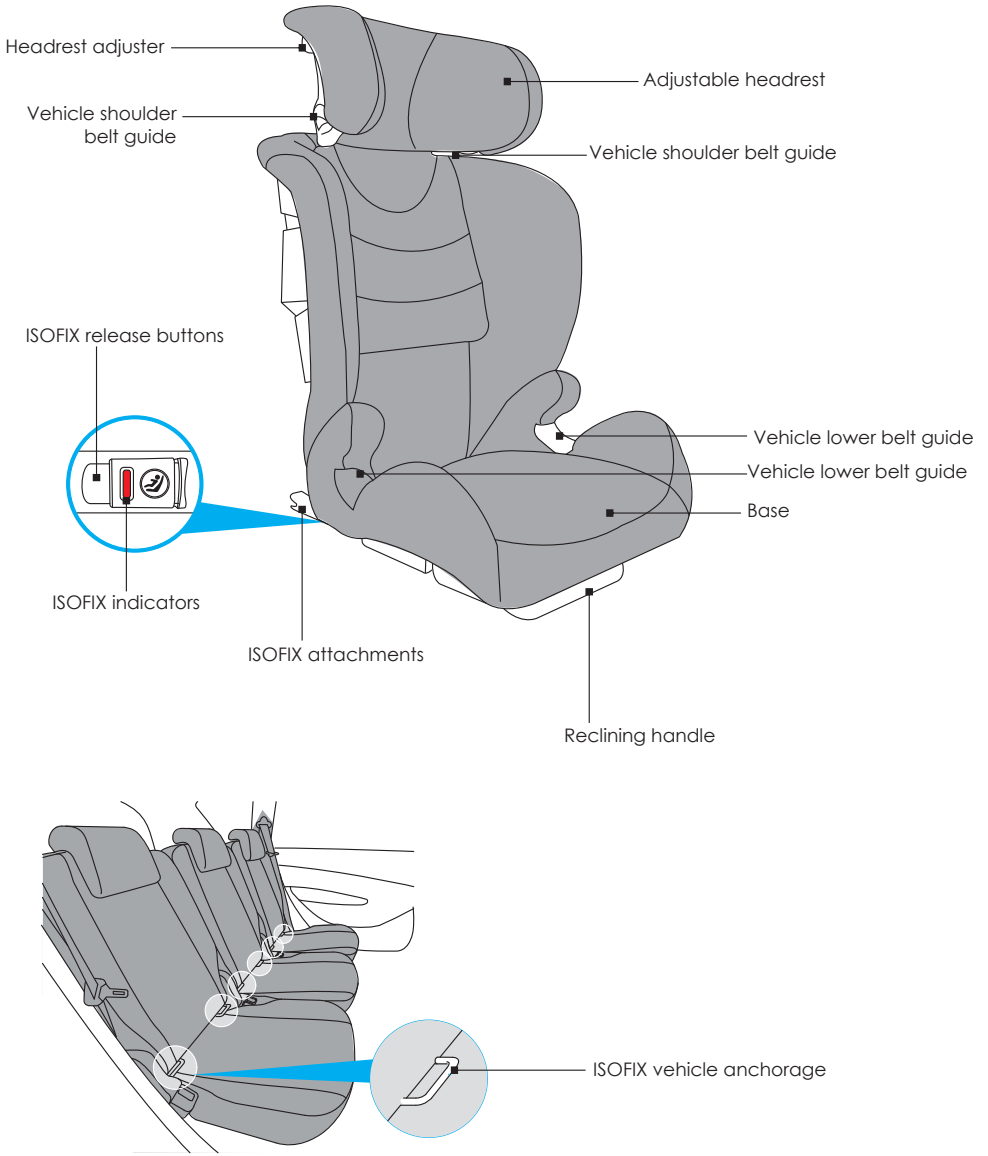

## 6. Assembling the Booster Seat

1. Hook the booster backrest onto the booster seat base (fig. 1).

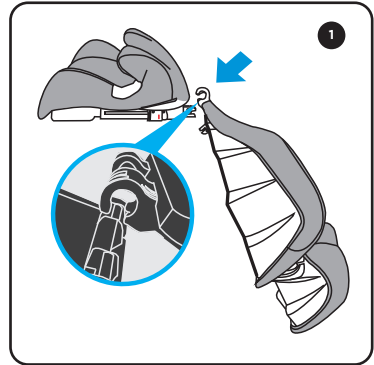

2. Rotate the booster backrest upwards (fig. 2).

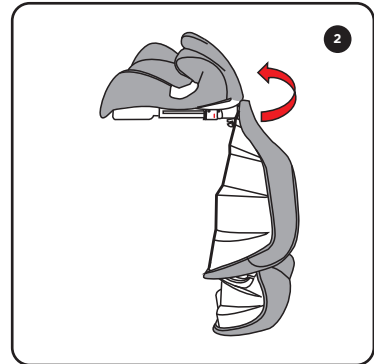

3. It will "click" once secure (fig. 3).

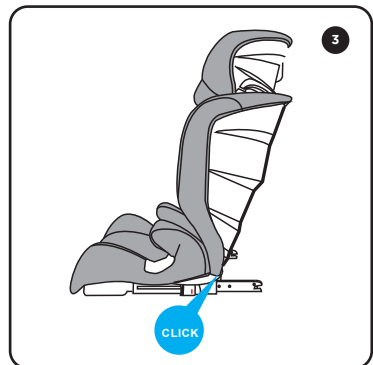



## 7. Adjusting the Booster Seat

### 7.1. ADJUSTING HEADREST

1. Adjust the headrest to the correct height by squeezing the height adjuster and lift the headrest to the desired position (fig. 4).

2. The headrest must be adjusted so that there is a space two fingers wide between the headrest and your child's shoulders (fig. 5).

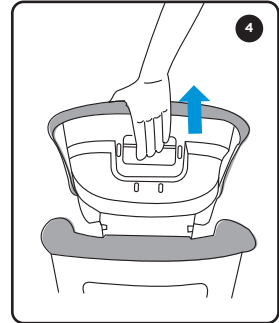

### IMPORTANT

A correctly adjusted headrest ensures optimal protection for your child in the safety seat.

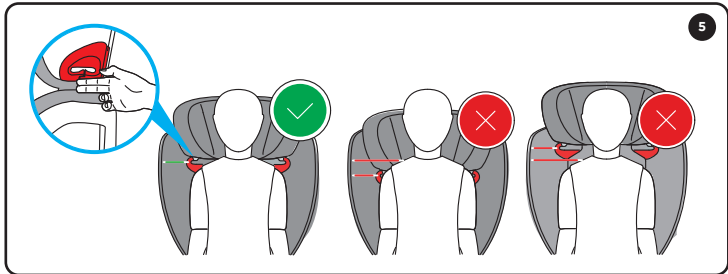

### 7.2. ADJUSTING RECLINE POSITIONS

The booster has 2 recline positions.

1. Pull on the recline handle located at the bottom booster seat (fig. 6).
2. Adjust the recline before installing the child with the vehicle belt.

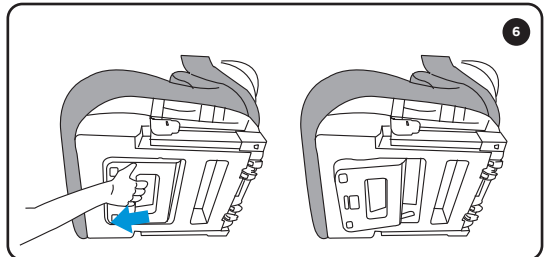

## 6. Adjusting the Booster Seat

### 7.3. ADJUSTING AND INSTALLING ISOFIX

1. On each side of the seat, squeeze the ISOFIX button and fully extend the ISOFIX connectors (fig. 7).

**Note.** The ISOFIX attachments will only lock into position when they are totally extended.

2. Click the ISOFIX attachments to the ISOFIX anchorage points in the vehicle seat (fig. 8).

3. Make sure that all ISOFIX indicators are green (fig. 9).

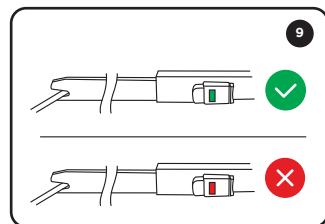
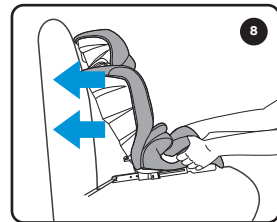
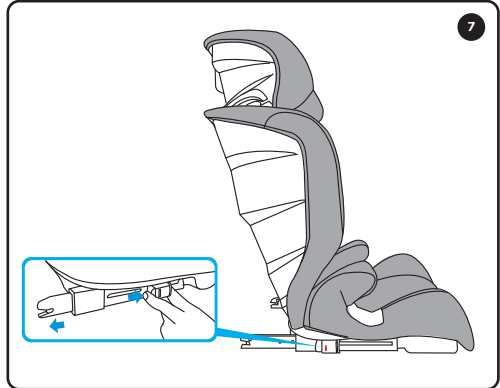

### CAUTION!

The ISOFIX connectors are only correctly engaged if both of the ISOFIX buttons are green (fig. 9).

4. Push the booster seat towards the backrest applying firm, even pressure on both sides. Make sure it is safely attached and recheck the green safety buttons to make sure that both are completely green.

## 8. Installation

### 8.1. ISOFIX AND 3-POINT VEHICLE SEAT BELT

1. Sit your child in the booster seat. Adjust headrest to required height (see section 6.1).

2. Squeeze and pull the ISOFIX release buttons to release the ISOFIX attachments (fig. 10).

**Note.** The ISOFIX attachments will only lock into position when they are totally extended.

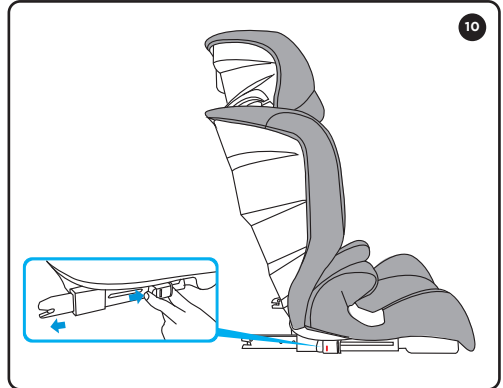

3. Click the ISOFIX attachments to the ISOFIX anchorage points in the vehicle seat (fig. 11).

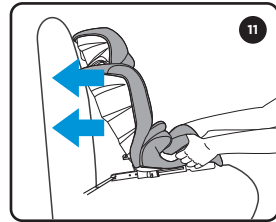

4. Make sure that all ISOFIX indicators are green (fig. 12).

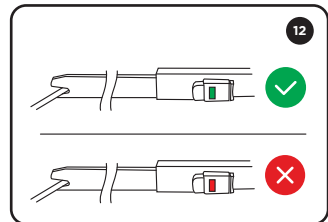

5. Push the booster seat as far back as possible towards the backrest of the vehicle seat.

6. Pull out the vehicle seat belt and guide it in front of your child to the vehicle seat buckle. Engage the buckle tongue into the vehicle seat buckle (fig. 13).

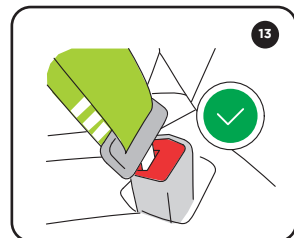

### CAUTION!

The lap belt section must lie as low as possible over the child's hips on both sides.

## 8. Installation

### 8.1. ISOFIX AND 3-POINT VEHICLE SEAT BELT

7. Place the diagonal seat belt section and lap belt section on the side of the vehicle seat belt buckle in the lower belt guide (fig. 14).

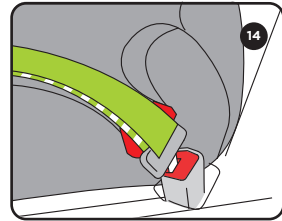

8. Place the lap belt section on the other side of the child seat in the lower belt guide (fig. 15).

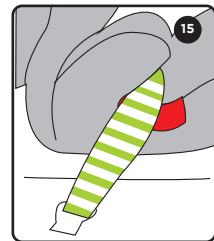

9. Guide the diagonal seat belt section into the shoulder belt guide and ensure it is not twisted (fig. 16).

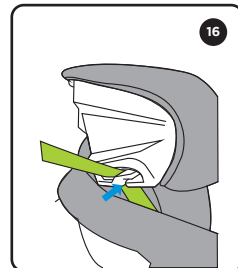

### **CAUTION!**

**Make sure belt is not twisted and buckle is engaged (fig. 17).**

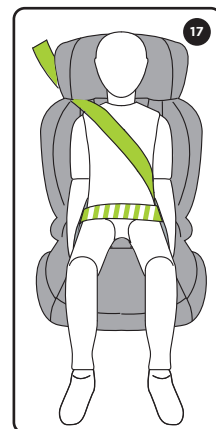

## 8. Installation

### 8.2. 3-POINT VEHICLE SEAT BELT ONLY

1. If the vehicle does not have ISOFIX installation, the ISOFIX attachments can be stowed inside the booster and the booster can be installed with the 3-point vehicle seat belt only.

2. Sit your child in the booster seat. Adjust headrest to required height (see section 6.1).

3. Pull out the vehicle seat belt and guide it in front of your child to the vehicle seat buckle. Engage the buckle tongue into the vehicle seat buckle (fig. 18).

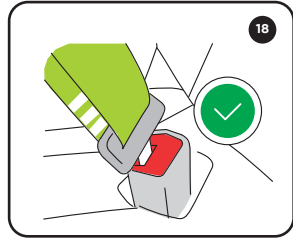

**CAUTION!**  
The lap belt section must lie as low as possible over the child's hips on both sides.

4. Place the diagonal seat belt section and lap belt section on the side of the vehicle seat belt buckle in the lower belt guide (fig. 19).

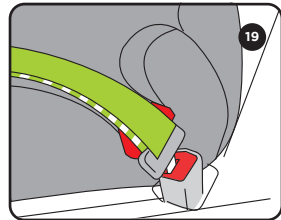

5. Place the lap belt section on the other side of the child seat in the lower belt guide (fig. 20).

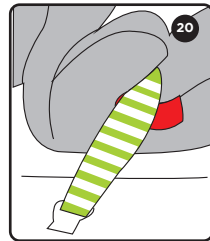

7. Guide the diagonal seat belt section into the shoulder belt guide and ensure it is not twisted (fig. 21).

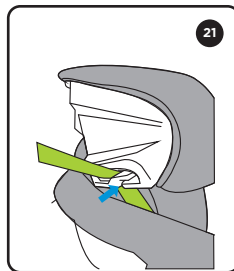

**CAUTION!**  
Make sure belt is not twisted and buckle is engaged (fig. 22).

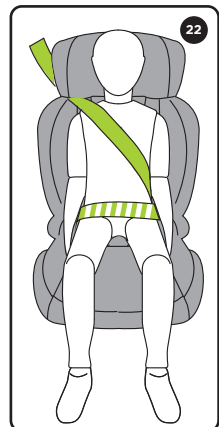

## 9. Care and Maintenance

### 9.1. MAINTENANCE

It is important to only use the original upholstery as this is an essential part of the functionality.

Please remove the booster seat from the vehicle seat if not in use.

Put the booster seat in a cool, dry place where your child cannot access it.

### 9.2. CLEANING

DO NOT wash fabrics. Spot clean only using a soft sponge with diluted detergent or water. Dry in shade and not in the sun. Do not iron. Do not dry clean. Wipe metals and plastic parts with a mild detergent and lukewarm water. DO NOT use chemical cleaners or bleaches (ammonia, petrol, solvents etc.) under any circumstances.





If you have any questions or concerns regarding this product,  
do not hesitate to contact our expert team online  
via [online4baby.com/contact-us](https://online4baby.com/contact-us)

Feeling social?    
[online4baby.com](https://online4baby.com)

Imported by Online4baby Ltd,  
Meadowbank, Tweedale Way, Oldham, OL9 8EH, UK