

PUGGLE

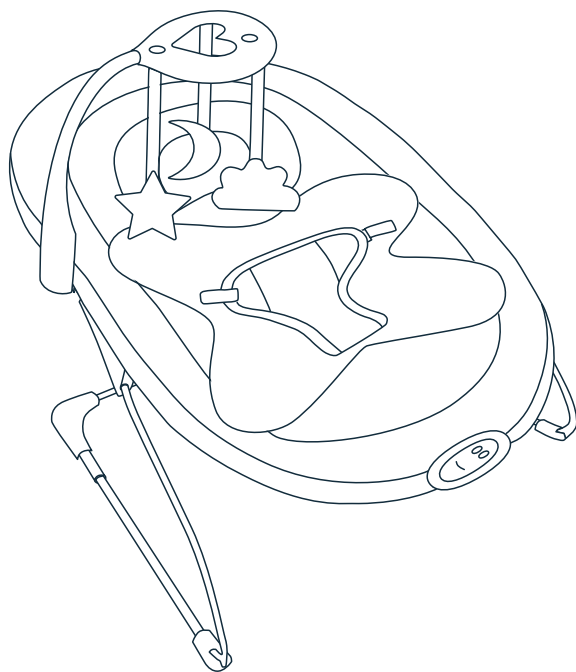

Comfy Snug Plush Music & Vibration Bouncer

Instruction Manual

IMPORTANT! READ CAREFULLY AND KEEP FOR FUTURE REFERENCE.

Welcome

Thank you for purchasing the **Puggle Comfy Snug Plush Music & Vibration Bouncer**.

Please read the instructions and warnings carefully before use to ensure safe and satisfactory operation of your **Puggle Comfy Snug Plush Music & Vibration Bouncer**.

We're here to help!

If you have a query with this product or require replacement parts, please contact us at:
support@pugglebaby.co.uk

Important Information

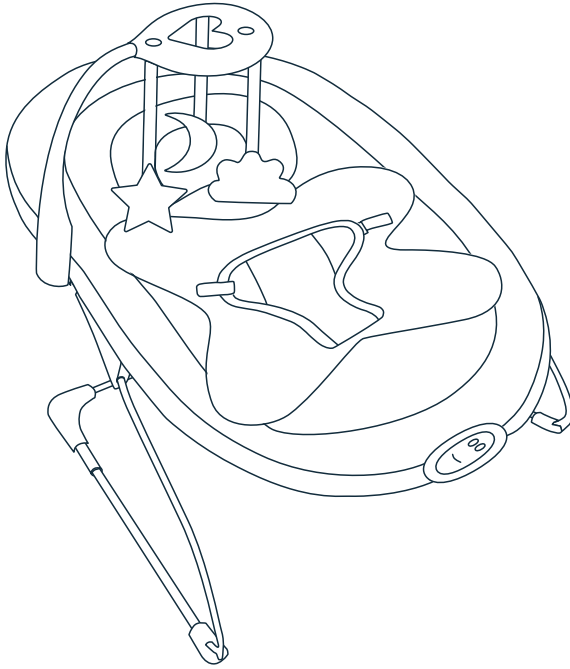

IMPORTANT! Your Comfy Snug Plush Music & Vibration Bouncer may differ slightly from images shown above and throughout, as the images are for illustration purposes only.

Your Comfy Snug Plush Music & Vibration Bouncer is tested to comply with EN 12790-1:2023

DO NOT use parts or accessories which are not approved or supplied by the manufacturer.

Warning

IMPORTANT! PLEASE READ THE FOLLOWING INSTRUCTIONS CAREFULLY BEFORE USING THE PRODUCT.

- **WARNING!** Read these instructions carefully before assembly and use and keep for future reference. The child may be hurt if you do not follow these instructions.
- **WARNING!** This product is suitable for one child from birth (up to max. weight 9kg).
- Do not use the bouncer once the child starts trying to sit up.
- **WARNING!** Follow the manufacturer's instructions.
- **WARNING!** Prevent serious injury or death.
- **WARNING! Never leave the child unattended.**



- **WARNING!** ALWAYS use the restraint system ensuring it is correctly adjusted at all times.
- **WARNING! This reclined cradle is not intended for prolonged periods of sleeping.**
- **WARNING!** NEVER use for a child that is able to sit up unassisted.
- **WARNING!** Do not attempt to move or lift the product when a child is in it.
- **WARNING! FALL HAZARD:** Child's activity may move product. Use only on the floor. Never use on an elevated surface.
- **WARNING! SUFFOCATION HAZARD:** Never use on a soft surface (bed, sofa, cushion), as seat may tip over and cause suffocation.
- **WARNING!** Never use this product on an elevated surface (e.g. a table).
- **WARNING!** The toy bar is not a handle. Never use the toy bar to lift or carry the product.
- Never leave baby in the bouncer without supervision.
- Do not use the bouncer once the child can sit up unaided.
- Baby's movements could make the bouncer tip over.
- Do not use the bouncer if any part is broken or missing.
- Always use the restraint system, ensuring it is correctly adjusted at all times.
- Before using, check that all parts are properly locked into position and adjusted correctly.
- Check the suspension system of the bouncer regularly.
- Only use a 3-point safety harness.
- Do not use the bouncer without its seat liner.
- **WARNING!** Do not use this product on an elevated surface i.e. a table. Place on stable, dry, level floor only.
- Never place the bouncer on a soft surface (bed, sofa, cushion), as seat may tip over and be dangerous for baby.
- This reclined cradle does not replace a cot or cot bed. Should your child need to sleep, then it should be placed in a suitable cot or cot bed.

Warning

- The bouncer is not a carrycot, nor a car seat. Always use the straps and adjust them properly, even if baby will only be in the bouncer for a short time.
- Do not use near an open fire or any other kind of heater.
- Keep the plastic bags of the packaging out of reach of babies and young children to avoid any risk of suffocation.
- Never add any pillow, blanket or padding to the bouncer.
- Do not put objects with strings around the neck of your baby, do not hang strings from the bouncer and do not attach strings to toys. This could lead to strangling.
- Do not put the bouncer close to a window where the strings of a blind or curtains could lead to strangling.
- Do not allow your baby to play with the bouncer folded up.
- Do not attach other toys than those supplied.
- **WARNING!** NEVER place a child under 2.26kg (5 lbs) or over 9kg (20 lbs) in the product.
- Discontinue use of product should it malfunction or become damaged.
- Do not use this product if any components are broken or missing.
- **WARNING!** Stop using the product when the child starts trying to sit up.
- Only use authorised additional replacement parts. Do not use accessories or replacement parts other than those approved by the manufacturer.
- Keep children away from the product during assembly and when not in use.
- Do not let other children play unattended near the product.
- Adult assembly required.

Battery Safety Instructions

Use a small cross head screwdriver to open the battery compartment door on the vibration/music box (E). Insert the battery as indicated inside the battery door and replace the screw. The vibration/music box requires 2 "AA" Alkaline batteries.

ATTENTION! BATTERY SAFETY: KEEP FOR FUTURE REFERENCE.

WARNING! Dispose of used batteries immediately. Keep new and used batteries away from children. If you think batteries might have been swallowed or placed inside any part of the body, seek immediate medical attention.

CAUTION: To prevent possible battery leakage, be sure to follow the guidelines outlined below:

- Insert batteries in the correct polarity position (+ and -).
- Do not short circuit battery terminals.
- Remove batteries during long periods of non-use. Always remove exhausted batteries from product. Dispose batteries properly.
- Use caution when opening battery compartment as some batteries may leak, explode or catch on fire.
- Do not submerge in water or other liquids.
- Do not dispose of this product in a fire. The batteries inside may explode or leak.
- Only batteries of the same or equivalent type as recommended are to be used.
- Do not charge non-rechargeable batteries.
- Different types of batteries or new and used batteries are not to be mixed.

The vibration/music box requires 2 "AA" Alkaline batteries (not included).



The symbol on the product or its packaging indicates that this product must not be disposed of with your other household waste. Instead, it is your responsibility to dispose of your waste equipment by taking it to a designated collection point for the recycling of waste electrical and electronic equipment.

The separate collection and recycling of your waste equipment at the time of disposal will help conserve natural resources and ensure that it is recycled in a

manner that protects human health and the environment. Please contact your local authority for more information about where you can drop off your waste for recycling.

Symbols & Their Meaning

There are a number of symbols used through this manual, please find below breakdown of what each symbol is and what it means.

 Direction indicator showing direction of assembly, rotation, function.

 Indicates if product is locked or unlocked

 Indicates if step is incorrect or correct

Before Assembly

Before assembly, please ensure that you have read and understood the instructions. Then carefully unpack your highchair and ensure that all parts are present. Please see parts list as follows.

Parts List

What's in the box:
x1 Puggle Comfy Snug Plush Music & Vibration Bouncer
x1 Instruction Manual

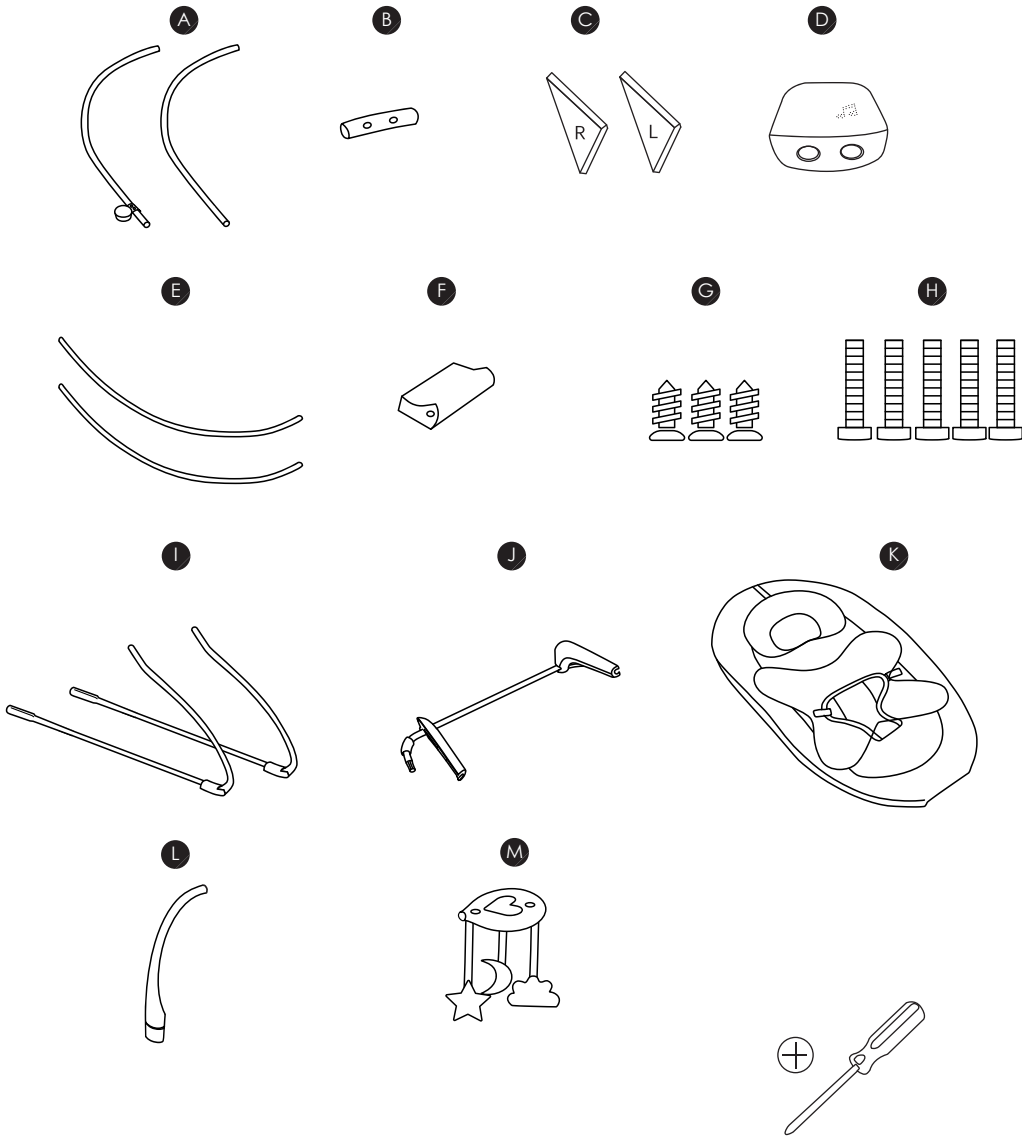

Parts List

Parts included with your Comfy Snug Plush Music & Vibration Bouncer.

| Part | Description | Quantity |
|------|--------------------------|----------|
| A | Seat back frame | 2 |
| B | Seat back connector | 1 |
| C | Plastic connector | 2 |
| D | Vibration box | 1 |
| E | Footrest frame | 2 |
| F | Footrest frame connector | 1 |
| G | Countersunk screw | 3 |
| H | Machine screw | 5 |
| I | Support frame | 2 |
| J | Rear connector tube | 1 |
| K | Seat pad | 1 |
| L | Toy bar | 1 |
| M | Toy bar (with 3x toys) | 1 |

Assembling The Bouncer

Check that all parts are present before starting assembly.

On a flat surface, place the left (I) and right (I) support frames opposite each other, with the rear connector tube (J) between them.

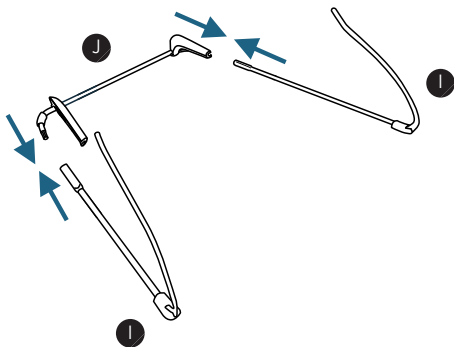

Lift the flip clip on both sides of the rear connector tube and lift the left support frame and right support frame into the rear frame tube. Close the flip clip over the tube and press down until the flip clips lock in place.

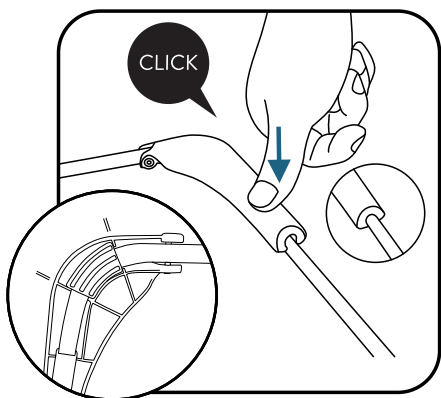
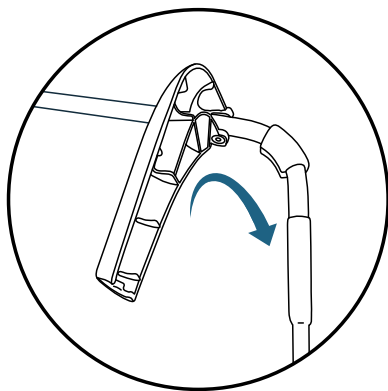

Assembling The Bouncer

Fit left plastic connector (C) to the left support frame with the holes facing inwards and secure with screw (G). Repeat process to fit the right plastic connector (C) to the right support frame.

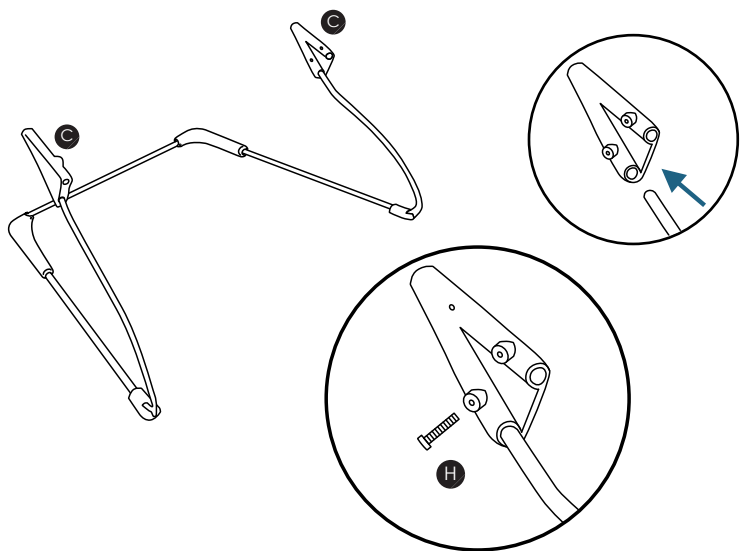

Fit both ends of the seat back frame (A) into the allocated holes in the seat back connector (B). Once connected fit both ends of the seat back frame (A) into the plastic connectors (C). Push the frame until the pin locks into the allocated holes.

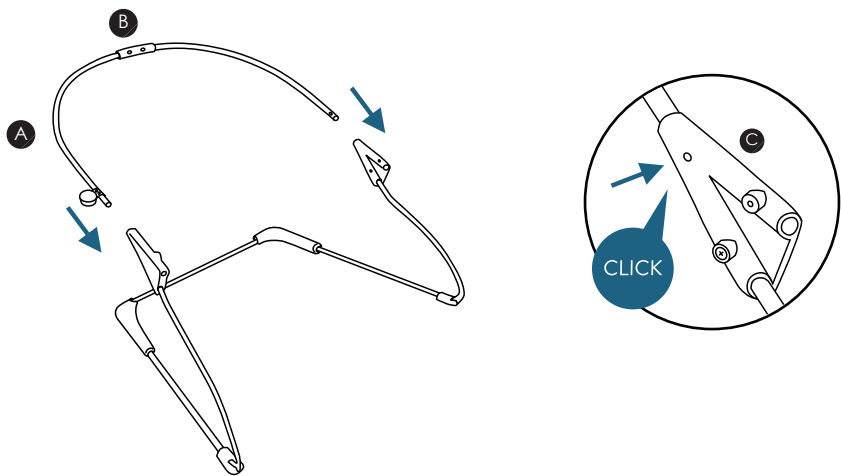

Assembling The Bouncer

Fit both ends of the footrest frame (E) into the footrest frame connector (F).
Once connected fit both ends of footrest frame (E) into the footrest frame connector (F) and secure with two countersunk screws (G).

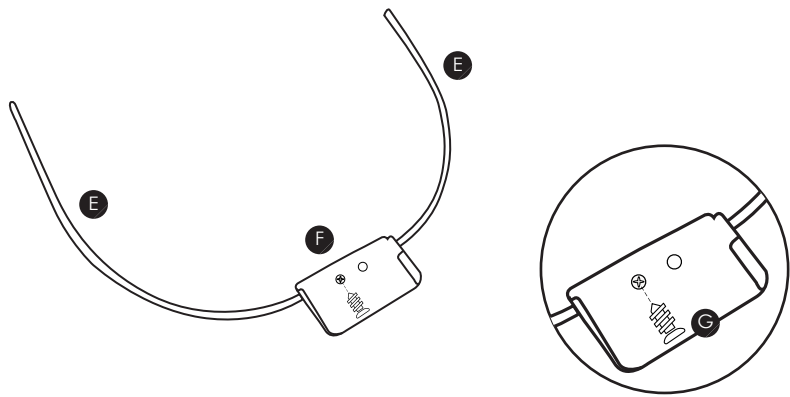

Fit both ends of the footrest frame (E) into the footrest frame connector (F). Once connected fit both ends of footrest frame (E) into the plastic connectors (C) and secure with machine screws (H).

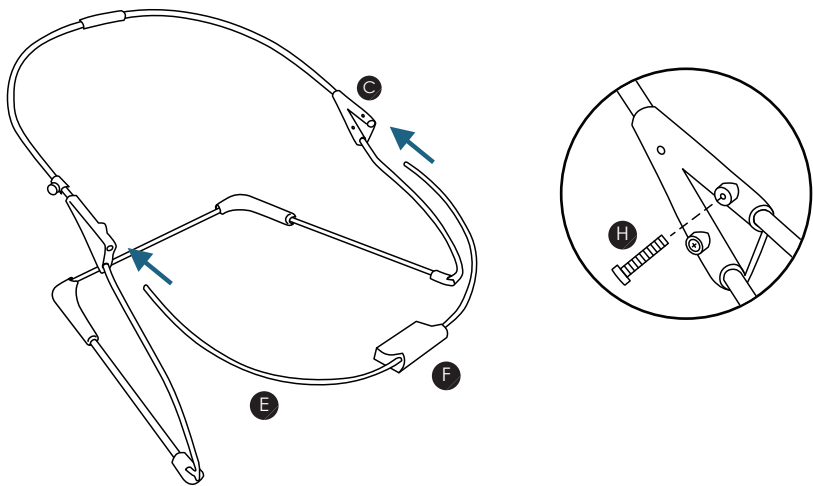

Assembling The Bouncer

Undo the clips on the back of the seat pad (K) and open the pocket at the rear.

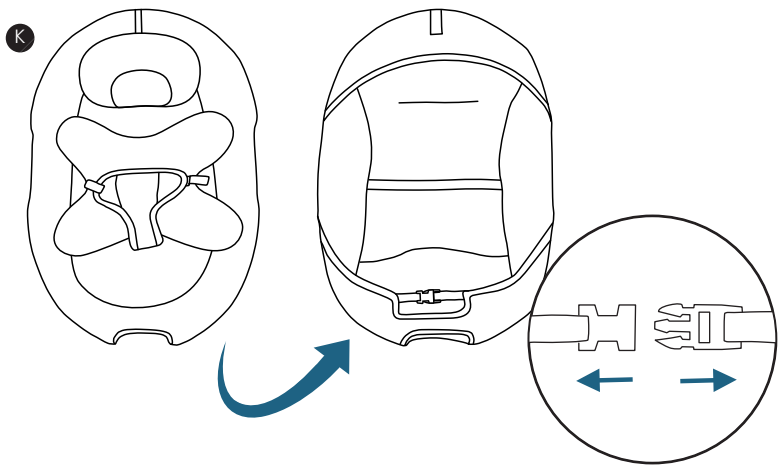

Slide the seat pad (K) over the backrest frame and stretch the bottom of the seat pad over the footrest frame.

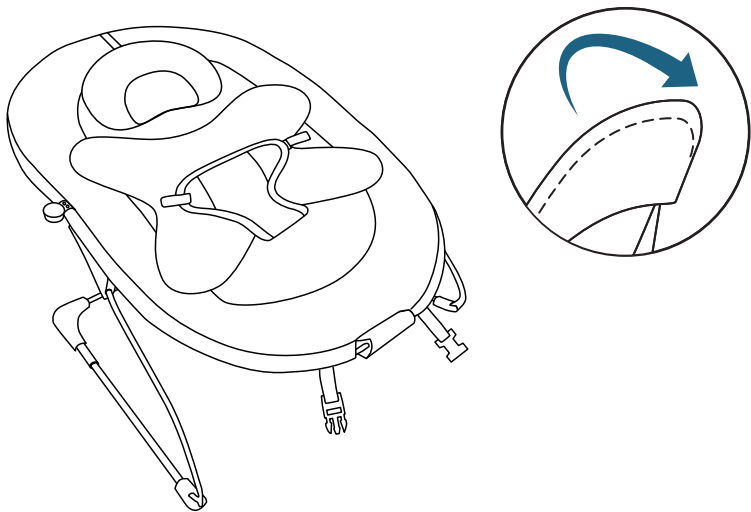

Assembling The Bouncer

Slide the top of the vibration box (D) through the hole in the seat pad and onto the footrest frame. Fasten the clips under the seat. Reverse this process to remove the vibration box.
NOTE. Ensure the vibration box has been fixed the right way up.

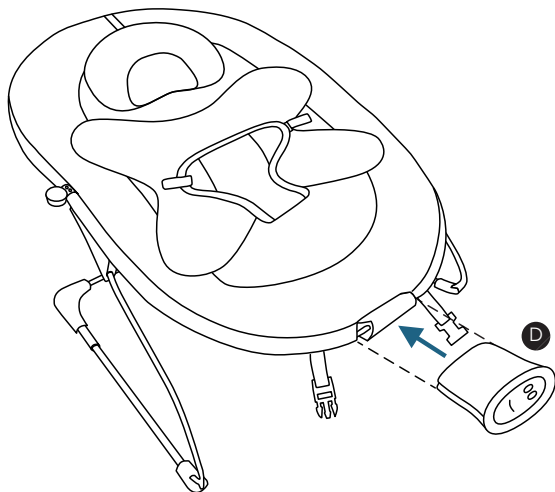

Fasten the clips under the seat. Reverse this process to remove the vibration box.
NOTE. Ensure the vibration box has been fixed the right way up.

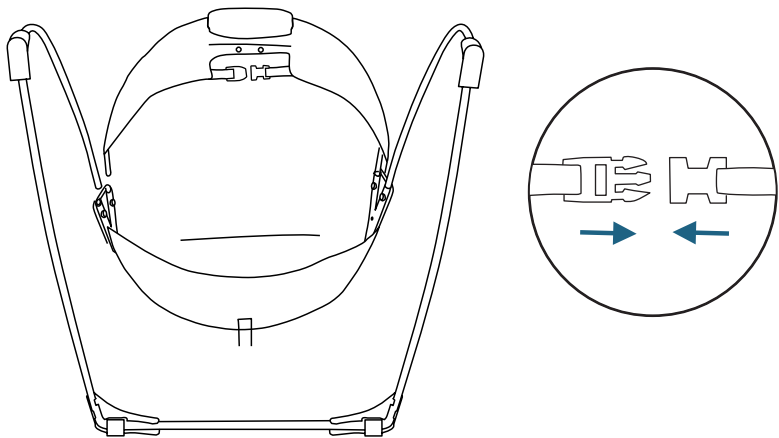

Assembling The Bouncer

Connect the toy bar (L) to the toys (M). Clip the toy bar and toys to the side of the bouncer frame. Pull the lip to remove the toy bar just above the plastic connector.

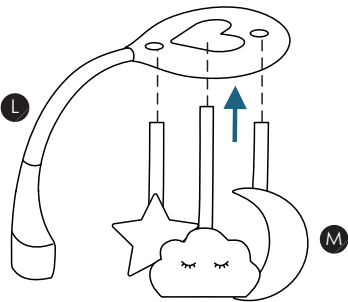

WARNING!

The toy bar is NOT a handle.
Never attempt to carry the
reclined cradle by the toy bar.

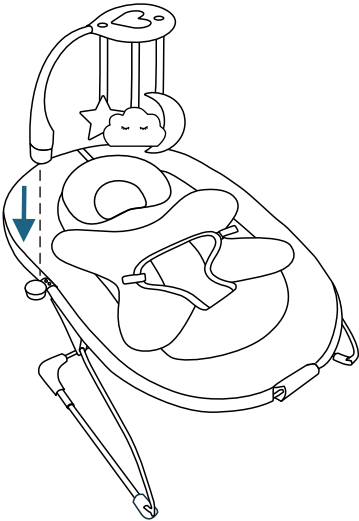
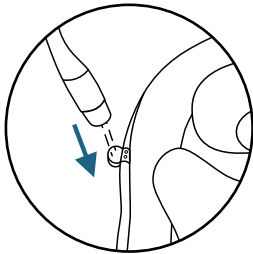

Harness

Place baby in the bouncer with the crotch strap positioned between their legs. Fasten the buckles on both sides of the restraint. A "click" will signal buckle is secure. Adjust the sliders on both straps to achieve a snug, comfortable fit.

To release, press the clips on the buckles and remove the harness strap.



WARNING!

ALWAYS use the restraint system.

Attaching:

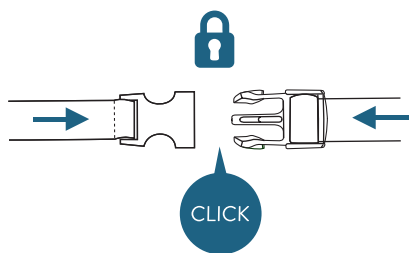

Removing:

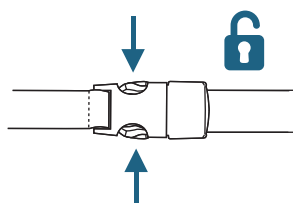

Vibration/Music Box

The vibration/music box has 3 vibration speeds.

Press the vibration button to start vibration. Continue pressing the button to increase the vibration speed. When on the fastest vibration, press the button again to turn off the vibration.

There are 8 melodies with 3 volumes.

Press the music button to start the melody. Press the button a second and third time to increase the volume. Pressing the button another time will move to a new melody.

The melody will automatically stop.

Vibration:



Music:



Care And Maintenance

Cleaning

- The fabric cover is removable for easier cleaning.
- Do not wash the fabric cover. Spot clean only using soft sponge with diluted detergent or water.
- Do not rub. Dry in shade.
- Do not iron.
- Do not dry clean.
- Do not wash the toys. Wipe clean only using a soft sponge with diluted detergent or water. Do not rub.
- Clean metal or plastic components with mild detergent and warm water.
- Never use abrasive, ammonia based, bleach based or spirit type cleaners.
- Ensure the product is fully dry before use or storage.

Maintenance

- All assembly fittings are to be tightened properly.
- Inspect regularly and re-tighten as necessary.
- Store product in a dry location away from any heat sources, and not in the sun.
- Do not use accessories or replacement parts other than those approved by the manufacturer.

Troubleshooting Tips

| Issue | Possible Root Cause | Solution |
|--|--|--|
| Bouncer doesn't rock or bounce smoothly. | <ul style="list-style-type: none">· Uneven floor surface.· Loose or incorrectly assembled parts. | Place the bouncer on a flat, stable surface. Check that all screws, joints, and locking mechanisms are tight and properly fitted. |
| Harness straps are too loose. | Not tightened. | Adjust the harness to the appropriate size for the baby's growth. Ensure that the straps are not twisted. |
| Harness buckle not closing. | Dirt or debris. | Clean the buckle regularly to remove any debris or food build up. Check the buckle parts for damage or misalignment. |
| Vibrating function doesn't work. | <ul style="list-style-type: none">· Batteries are drained or inserted incorrectly.· Battery compartment not fully closed. | Replace with new batteries, following the +/- direction guide. Ensure battery compartment cover is properly secured. |

For any and all other product issues not covered in the above please contact our dedicated customer services team at the below web address and they will endeavour to resolve any queries that you may have as soon as possible.

Contact: support@pugglebaby.co.uk

Recycling the Packaging

When you've unpacked your product and have ensured that all parts are present, please discard packaging components in accordance with your local authority guidelines, for further information please check the material and your postcode at <https://www.recyclenow.com/recycle-an-item>. Your packaging will include the following materials;

Carton - 5Ply Corrugated Paper - Widely recycled in your card and paper bin
Polybag - PE Plastic - Recycle with bags at large supermarkets.

Notes
