

The background of the entire page is a repeating pattern of small, solid brown circles (polka dots) scattered across a white background.

PUGGLE

Lowton Luxe Infant Car Seat

Instruction Manual

Welcome!

Thank you for purchasing the Puggle Lowton Luxe Infant Car Seat.

This instruction manual will guide you through the setup, use, and maintenance of your new car seat, ensuring you get the most out of its versatile features. Please read through the following information and safety warnings carefully to fully understand and enjoy all the benefits your car seat has to offer, and to ensure its safe operation.

We're here to help!

If you have a query with this product or require replacement parts, please contact us at the web address below.

thenurserystore.com/contact-us

Follow us on social media:



Facebook



Instagram



YouTube



Tiktok



X (formerly known as Twitter)



Pinterest

Important Information



IMPORTANT! Your Lowton Luxe Infant Car Seat may differ slightly from images shown above and throughout, as the images are for illustration purposes only.

Your Lowton Luxe Infant Car Seat is tested to comply with ECE R 44/04.

- DO NOT use parts or accessories which are not approved or supplied by the manufacturer.

Safety Instructions

Notice

1. This is a “Universal” child restraint. It is approved to Regulation No. 44, 04 series of amendments, for general use in vehicles and it will fit most, but not all car seats.
2. A correct fit is likely if the vehicle manufacturer has declared in the vehicle handbook that the vehicle is capable of accepting a “Universal” child restraint for this age group.
3. This child restraint has been classified as “Universal” under more stringent conditions than those which applied to earlier designs which do not carry this notice.
4. Only suitable if the approved vehicles are fitted with 3-point safety belts, approved to UN/ECE Regulation No. 16 or other equivalent standards.
5. DO NOT place rear facing child seat on front seats with airbags.

DANGER!

DO NOT USE THE CAR SEAT POSITIONED ON A PASSENGER SEAT EQUIPPED WITH AIRBAG.

The opening of an airbag against the infant car seat can cause serious injury, if not death, to the child. Refer to the vehicle instruction manual.

With regards to the use of car seats, check whether the compatibility with ISOFIX retention systems is indicated in the vehicle's use and maintenance manual.



IMPORTANT - Read the instructions carefully before use and keep for future reference.

- **WARNING:** Please read these instructions carefully, as incorrect installation may result in serious injury. If any injuries should occur as a result of incorrect installation, the manufacturer will accept no responsibility.
- **WARNING:** The car safety seat offers maximum protection and is only safe when used in accordance with the instructions.
- **WARNING:** Your child's safety may be affected if you do not follow these instructions.
- **WARNING:** Instruction illustrations are for informational purposes only. The child restraint system may contain small differences compared to the photographs or diagrams in the instruction manual.
- **WARNING:** This child safety seat is suitable for use as Group 0+ from birth to 13 kg/29lbs (approx. 12-15 months).
- **WARNING:** Never leave your child unattended in the seat, either in or out of the car.
- **WARNING:** Never use the car seat on a passenger seat fitted with a front airbag. IT IS VERY DANGEROUS AND ILLEGAL.
- **WARNING:** DO NOT place rear-facing child seat on front seat with airbag. DEATH OR SERIOUS injury can occur.
- **WARNING:** You must never fit the car seat with a 2-point lap belt.
- **WARNING:** ALWAYS use the restraint system.
- **WARNING:** Before use check that the car seat is compatible for use in your car.
- **WARNING:** For use as part of the Puggle Lowton Luxe 2-in-1 Travel System. Do not use with other prams or pushchairs.
- **WARNING:** The seat cover should not be replaced with any other than the one recommended by the manufacturer, because the cover constitutes an integral part of the restraint performance.
- **WARNING:** Never use the child safety seat without both the cover and pads provided.
- **WARNING:** Do not disassemble or modify this child safety seat or harness, as this may seriously compromise the function and safety of this product.
- **WARNING:** Child seats or accessories that are damaged or have been used incorrectly must be replaced.

- **WARNING:** Do not use any load bearing contact points other than those described in the instructions and marked in the child restraint.
- **WARNING:** Do not leave heavy objects unsecured inside the car, as these may injure the child in the event of an accident.
- **WARNING:** Ensure that no part of the child seat is caught in the door of the vehicle or in a reclining seat. In addition, ensure that the safety seat is correctly installed and secured.
- **WARNING:** Rigid items and plastic parts of the child restraint must be positioned and installed so that they do not, under normal everyday use of the vehicle, become trapped by a moveable seat or in a door of the vehicle.
- **WARNING:** Do not place the car safety seat on high surfaces, such as tables, worktops, beds, etc., due to the risk of falling.
- **WARNING:** This product is not intended for prolonged periods of sleeping.
- **WARNING:** Never place your child in the seat without securing them with the harness.
- **WARNING:** The seat should always be secured with a seat belt, even when not in use.
- **WARNING:** Always check that folding seats in the vehicle are locked securely before installing the child restraint.
- **WARNING:** Protect the child safety seat from direct sunlight, as metal and plastic fittings could become hot and can be harmful to the child.
- **WARNING:** You must replace the child restraint system if it is involved in an accident. It may have unseen damage and may not protect your child as well as it should.
- **WARNING:** You must replace the child restraint system and the safety belts if they become worn or damaged. It is not recommended to purchase or use second hand child restraint seats as there may be unseen damage and the product safety cannot be guaranteed. The manufacturer only guarantees this product with the original owner.

Installation Positions

In the vehicle seats. ✓

This child safety seat may only be installed in front seats in the following circumstances: ?1

1. If the vehicle is not equipped with rear seats.
2. If all rear seats are already occupied by children exceeding 135cm in height.
3. If it is not possible to install all child restraint systems in the rear seats.

Group 0+ Install rearward facing ✓

Notice

- **Never use in front passenger seats equipped with active airbag.** ?1
- **If your center rear passenger seat is only fitted with a 2 point lap belt the child safety seat must not be used. It is only suitable with a 3 point safety belt.** ?2

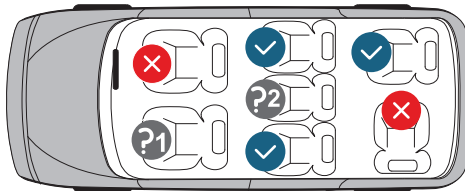
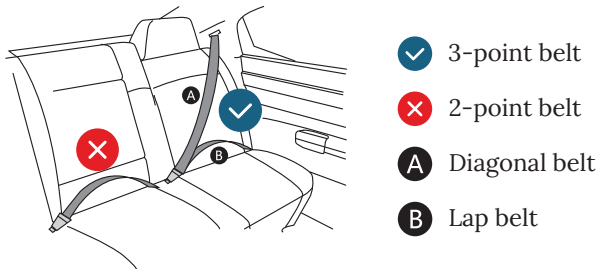

Symbols and their meaning

There are a number of symbols used through this manual, please find below breakdown of what each symbol is and what it means.



Direction indicator showing direction of assembly, rotation, function.



Indicates if product is locked or unlocked



Correct and incorrect

Before Assembly

Before assembly, please ensure that you have read and understood the instructions. Then carefully unpack your car seat and ensure that all parts are present. Please see parts list as follows.

What's in the box

x1 Puggle Lowton Luxe 2-in-1 Travel System

x1 Puggle Lowton Car Seat

x1 Instruction Manual

Parts List

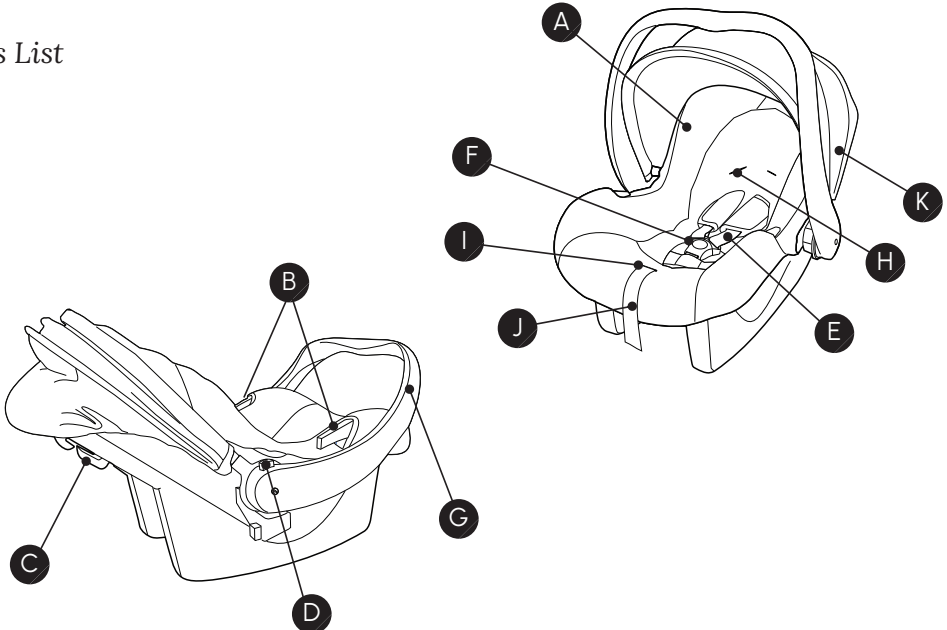

Parts included with your Lowton Luxe Infant Car Seat are:

Part	Description
A	Car seat shell
B	Lap belt guide
C	Diagonal belt guide
D	Handle adjustment button
E	Harness
F	Buckle housing button
G	Carry handle
H	Harness routing
I	Harness release button
J	Harness adjuster strap
K	Canopy

To store this instruction manual with your car seat, insert it underneath the seat cover.

Adjusting the handle

1. The car seat has four handle positions.

To adjust the handle position, push in and hold both handle release triggers located on the sides of the handle. Move the handle to the required position and make sure that both sides “click” into position.

- A. Fitted in the car position
- B. Carrying and rocking position
- C. Travel System mode and helps access in and out of car
- D. Stationary position

WARNING: Make sure that you understand the different handle positions and can correctly adjust the handle to the required position.

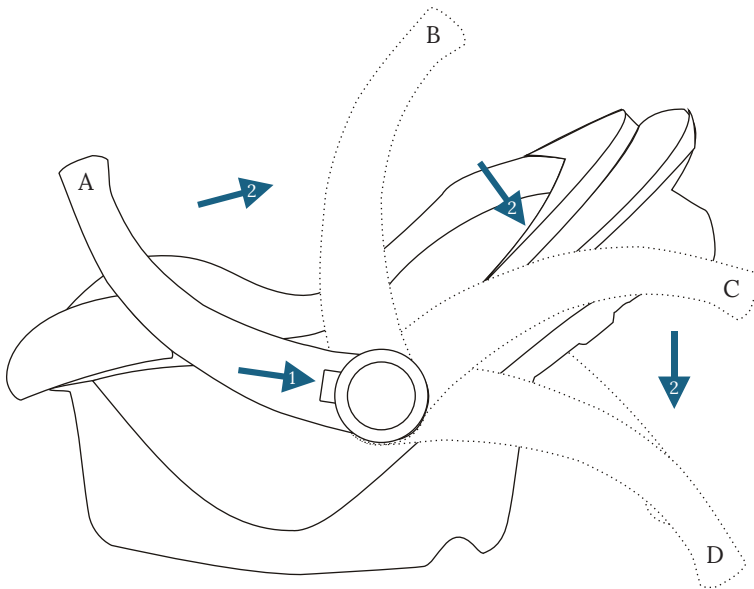

Adjusting the harness

2. Press the fastening harness button located on the side of the buckle housing to open. Pull the shoulder harness fasteners apart.

WARNING: Shoulder straps should be level with, or just below the child's shoulders.

WARNING: Before you install the car seat into a vehicle it is very important that you ensure the shoulder straps are at the correct height for your baby.

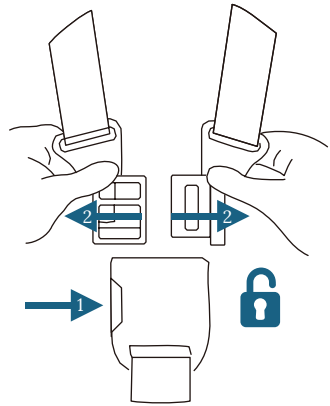

3. Place the car seat on a level surface. Press the harness release button and at the same time pull both shoulder straps forward to slacken the shoulder straps.

Note. the button may be hidden by the seat cover.

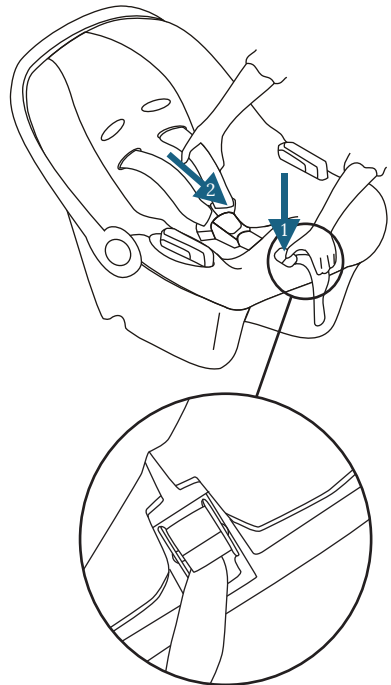

Adjusting the harness

4. Open the harness buckle and thread the harness through the shoulder harness routing to adjust the shoulder height position. Once desired height is chosen, thread the harness back through the harness routing.

WARNING: Ensure both of the shoulder straps go through harness routing at the same height and the harness does not twist.

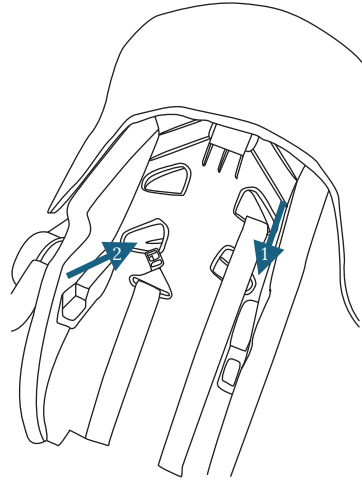

5. Once the desired shoulder position has been fitted pull the end of the harness to tighten.

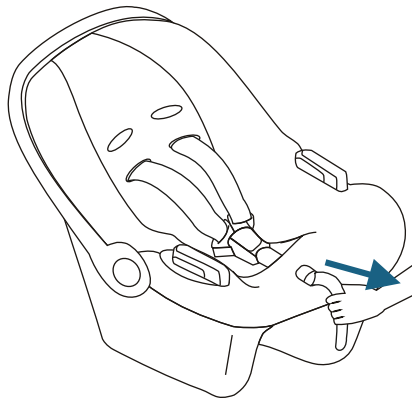

Harness Operation

6. Place the shoulder straps over the sides of the car seat.
7. Carefully place the baby in the car seat and check that the shoulder straps are in the correct position for your baby's shoulders.

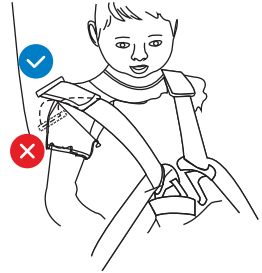

WARNING: Before you install the car seat into a vehicle it is very important that you ensure the shoulder straps are at the correct height for your baby.



8. Position the 3-point harness over the baby making sure there are no twists.
9. Fit the shoulder harness fasteners together and then push firmly into the buckle housing. Listen for the "click".

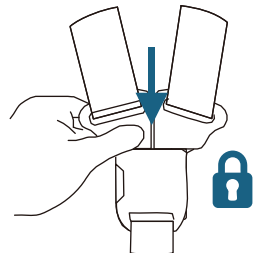
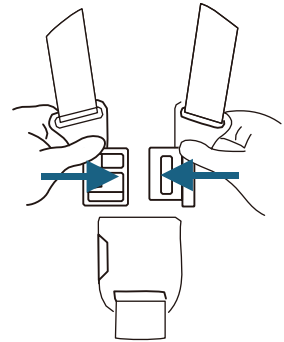

Harness Operation

10. Pull both shoulder straps towards you to remove any slack.
11. Pull the harness adjuster strap to tighten the harness until the baby is secure.

WARNING: Your child must be fastened in the safety harness at all times when using the car seat.

WARNING: You should only be able to insert 2 fingers between the shoulder straps.

WARNING: Do not add additional items such as blankets or padded clothing. Bulky items can lead to incorrect harness tightening. In an accident the child can slip out of the restraint if not properly tightened.

12. To remove your child from the car seat, slacken the shoulder straps, unfasten the harness and place shoulder straps over the side of the car seat.

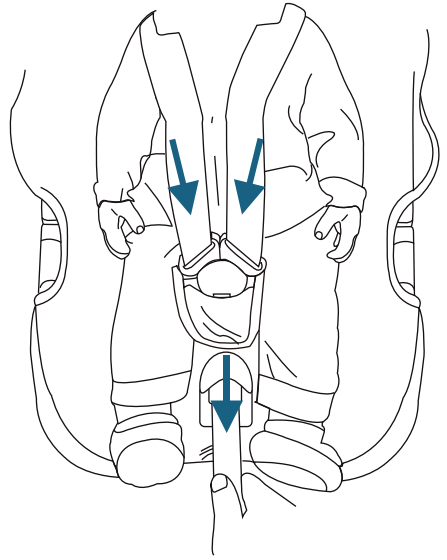

Installing the Car Seat in the Vehicle

- Adjust the car seat handle to position A and place the car seat on the vehicle seat with your baby facing the back of the vehicle.

WARNING: Never use the car seat on a passenger seat fitted with a front airbag. It is **VERY DANGEROUS AND ILLEGAL**.

WARNING: The car seat must always be fitted using a 3-point lap and diagonal seat belt.

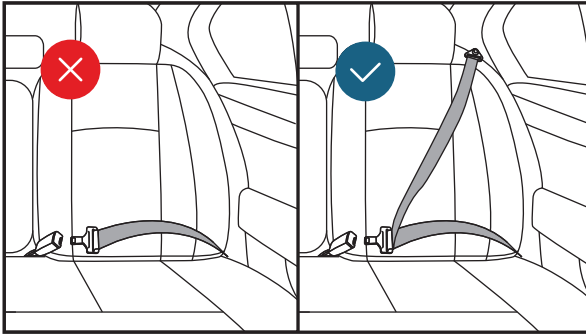

WARNING: The car seat must **ALWAYS** be rearward facing with your baby facing the back of the vehicle.

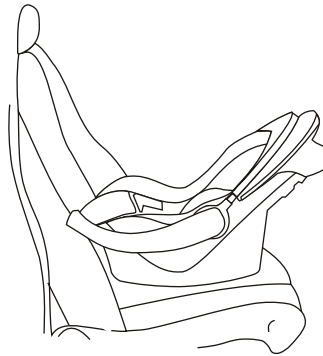
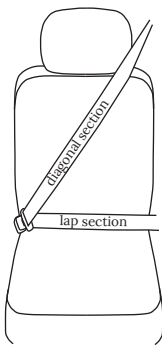

Installing the Car Seat in the Vehicle

14. Slowly pull the seat belt out across the car seat and fasten the seat belt.
15. Pass the lap section of the seat belt through both lap belt guides.

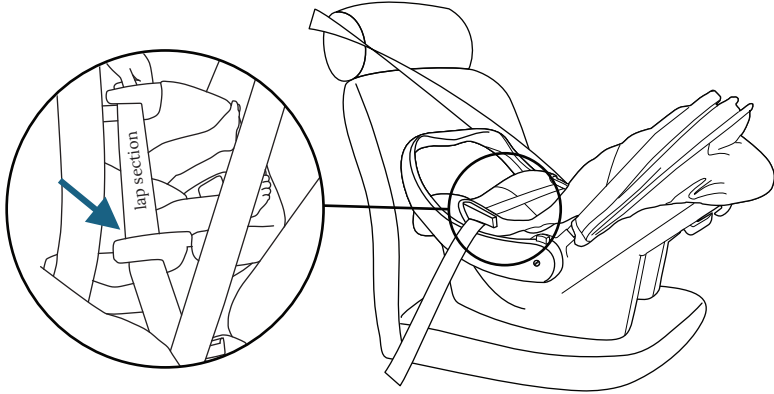

16. Pull the diagonal section of the seat belt around the back of the car seat. Place the diagonal section of the seat belt securely into the diagonal belt guide positioned on the back of the car seat.
17. Holding the car seat firmly pull the diagonal section of the seat belt to remove any slack.

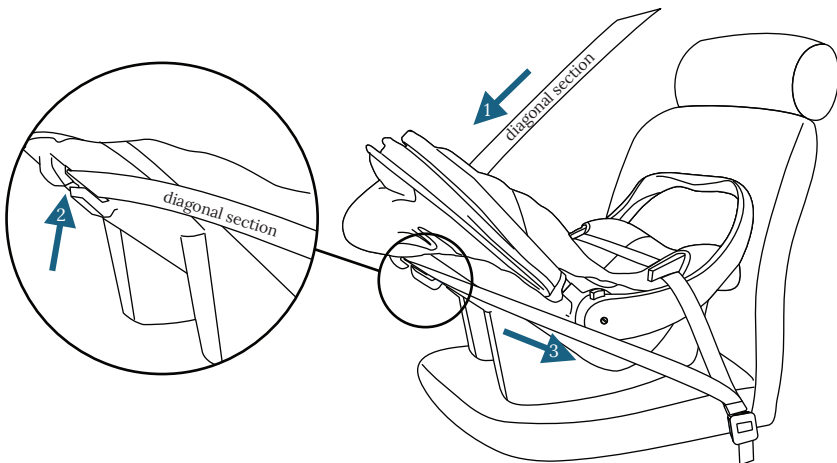

Installing the Car Seat in the Vehicle

18. Fasten the vehicle seat belt.
19. Check that the angle of the car seat back rest is not too upright and make sure the seat belt is not twisted. Push firmly on the back of the car seat. It should feel tight and secure. There should be no excessive movement forward or to the side.

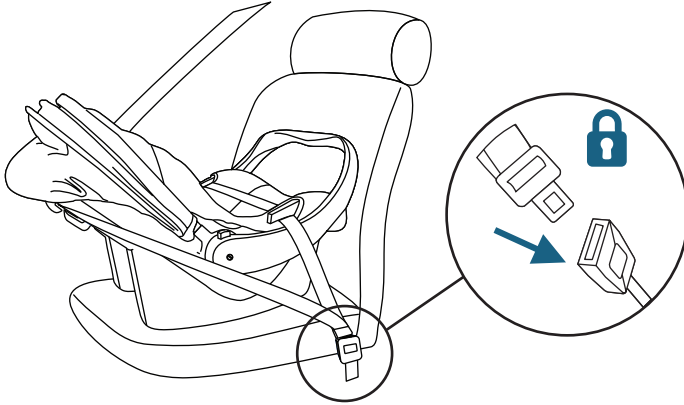

Removing the Car Seat from the Vehicle

20. Remove the diagonal section of the seat belt from the diagonal belt guide.
21. Unfasten the seat belt and remove the belt from the lap belt guide taking care to hold the seat belt away from the baby.

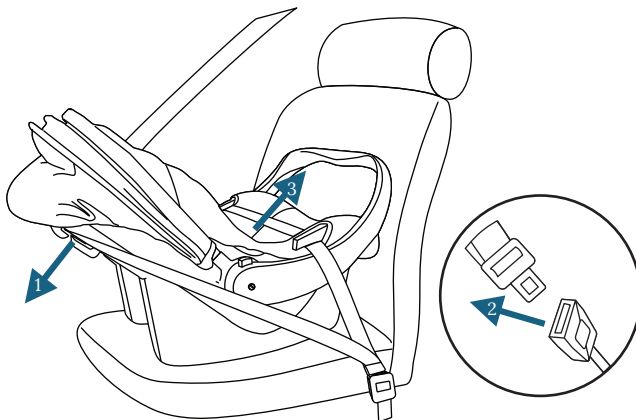

Removing the Car Seat from the Vehicle

22. Adjust the car seat handle to position B and carefully remove the car seat from the vehicle.

WARNING: Ensure the handle has clicked into the correct position before lifting the car seat.

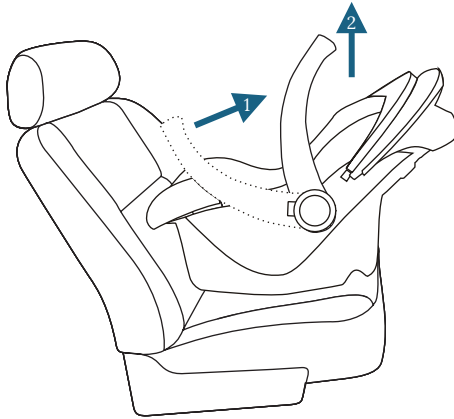

Storing the Manual

23. It is very important to keep the instruction manual for future reference.
To store instruction manual with your car seat, pull up the seat cover and insert manual for safe keeping.

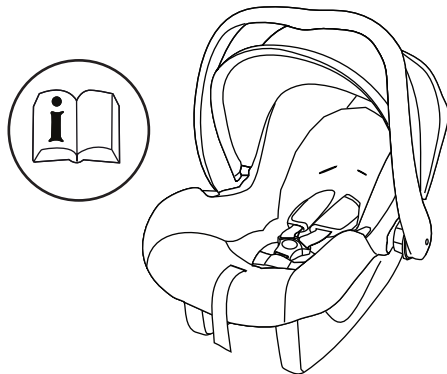

Care and Maintenance

Cleaning

It is important to only use the original upholstery as this is an essential part of the functionality.

- DO NOT wash fabrics. Spot clean only using a soft sponge with diluted detergent or water. Dry in shade and not in the sun. Do not iron. Do not dry clean. Wipe metals and plastic parts with a mild detergent and lukewarm water.
- DO NOT use chemical cleaners or bleaches (ammonia, petrol, solvents etc.) under any circumstances.

Care for the Harness Buckle

It is vital for the safety of the child that the harness buckle works correctly.

Malfunctions of the harness buckle are usually caused by accumulations of dirt or foreign bodies.

Malfunctions are as follows:

- The buckle latches are ejected before the release button is pressed.
- The buckle latches will no longer lock home (i.e. they are ejected again if you try to lock them.)
- The buckle latches engage without an audible “click”.
- The buckle latches are difficult to insert (you feel resistance).
- The buckle only opens if extreme force is applied.

WARNING: The integrated harness system cannot be removed from the seat. Do not remove parts of the restraint system.

Maintenance

All important parts of the infant car seat should be checked regularly to make sure they are not damaged. This type of product requires careful and regular maintenance by the user.

- All mechanical components must function properly.
- It is absolutely essential to ensure that the infant car seat is not stuck between hard objects such as vehicle doors, seat rails etc. as this could cause damage.
- Protect the product from atmospheric agents, water, rain, snow. If necessary, immediately dry all the metal parts in order to avoid the formation of rust.
- DO NOT store the product if it is wet. DO NOT leave in humid environments. Mold is formed when a product is left in humid environments without air circulation that can dry the surface.

After an Accident

WARNING: An accident can cause damage to the infant car seat that is not clearly visible. The child restraint system and vehicle seat belts should be replaced. Although they may look undamaged, they may not protect your child as well as they should. If in doubt, contact your dealer or manufacturer.

Product Lifespan

Gradual wear of plastic, for example caused by exposure to sunlight (UV), can cause a slight deterioration of product properties. Since very high temperature fluctuations and other unpredictable stresses are common in vehicles, the following points must be observed:

- If the vehicle is directly exposed to strong sunlight for long periods, the child seat must be removed from the vehicle or covered with a light cloth.
- Regularly check all plastic and metal parts of the seat for any damage or changes in shape or color. If you notice a change in the seat, it must be disposed of or checked and replaced by the manufacturer if necessary.
- Fabric variations, especially fading, are normal with use in a vehicle and do not affect the functionality of the seat.

Disposal

To protect the environment we ask the user to separate and dispose of the waste arising at the beginning (packaging) and at the end (parts of the product) of the life of the infant car seat. Waste disposal is organized differently according to local authorities. To ensure that the infant car seat is disposed of in accordance with regulations, contact your local waste disposal agency or local authority. Always observe the waste disposal regulations of your country.

Troubleshooting Tips

Issue	Possible Root Cause	Solution
Harness not adjusting properly.	Twisted or caught in the buckle	Make sure the adjusters are free from any obstruction, and try pulling the straps slowly to adjust them.
Buckle is too stiff	Debris or dirt.	Clean the buckle and check for dirt, and food crumbs. If the buckle is jammed, try using a bit of lubricant or cleaning the clasp carefully with a damp cloth.

For any and all other product issues not covered in the above please contact our dedicated customer services team at the below web address and they will endeavour to resolve any queries that you may have as soon as possible.

thenurserystore.com/contact-us

Recycling the Packaging

When you've unpacked your product and have ensured that all parts are present, please discard packaging components in accordance with your local authority guidelines, for further information please check the material and your postcode at

<https://www.recyclenow.com/recycle-an-item>. Your packaging will include the following materials;

Carton - 5Ply Corrugated Paper - Widely recycled in your card and paper bin

Polybag - PE Plastic - Recycle with bags at large supermarkets

WARRANTY

Thank you for purchasing your Puggle product.

At the Nursery Store we endeavour to provide quality, affordable products and as such we look to provide you as a proud parent with peace of mind that your Puggle product comes with a standard 12 months warranty.

Your Puggle product is guaranteed for 12 month from the date of original purchase. If any defects should arise due to faulty workmanship or material, your faulty product should be returned to us and repair, replacement or refund will be at our discretion based upon thorough investigation from our QA team.

The guarantee is subject to the following provisions:

- The product must be assembled correctly and operated in accordance with the requirements contained within the instruction manual.
- The product must be solely used for domestic purposes.
- It does not cover general wear and tear, damage, misuse or any consumable parts.
- The warranty is rendered invalid if the product has been resold or has been damaged through inexpert repair.
- The warranty is only valid within the UK.

You do not need to validate your 12 month warranty, it will be effective as of initial purchase date.

For full terms and conditions please see online at, www.thenurserystore.com/warranty

Notes

A series of horizontal dashed lines for writing notes, spanning the width of the page.

Notes

A series of horizontal dashed lines for writing notes.

The background of the entire page is a repeating pattern of small, solid brown circles (polka dots) scattered across a white background.

PUGGLE

thenurserystore.com

Imported by Online4baby Ltd.

Meadowbank, Tweedale Way, Oldham, OL9 8EH