

PUGGLE

Snacky Booster Highchair

Instruction manual

Welcome!

Thank you for purchasing the Puggle Snacky Booster Highchair.

This instruction manual will guide you through the setup, use, and maintenance of your new booster highchair, ensuring you get the most out of its versatile features. Please read through the following information and safety warnings carefully to fully understand and enjoy all the benefits your booster highchair has to offer, and to ensure its safe operation.

We're here to help!

If you have a query with this product or require replacement parts, please contact us at the web address below.

thenurserystore.com/contact-us

Follow us on social media:

 Facebook

 Instagram

 YouTube

 TikTok

 X (formerly known as Twitter)

 Pinterest

Important Information

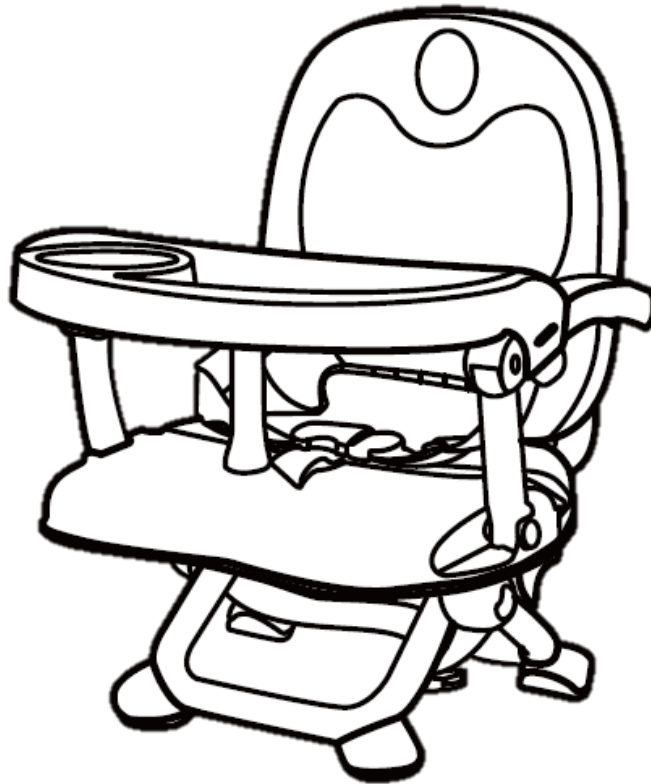

IMPORTANT! Your Snacky Booster Highchair may differ slightly from images shown above and throughout, as the images used are for illustration purposes only.

Your Snacky Booster Highchair is tested to comply with EN 16120:2012+A2:2016.

- DO NOT use parts or accessories which are not approved or supplied by the manufacturer.

Safety Instructions

IMPORTANT – Read the instructions carefully before use and keep for future reference.

- **WARNING:** A child's safety is your responsibility, never leave the child unattended.
- **WARNING:** DO NOT allow other children to play unattended near the booster seat.
- **WARNING:** Adult assembly is required.
- **WARNING:** Ensure that all components are fitted securely into place and tightened where applicable before allowing your child to sit in the booster seat.
- **WARNING:** The harness must always be used and correctly fitted.
- **WARNING:** This product is suitable for use by one child at a time only.
- **WARNING:** DO NOT overload this product, maximum capacity is 15kg (approx. 36 months).
-

- **WARNING:** DO NOT use the booster highchair until your child can sit up unaided (approx. 6 months).
- **WARNING:** Always check the security and stability of the booster seat on the adult chair before use.
- **WARNING:** DO NOT install the product on highchairs. It is dangerous to use this product on an elevated surface.
- **WARNING:** DO NOT leave small objects on the booster seat which the child could swallow.
- **WARNING:** DO NOT use the booster seat on chairs in the vicinity of curtain cords, windows or heat sources.
- Never use the product as a swimming aid or floating chair in a swimming pool.
- When not in use, the booster seat must be kept out of the reach of children.
- Always use the booster seat on an adult chair with seat dimensions larger than the booster.
- Ensure that the adult chair with the chair mounted seat is placed in a position where the child is not able to use its feet to push against the table or any other structure as this can cause the tip over of the adult chair supporting the chair mounted seat.
- Ensure your child cannot push against the table or another surface as this could result in the booster seat tipping over.
- Never lift this product with your child sat in it.
- When adjusting, ensure that moving parts do not come into contact with the child's body.
- **WARNING:** DO NOT use this booster seat in motor vehicles.
- **WARNING:** DO NOT use this booster seat on stools or benches.
- Never use the booster seat on broken or unstable chairs, folding chairs, rocking chairs or chairs with armrests.
- Before fastening the booster seat to the chair, ensure that the floor and chair are perfectly horizontal; Never install the product on chairs which are positioned on sloping or uneven surfaces.
- DO NOT use the chair mounted seat if any part is broken, torn or missing.
- DO NOT use accessories or replacement parts other than those approved by the manufacturer.
- This product is intended for children able to sit up unaided (minimum 6 months) and up to 3 years old or a maximum weight of 15kg.
- Must be attached to adult chair with minimum dimensions: seat 30cm (W) x 31 (D), backrest: 43cm (H).
- This booster highchair conforms to EN 16120:2012+A2:2016.

Symbols and their meaning

There are a number of symbols used through this manual, please find below breakdown of what each symbol is and what it means.



Direction indicator showing direction of assembly, rotation, function.

Before Assembly

Before assembly, please ensure that you have read and understood the instructions. Then carefully unpack your booster seat and ensure that all parts are present, please see parts list as follows.

What's in the box

x1 Puggle Snacky Booster Highchair

x1 Instruction Manual

Parts List

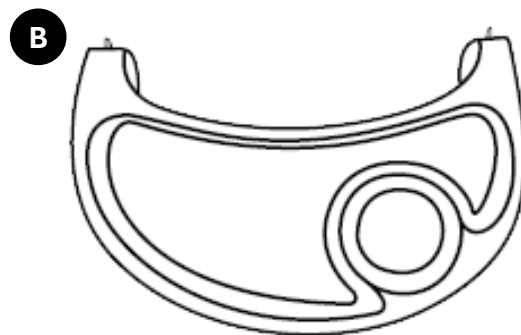
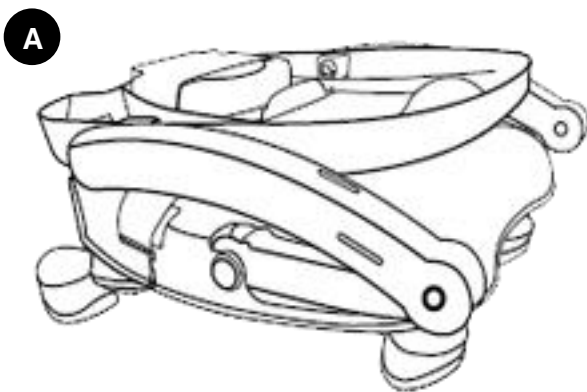

Parts included with your Snacky Booster Highchair are:

Part	Description	Quantity
A	Main Body	1
B	Snack Tray	1
C	Safety Strap	2

Discard packaging in accordance with your local authority guidelines.

Assembling the Booster Seat

1. Unfold the Main Body (A) as shown in the diagram below, when fully unfolded it will click into place.

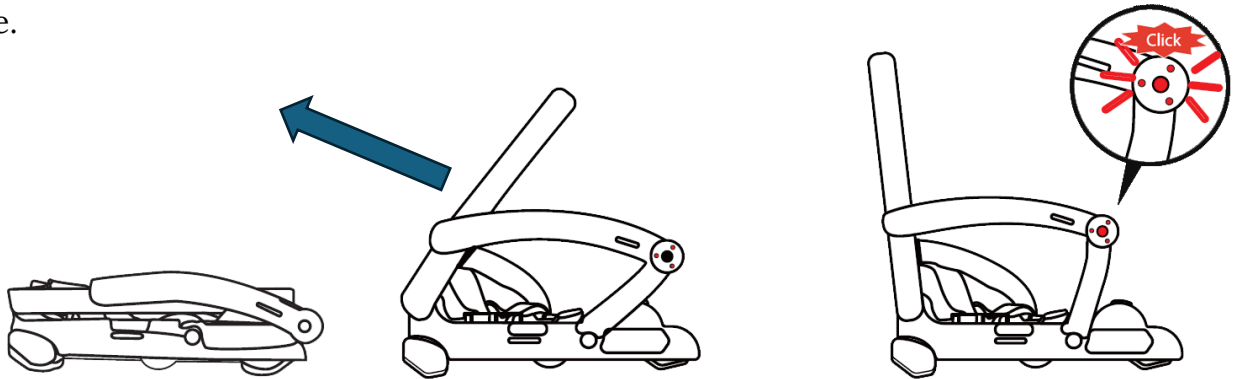

2. Adjust the height position, according to the requirements of the child, press the height adjustment button on both sides of the Main Body (A) as shown below and then adjust the height accordingly. The seat will click to indicate the height position is locked into place.
3. To fold the legs back down press the height adjustment button on both sides of the Main Body (A) and fold the legs up flat until they sit flush in the frame as per the below far right image.

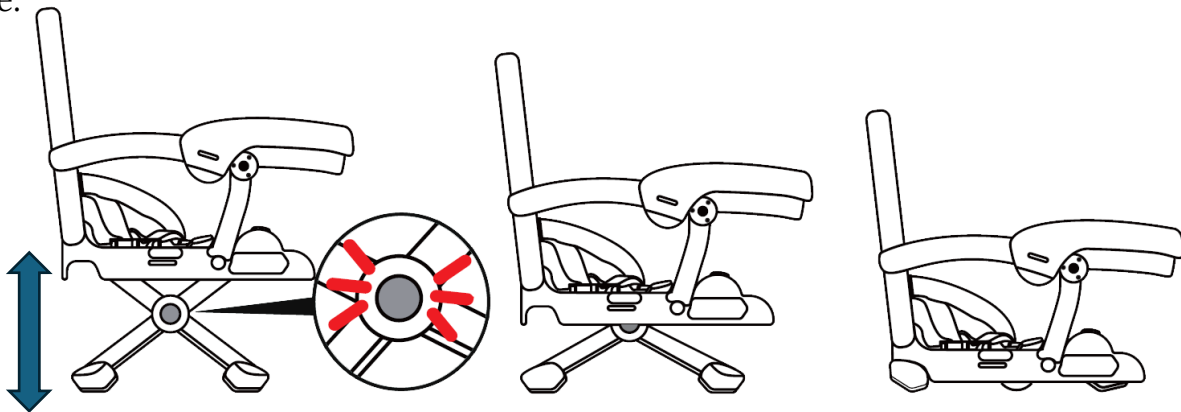

4. To install the Snack Tray (B), simply insert the Snack Tray (B) into the corresponding slots on the Main Body (A) and then press down to click in place. Gently pull up on the Snack Tray (B) to ensure securely in place, pull the crotch guard down and slot into place on the Main Body (A). To remove pull the handle as shown below right out and lift the Snack Tray (B) up and away from the Main Body (A).

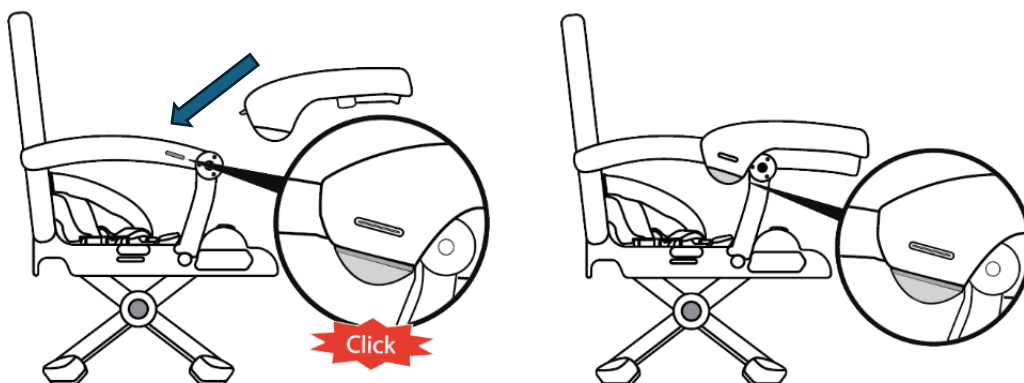

Assembling the Booster Seat

5. Ensure that the harness is correctly installed, by checking that the crotch strap is fed through the front slot on the Main Body (A) and is securely in place. The waist straps slot through the slots on either side of the backrest of the Main Body (A) and the metal 'C' shaped brackets should be fed through the straps to secure in place as shown in the images below. Gently pull on the harness to ensure correctly installed.

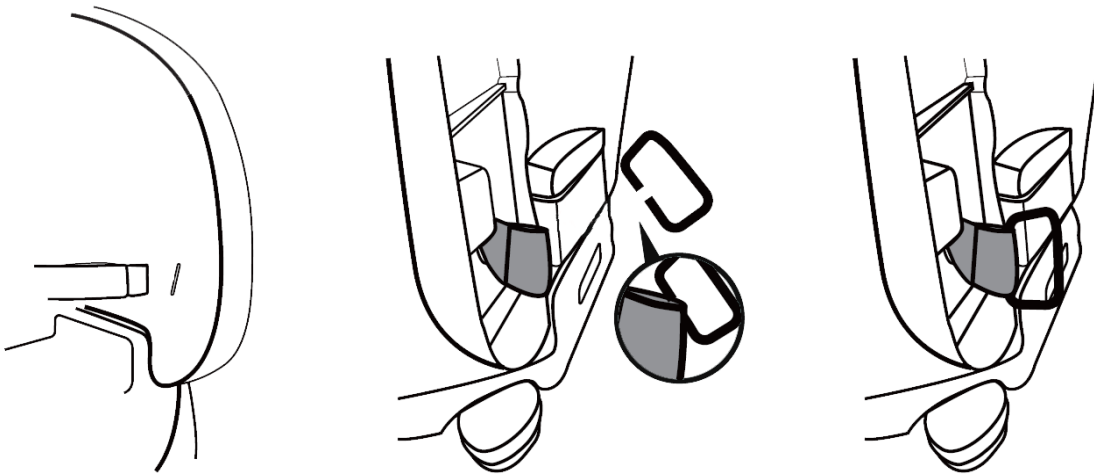

6. To secure the harness push the waist straps into the crotch buckle and the harness will click to indicate locked into place. Gently pull on the waist straps to ensure securely in place. The waist straps can be adjusted to suit the child by tightening or loosening accordingly.

WARNING: Correct and secure fit of the waist straps, will allow for 2 finger width.

7. To remove simply press the buckle and release the straps accordingly.

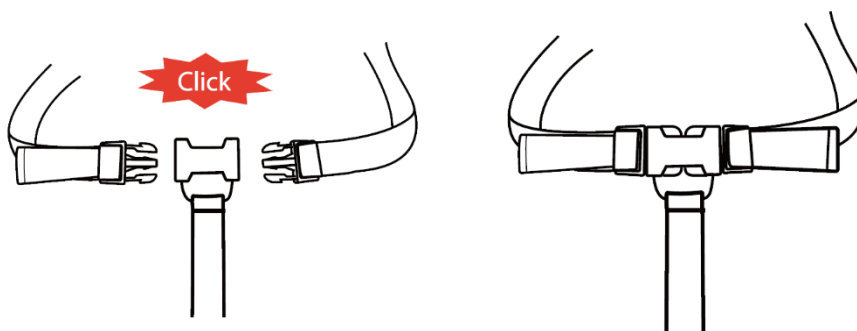

Assembling the Booster Seat

8. To mount the booster seat on an adult chair, attach the Safety Straps (C) to the Main Body (A). Feed one of the Safety Straps (C) on the backrest through the 'C' shaped metal bracket at the rear of the backrest on the Main Body (A) and the remaining Safety Strap (C) feed through the guide on the base of the Main Body (A) as shown below left. Loop the Safety Straps (C) around the adult chair on which to be mounted and then secure the buckles in place, tighten the straps where required. Gently pull on the main body, as a secure fit on the adult chair should allow little or no movement.

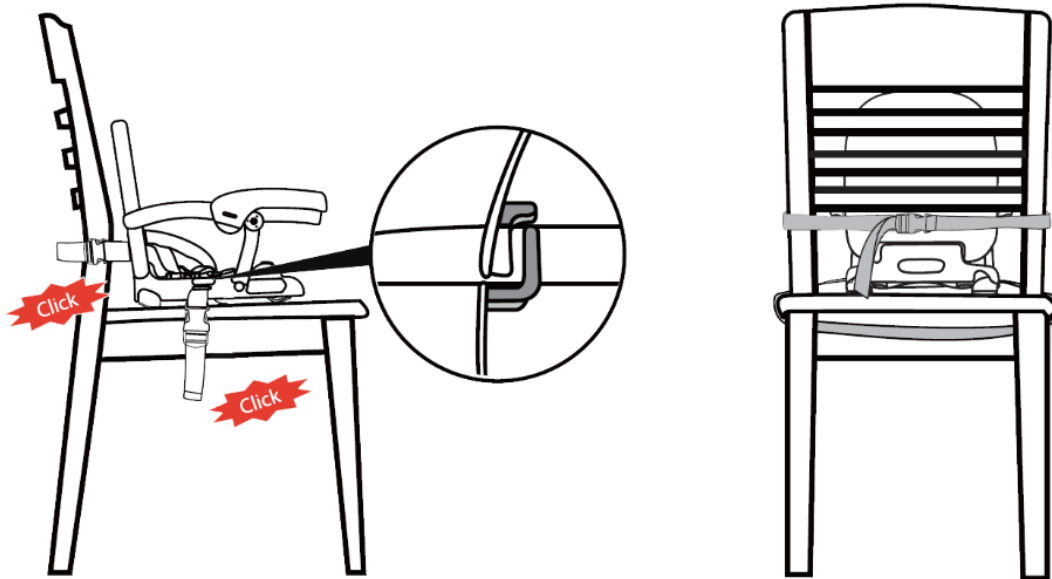

9. To fold, remove the booster seat from the adult chair and then remove the Safety Straps (C) from the Main Body (A) and then secure the Safety Straps (C) away safely. Press the fold button as shown below on either side of the Main Body (A), then fold the backrest forward until fully folded as shown below right.

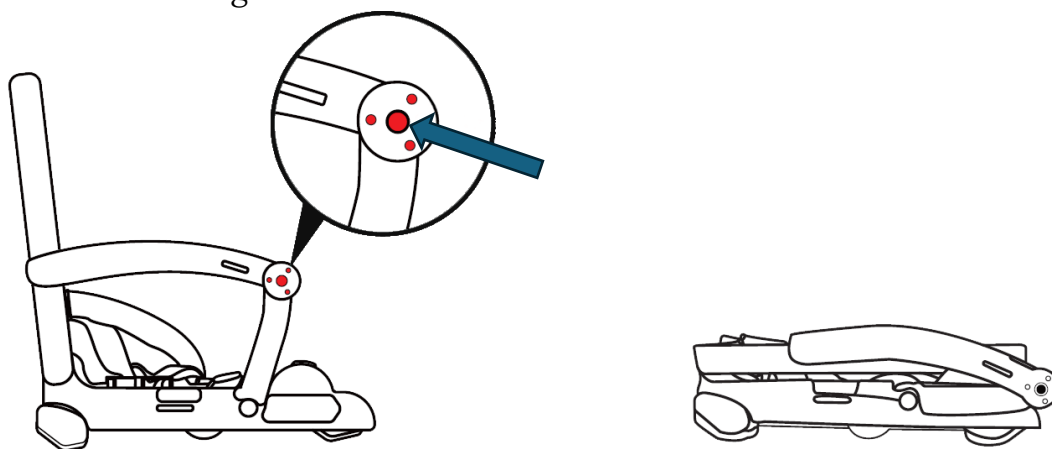

Care and Maintenance

Cleaning

- Clean the plastic parts with a soft damp cloth.
- DO NOT use harsh or abrasive cleaners or bleaches on this product, as they may damage the product.
- If the booster seat comes into contact with water, dry the metal parts to prevent the formation of rust.

Maintenance

- Cleaning and maintenance should be carried out by an adult, do not allow a child to do this unless supervised and correct instruction has been provided.
- Periodically check all fixings to ensure they remain tight and tighten where required.
- DO NOT use this product if any part is broken, torn or missing and use only spares provided by the manufacturer.
- If parts become stiff or difficult to operate, ensure dirt is not the cause, then try a light application of a silicon lubricant, ensuring it penetrates between the components. Regular lubrication of moving parts will extend the life of your product and make opening and folding easier.
- After exposure to damp conditions, dry off with a soft cloth and leave fully open in a warm environment. Storing damp will encourage mildew to form.
- Store in a dry place.
- DO NOT leave in sunlight for prolonged periods as some colours may fade.

Troubleshooting Tips

Issue	Possible Root Cause	Solution
Joints are stiff.	Lack of lubricant	Lubricate joint as per the instructions in the maintenance section.
Harness is not securely in place can be easily remove from the main body	Harness is not correctly installed.	Ensure that harness is correctly installed as per the assembly instructions (Step 5.)
Height cannot be adjusted	Height adjustment button has not been pressed on both sides.	Ensure that the height adjustment button is being pressed on both sides of the frame as per the assembly instructions (Step 2 & 3.)

For any and all other product issues not covered in the above please contact our dedicated customer services team at the below web address and they will endeavour to resolve any queries that you may have as soon as possible.

thenurserystore.com/contact-us

Recycling the packaging

When you've unpacked your product and have ensured that all parts are present, please discard packaging components in accordance with your local authority guidelines, for further information please check the material and your postcode at

<https://www.recyclenow.com/recycle-an-item>. Your packaging will include the following materials;

Carton – 5Ply Corrugated Paper – Widely recycled in your card and paper bin

Polybag – PE Plastic – Recycle with bags at large supermarkets

WARRANTY

Thank you for purchasing your Puggle product.

At The Nursery Store we endeavour to provide quality, affordable products and as such we look to provide you as a proud parent with peace of mind that your Puggle product comes with a standard 12 months warranty

Your Puggle product is guaranteed for 12 months from the date of original purchase. If any defects should arise due to faulty workmanship or material, your faulty product should be returned to us and repair, replacement or refund will be at our discretion based upon thorough investigation from our QA team.

The guarantee is subject to the following provisions:

- The product must be assembled correctly and operated in accordance with the requirements contained within the instruction manual.
- The product must be solely used for domestic purposes.
- It does not cover general wear and tear, damage, misuse or any consumable parts.
- The warranty is rendered invalid if the product has been resold or has been damaged through inexpert repair.
- The warranty is only valid within the UK.

You do not need to validate your 12 month warranty, it will be effective as of initial purchase date.

For full terms and conditions please see online at, www.thenurserystore.com/warranty

PUGGLE

thenurserystore.com

Imported by Online4baby Ltd.

Meadowbank, Tweedale Way, Oldham, OL9 8EH