

i-Size Ultimate Safe Max 360° Rotate Car Seat
Instruction manual

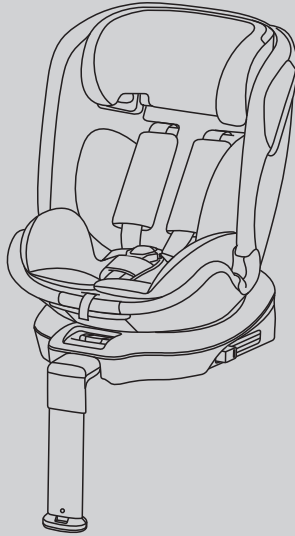

**IMPORTANT - RETAIN FOR FUTURE
REFERENCE, READ CAREFULLY.**

Warning: A child's safety is your responsibility.
This product is tested and approved to ECE R129/03

Suitable for children from height 40 to 135 cm
(approx birth to 12 years old).

1. Contents

1. Contents	02
2. Welcome	02
3. Safety Instructions	03-04
4. Installation Positions	05
5. Parts List	06
6. Adjusting the Car Seat	07
6.1. Using the buckle	07
6.2. Adjusting the harness	07
6.3. Adjusting the headrest	08
6.5. Rotating the seat	09
6.6. Adjusting the ISOFIX attachments	10
6.7. How to recline the seat	11
6.8. Removing parts as your child grows	12
6.9. Storing shoulder straps with chest pads and buckle	12
7. Installation	13
7.1. How to install rearward-facing, (40-105cm) approx. 0-4 years old	13
7.2. How to install forward-facing, (83-105cm) approx. 15 months -4 years old ...	14
7.3. How to install forward-facing, (105-135cm) approx. 4-12 years old	15
7.4. How to install forward-facing, (105-135cm) approx. 4-12 years old	16
7.5. Using and stowing the support leg	17
7.6. Technical parameters	18
8. Care and maintenance	18-19
8.1. Daily maintenance	18
8.2. How to remove and replace the fabric cover	18
8.3. Washing instructions	19

2. Welcome

Thank you for purchasing the Puggle i-Size Ultimate Safe Max 360° Rotate Car Seat. Please read the instructions and warnings carefully before use to ensure safe and satisfactory operation.

If you have a query with this product or require replacement parts, please contact Online4Baby online at online4baby.com/contact-us.

This product can be used rearward-facing with the 5-point safety system for children with a height of 40-105cm (Weight: <18kg, about 0-4 years old), using the ISOFIX+ Support leg to fix the child restraint system.

This product can be used forward-facing with the 5-point safety system for children with a height of 83-105cm (Weight: <18kg, about 15 months-4 years old), using the ISOFIX+ Support leg to fix the child restraint system.

This product can be used forward-facing for children with a height of 105-135cm (Weight: >15kg, about 4-12 years old), using the adult three-point belt to fix the child restraint system, or using ISOFIX and the adult three-point belt together to fix the child restraint system.

3. Safety instructions

IMPORTANT! PLEASE READ THE FOLLOWING INSTRUCTIONS CAREFULLY BEFORE INSTALLING THE PRODUCT.

Notice

i-Size ECRS (40-105cm) Notice:

This is an i-Size Enhanced Child Restraint System. It is approved according to UN Regulation No.129, for use in, i-Size compatible vehicle seating positions as indicated by vehicle manufacturers in the vehicle users' manual.

If in doubt, consult either the Enhanced Child Restraint System manufacturer or the retailer.

i-Size booster seats ECRS (105-135cm) Notice:

This is a i-Size booster seat Enhanced Child Restraint System. It is approved according to UN Regulation No.129, for use primarily in the "i-Size seating position" as indicated by vehicle manufacturers in the vehicle user's manual.

If in doubt, consult either the Enhanced Child Restraint System manufacturer or the retailer.

i-Size ECRS



Additional marking



- Please keep the instruction manual for future reference, a storage compartment for the instructions is located on the back of the child seat.
- When the child seat is inside the vehicle, it must always be fixed using ISOFIX anchorages even if not in use.
- Any straps holding the restraint to the vehicle should be tight.
- Any support-leg should be in contact with the vehicle floor.
- Any straps restraining the child should be adjusted to the child's body.
- Straps should not be twisted.
- The instructions must be retained on the device for the product life.
- The user should also refer to the vehicle manufacturer's handbook where necessary.

 IMPORTANT

DO NOT use forward facing before the child's age reaches 15 months.

 IMPORTANT

DO NOT use the device in seat positions where an active frontal airbag is installed.

3. Safety instructions

IMPORTANT! PLEASE READ THE FOLLOWING INSTRUCTIONS CAREFULLY BEFORE INSTALLING THE PRODUCT.

- **WARNING:** Please read these instructions carefully, as incorrect installation may result in serious injury. If any injuries should occur as a result of incorrect installation, the manufacturer will accept no responsibility.
- **WARNING:** This child safety seat is suitable for use from birth to approx. 12 years age / 40-135cm.
- **WARNING:** Do not use child restraint seat forward facing before the child's age exceeds 15 months.
- **WARNING:** The child must never be left unattended while seated in the safety seat.
- **WARNING:** Under no circumstances should the safety seat be installed in the front seat of the car opposite to the direction of travel if the car is equipped with an active airbag.
- **WARNING:** Ensure that the lap section of the harness is worn low down, so that the pelvis is firmly engaged.
- **WARNING:** The seat cover should not be replaced with any other than the one recommended by the manufacturer, because the cover constitutes an integral part of the restraint performance.
- **WARNING:** Never use the child safety seat without both the cover and pads provided.
- **WARNING:** Do not disassemble or modify this child safety seat or harness, as this may seriously compromise the function and safety of this product.
- **WARNING:** Child seats or accessories that are damaged or have been used incorrectly must be replaced.
- **WARNING:** Do not use any load bearing contact points other than those described in the instructions and marked in the child restraint.
- **WARNING:** Do not leave heavy objects unsecured inside the car, as these may injure the child in the event of an accident.
- **WARNING:** Ensure that no part of the child seat is caught in the door of the vehicle or in a reclining seat. In addition, ensure that the safety seat is correctly installed and secured.
WARNING: Protect the child safety seat from direct sunlight, as metal and plastic fittings could become hot and can be harmful to the child.
- **WARNING:** This safety seat is only intended for use in a vehicle.
- **WARNING:** You must replace the child restraint system if it is involved in an accident. It may have unseen damage and may not protect your child as well as it should.
- **WARNING:** You must replace the child restraint system and the safety belts if they become worn or damaged. It is not recommended to purchase or use second hand child restraint seats as there may be unseen damage and the product safety cannot be guaranteed. The manufacturer only guarantees this product with the original owner.

4. Installation Positions

4.1 INSTALLATION POSITION OF THE CHILD SEAT IN VEHICLE

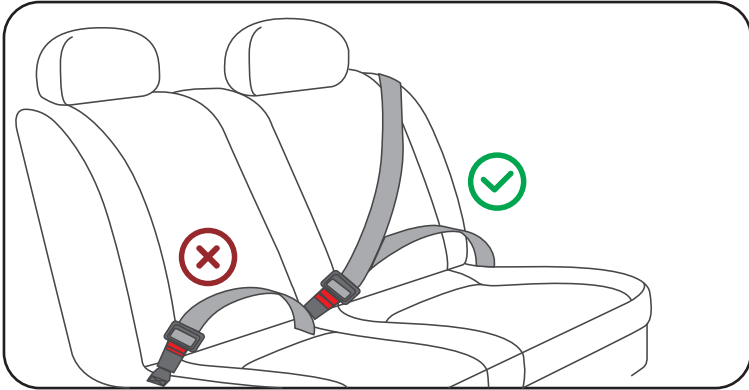

Only suitable if the approved vehicle is fitted with 3 point safety-belt, approved to UN/ECE Regulation No.16 or other equivalent standards.

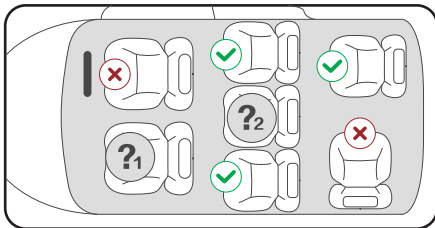

- ?₁** Do not use rearward-facing, in this seat position when an active frontal airbag is installed.
- ?₂** Only use on this seat if ISOFIX anchorages are fitted.



WARNING!

Refer to the vehicle's instruction manual to install the seat in the front seat.

5. Parts List

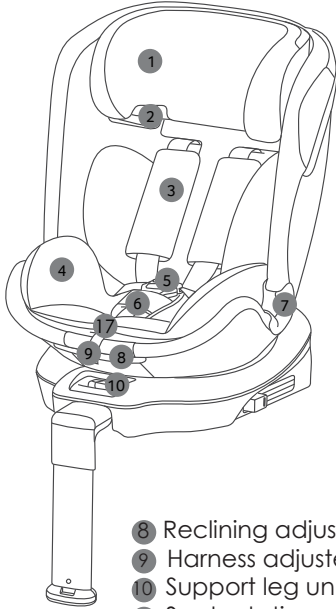

- ① Headrest
- ② Seatbelt guides
- ③ Shoulder pads
- ④ Infant cushion
- ⑤ Buckle
- ⑥ Crotch pad
- ⑦ Seatbelt guides

- ⑧ Reclining adjuster
- ⑨ Harness adjuster strap
- ⑩ Support leg unlock button
- ⑪ Seat rotation adjuster
- ⑫ Base
- ⑬ Headrest adjuster
- ⑭ ISOFIX attachment
- ⑮ ISOFIX release button
- ⑯ Support leg
- ⑰ Harness adjuster button

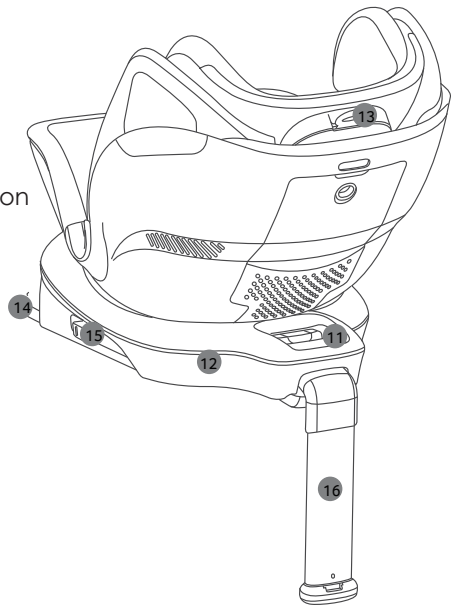

Instruction illustrations are for informational purposes only. The child restraint system may contain small differences compared to the photographs or diagrams in the instruction manual.

6. Adjusting the Car Seat

6.1. USING THE BUCKLE

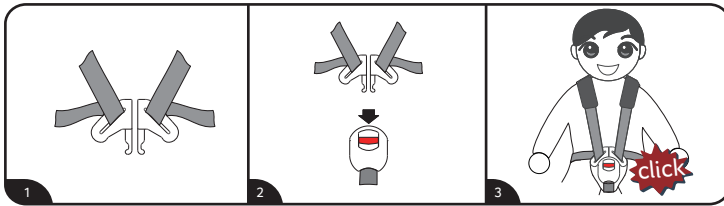

buckle diagram

Step 1: Bring the left and the right pieces of the buckle together.

Step 2: Insert these two pieces into the slot of the buckle, when you hear a "click" the buckle is engaged. Pull the buckle to check it is locked correctly.

Step 3: To release the safety belts, press the red button and the buckle pieces will pop out.

6.2. ADJUSTING THE HARNESS

Picture 1: Tightening the harness.

Pull the shoulder straps upwards to remove the slack from the lap sections of the harness, then pull the front stretch belt until the harness is fully tightened. The harness should be adjusted as tightly as possible without causing discomfort to your child. A loose harness can be dangerous.

Check the harness adjuster and tighten each time the child is placed in the seat.

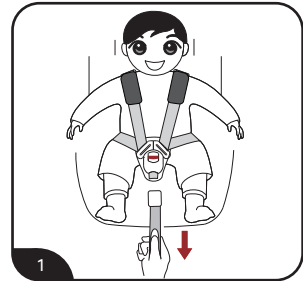

Picture 1

Picture 2: Loosen the harness.

The harness can be loosened by pressing the adjuster found under the seat cover, on the front of the seat. Press down the adjuster as you grip the two shoulder straps with your other hand. As you pull the shoulder straps towards you, the harness will loosen.

WARNING! Do not add additional items such as blankets or padded clothing. Bulky items can lead to incorrect harness tightening. In an accident the child can slip out of the restraint if not properly tightened.

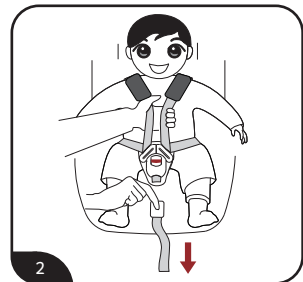

Picture 2

6. Adjusting the Car Seat

6.3 ADJUSTING THE HEADREST

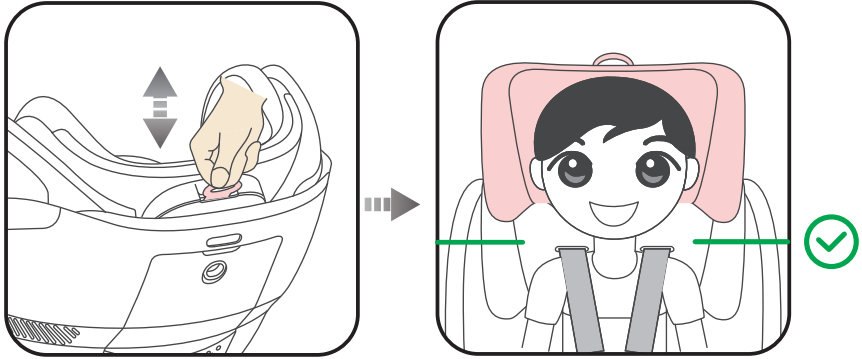

Picture 1

Picture 1: pull the ring to adjust the headrest up and down, then release when in the correct position. The headrest has 7 positions which can be adjusted up or down according to the child's height.

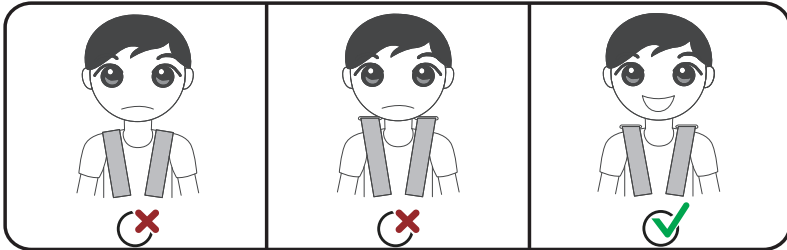

Picture 2

Picture 2: Checking the shoulder strap height

Always check that the shoulder straps are at the correct height for your child.

IMPORTANT:

A correctly adjusted headrest ensures optimal protection for your child in the safety seat.

6. Adjusting the Car Seat

6.5. ROTATING THE SEAT

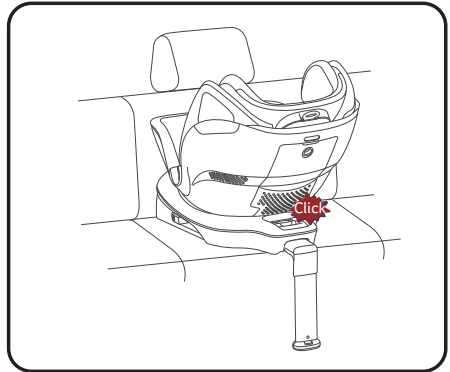
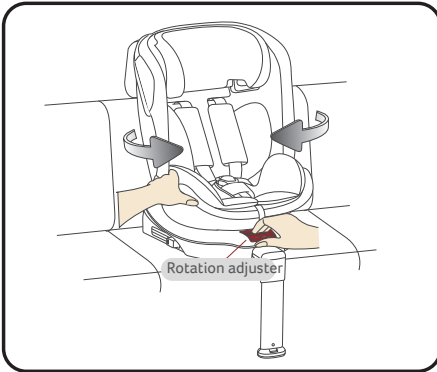

First, pull out the rotation adjuster with one hand and rotate the safety seat with the other hand, both left and right directions can be rotated.

When you hear a "click" sound, the seat is locked in place.



When the child's height is 40-83cm, the safety seat should rearward-facing.
When the child's height is 83-105cm, the safety seat can forward-facing or rearward-facing.
When the child's height is 105-135cm, the safety seat should forward-facing.

WARNING: Only have the seat in the sideways-facing position when putting the child in or out of the seat

6. Adjusting the Car Seat

6.6. ADJUSTING THE ISOFIX ATTACHMENTS

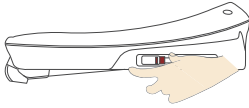

- The ISOFIX attachments can be adjusted into many positions to fit the ISOFIX low anchorage points in different cars. First press the release buttons on both sides, then pull out the ISOFIX attachment arms to the longest position.
- Then put the ISOFIX attachment arms into the guide sleeves, and insert them into the vehicle's ISOFIX anchorage points. Make sure that you have heard a "click" and the ISOFIX latching indicator shows GREEN.
- After the ISOFIX attachment arms are locked onto the car anchorage points, push the child restraint forwards until it is tight against the car seat. Now, the ISOFIX base is installed in place.
- If you want to release the ISOFIX attachments, push the red release button as shown in the drawing.

6. Adjusting the Car Seat

6.7 HOW TO RECLINE THE SEAT

Pull out the seat recline adjuster, while tilting the seat forwards or backwards to adjust the angle of the seat.

The car seat can recline into 4 different positions, as shown in the pictures.

This is true for forward and rearward facing.

Rearward facing :

Child's height 40-105 CM: ①②③④

Forward facing:

Child's height 83-105 CM: ①②③④

Child's height 105-135 CM: ①

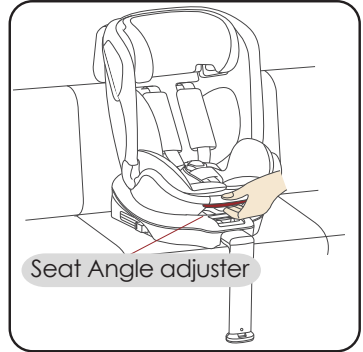

REARWARD-FACING

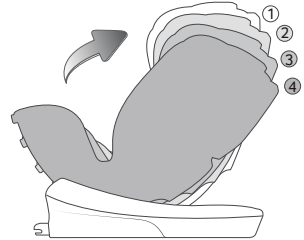

- Upright - 1st position
- Recline - 2nd position
- Recline - 3rd position
- Recline - 4th position

FORWARD-FACING

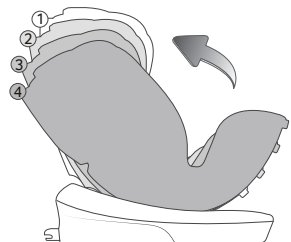

- Upright - 1st position
- Recline - 2nd position
- Recline - 3rd position
- Recline - 4th position

6. Adjusting the Car Seat

6.8 REMOVING PARTS AS YOUR CHILD GROWS

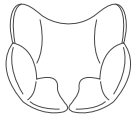

cushion

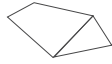

triangle sponge

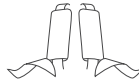

shoulder pads and
the shoulder straps



crotch pad



buckle

When the child grows to more than 60cm in height remove these items.

When the child is 105-135cm tall, the above items need to be stored (see 6.9).

6.9 STORING SHOULDER STRAPS WITH CHEST PADS AND BUCKLE

Step 1: You can store the shoulder straps with shoulder pads in place on both sides of the seat. First open the fabric cover on the seat back, by releasing the poppers, then release the buckle;

Step 2: Tighten the harness adjuster, so the strap with relevant buckle connector sits flat and then close up the fabric cover using the poppers;

Step 3: Lift up the fabric cover on the seat, and put the central buckle component and crotch pad into the storage slot.

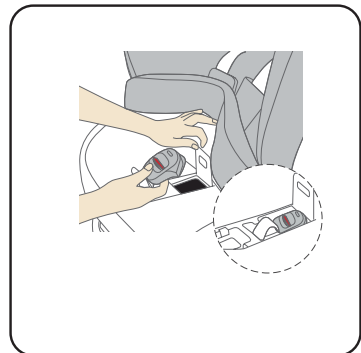
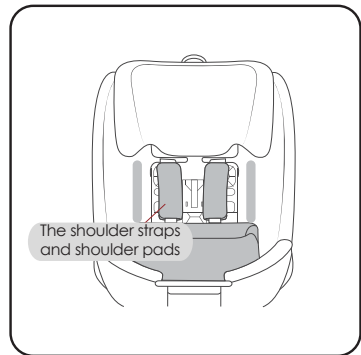

7. Installation

7.1 How to install rearward-facing

Child's height: 40-105cm

Child's weight: <18KG, about birth-4 years old

Must use: ISOFIX+Support leg

 DO NOT use forward facing before the child reaches 15 months old.

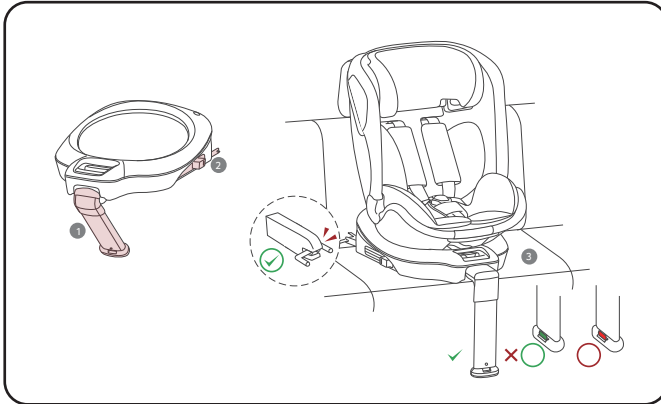

- 1 First, pull out the support leg of the base (see 7.5);
- 2 Second, pull out the ISOFIX attachment (see 6.6);
- 3 Third, place the child safety seat on the car seat; Then fix the ISOFIX attachment to vehicle ISOFIX anchorage points (see 6.6) and adjust the support leg (see 7.5)

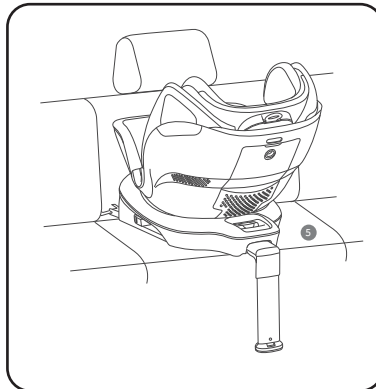

- 4 Rotate the seat until it faces the car door, then put the child in the safety seat, adjust the shoulder straps and lock the buckle (see 6.1,6.2,6.3);
- 5 Finally, fix the seat in the rearward position.

7. Installation

7.2 How to install forward-facing

Child's height: 83-105cm

Child's weight: <18kg, about 15
months-4 years old

Must use: ISOFIX+Support leg

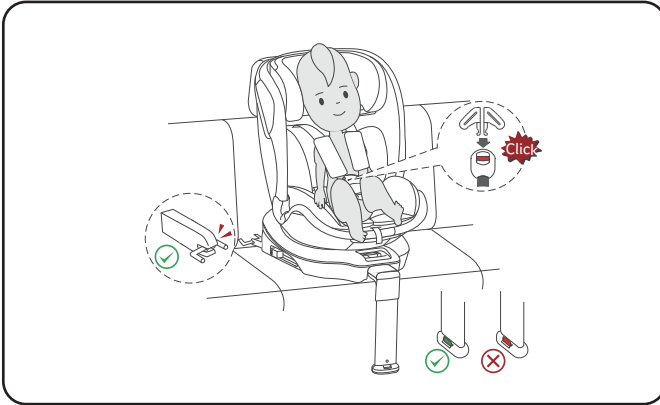

- 1 First, pull out the support leg of the base (see 7.5);
- 2 Second, pull out the ISOFIX attachment (see 6.6);
- 3 Third, place the child safety seat on the car seat;
Then fix the ISOFIX attachment to vehicle ISOFIX anchorage
points (see 6.6) and adjust the support leg (see 7.5)
- 4 Finally, put the child in the safety seat, adjust the
shoulder straps and lock the buckle (see 6.1,6.2,6.3).



When the child is taller than 60cm you
must remove these items.

7. Installation

7.3 How to install forward-facing

Child's height: 105-135cm

Child's weight: >15kg, about 4-12 years old

Usage①: Fixed with ISOFIX + adult three-point seat belt.

- 1 Put away the support leg (see 7.5)
- 2 Pull out the ISOFIX attachment and fix to vehicle ISOFIX anchorage points (see 6.6)
- 3 Place the child on the child restraint system. Adjust the headrest height to ensure that the headrest is at the child's shoulder height and fixed well.

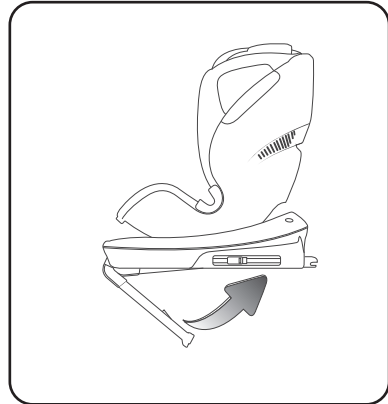

When the child is 105-135cm tall, the above items need to be stored (see 6.8, 6.9).

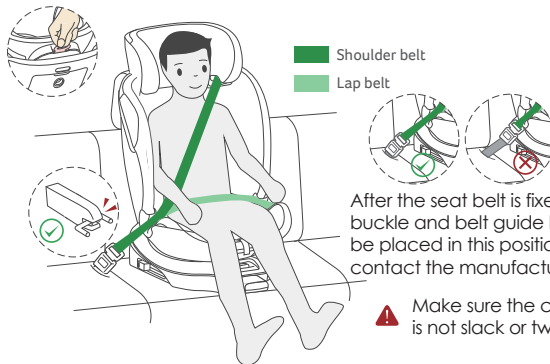

After the seat belt is fixed, the seat buckle and belt guide hook should not be placed in this position. Please contact the manufacturer if in doubt.

⚠ Make sure the car seat belt is not slack or twisted.

- 4 Ensure the adult 3-point seat belt follows the correct path. First place the car seat belt across the child's body running in the groove of the car seat and locking the belt into the buckle; then make sure the car seat shoulder belt passes through the guide groove on the headrest. Finally pull up the car seat lap belt to check that it is locked.

7. Installation

7.4 How to install forward-facing

Child's height: 105-135cm

Child's weight: >15kg, about 4-12 years old

Usage②: Fixed with adult three-point seat belt (without using ISOFIX).

- 1 Put away the support leg (see 7.5)



When the child is 105-135cm tall, the above items need to be stored (see 6.8,6.9).

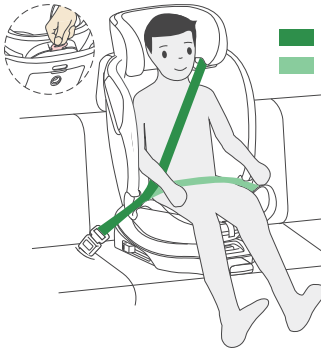
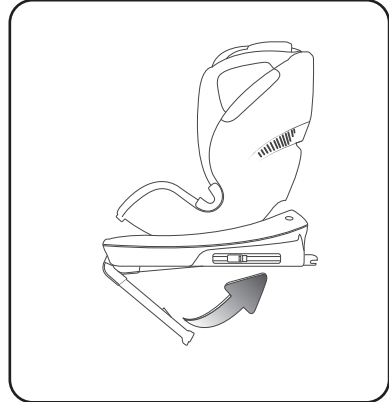

■ Shoulder belt
■ Lap belt

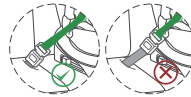

After the seat belt is fixed, the seat buckle and belt guide hook should not be placed in this position. Please contact the manufacturer if in doubt.

▲ Make sure the car seat belt is not slack or twisted.

- 2 First place the child on the child restraint system. Adjust the headrest height to ensure that it is at the child's shoulder height and fixed well.
- 3 Ensure the adult 3-point seat belt follows the correct path. First place the car seat belt across the child's body running in the groove of the car seat and locking the belt into the buckle; then make sure the car seat shoulder belt passes through the guide groove on the headrest. Finally pull up the car seat lap belt to check that it is locked.

7. Installation

7.5 USING THE SUPPORT LEG

When the child's height is 40-105cm, the support leg must be used

- 1 First rotate out the support leg, from the base.

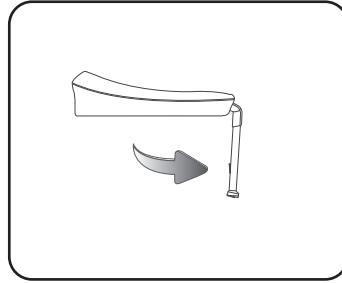

- 2 Press and hold the support leg lock button, whilst pulling it out to the correct position.

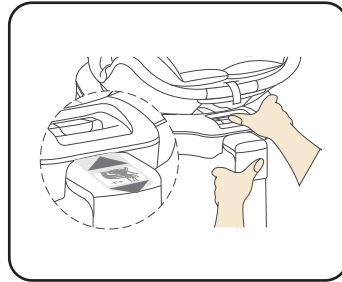

- 3 To adjust the support leg to the correct length, first press and hold the adjustment button on the support leg. Next pull the leg up or down until it hits the car floor. The bottom of the support leg will turn green when it is in the correct position.

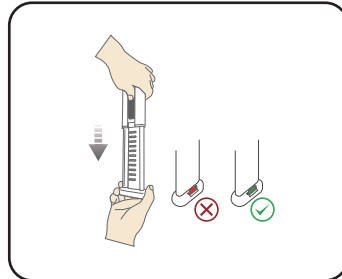

STOWING THE SUPPORT LEG

When the child's height is 105-135cm, the support leg is in the stowed state.

If you want to put away the support leg, just reverse the above operation 3 2 1.

7. Installation

7.6 TECHNICAL PARAMETERS

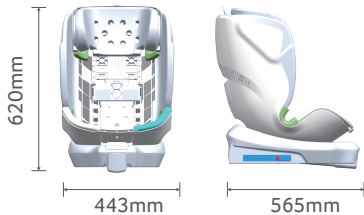

- Distance from front to back of the seat: 565mm
- Distance from left to right of the seat: 443mm
- Height of the seat: 620mm
- Weight of the seat: 11 ±0.5kg

8. Care and Maintenance

8.1. DAILY MAINTENANCE

- In daily use, periodically check the child seat for faults. The child seat should be replaced after an accident.
- Please store this child seat in a dry and ventilated place to avoid dampness and mould.
- If the child seat becomes dirty, clean the seat harness and the plastic parts by wiping them with a damp sponge and allow to dry naturally.
- If food or drink is accidentally spilt on the buckle, remove it from the child seat for cleaning. First lift up the fabric cover in the seat area and push it through the hole in the fabric cover, then feed the buckle webbing through the gap in the metal bracket to remove and rinse it gently in warm water, leave it to dry naturally. It is vital for the safety of the child that the harness buckle works correctly. Malfunctions of the harness buckle are usually caused by accumulations of dirt or foreign bodies.
- To clean the entire fabric cover, please refer to 8.2 and 8.3 for removal of the cover and washing instructions.

8. Care and Maintenance

8.2. HOW TO REMOVE AND REPLACE THE FABRIC COVER

- First, remove the crotch pad and push the buckle of the child seat through the hole in the fabric cover.
- Pull open the poppers on the cover, then remove the cover.
- To replace the fabric cover of the child seat , repeat the above procedures in reverse order.

8.3. WASHING INSTRUCTIONS FOR FABRIC COVER

Never use any solvent, chemical detergent or lubricant on any part of your child seat.



Hand wash, water
temperature
below 30°C



Do not bleach



Dryclean, any
solvent except
trichloroethylene.





Do not
tumble dry



Do not iron



If you have any questions or concerns regarding this product,
do not hesitate to contact our expert team online
via online4baby.com/contact-us

Feeling social?  
online4baby.com

Imported by Online4baby Ltd,
Meadowbank, Tweedale Way, Oldham, OL9 8EH, UK