

Maxi Gro Comfort Plus 9-36kg Eco Car Seat

Instruction manual

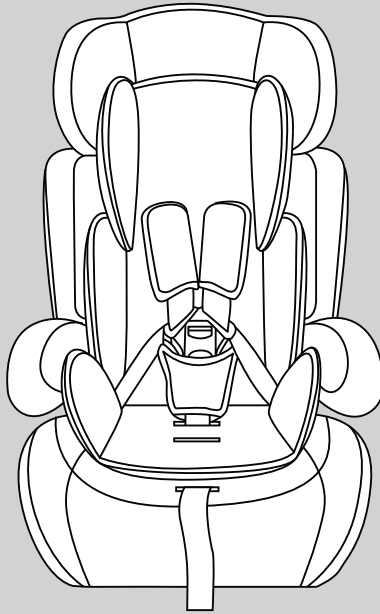

**IMPORTANT - RETAIN FOR FUTURE
REFERENCE, READ CAREFULLY.**

Warning: A child's safety is your responsibility.

This product is tested and approved to ECE R44/04

1. Contents

1. Contents	02
2. Welcome	02
3. Safety instructions	03-04
4. Installation positions	05
5. Parts List	06
6. Adjusting the car seat	07
6.1. Adjusting the buckle	07
6.2. Adjusting the harness.....	07
6.3. Adjusting the headrest	08
6.4. Removing and installing the 5-point harness.....	08-09
7. Installation	10
7.1. Group 1 (9-18kg) with a 3-point vehicle seat belt.....	10-11
7.2. Group 2/3 (15-36kg) with a 3-point vehicle seat belt.....	11-12
7.3. Group 2/3 (15-36kg) without the backrest.....	13
8. Care and maintenance	14

2 .Welcome

Thank you for purchasing the Puggle Maxi Gro Comfort Plus 9-36kg Eco Car Seat.

Please read the instructions and warnings carefully before use to ensure safe and satisfactory operation of your Maxi Gro Comfort Plus 9-36kg Eco Car Seat.

If you have a query with this product or require replacement parts, please contact Online4Baby online at online4baby.com/contact-us.

3. Safety instructions

Notice

This is a "Universal" car seat, and is approved to ECE Regulation R44, for general use in motor vehicles. A correct fit is likely if the vehicle manufacturer has declared in the vehicle hand book that the vehicle is suitable to accept a "Universal" child restraint for this age group and weight.

This car seat has been declared as "Universal" under more stringent test conditions than those applied to earlier designs which do not carry this notice.

If in doubt, please contact your retailer or the manufacturer.

This car seat can only be used if your vehicle is fitted with a 3-point vehicle seat belt approved to UN/ECE Regulation No. 16 or other equivalent standards.

IMPORTANT! READ CAREFULLY BEFORE USE AND KEEP FOR FUTURE REFERENCE.

Read this user manual BEFORE installing your car seat. Incorrect installation could endanger your child. Please always keep the instruction manual with the car seat for future reference.

- **WARNING:** NO child restraint can guarantee full protection from injury in an accident. However, proper use of a child restraint will reduce the risk of serious injury or death to your child.
- **WARNING:** Assembly and installation operations must be carried out by adults.
- **WARNING:** For the correct usage of the airbag in combination with the seat; read the vehicle handbook.
- **WARNING:** DO NOT allow child restraint straps to become twisted, keep them flat.
- **WARNING:** DO NOT install or use this car seat without following the instructions in this manual or you may put your child at serious risk of injury or death.
- **WARNING:** DO NOT make any modifications to this car seat or use it along with component parts from other manufacturers.
- **WARNING:** When using this child restraint system, the belt must be used correctly; make sure that the lap belt is not above the child's belly.
- **WARNING:** DO NOT leave this car seat unsecured in your vehicle because an unsecured car seat can be thrown around and may injure occupants in a sharp turn, sudden stop, or collision. Remove it if not in regular use.
- **WARNING:** DO NOT use this child restraint without the seat cover.
- **WARNING:** The seat cover should not be replaced with any seat cover besides the ones recommended by the manufacturer. The seat cover constitute an integral part of the child restraint performance.
- **WARNING:** DO NOT put anything other than the recommended seat cover in this child restraint.
- **WARNING:** DO NOT allow the car restraint harness or belt guide to become trapped or caught in the vehicle seat or door.

3. Safety instructions

- **WARNING:** NEVER leave your child unattended with a child restraint.
- **WARNING:** NEVER use a second-hand car seat or a car seat whose history you do not know because they may have structural damage that endangers your child's safety.
- **WARNING:** Please keep this child restraint away from sunlight, otherwise it may be too hot for the child's skin.
- **WARNING:** DO NOT place other items on top of the car seat if it is in the car boot to prevent damage.
- **WARNING:** DO NOT continue to use this car seat after it has suffered any violent crash. Replace immediately as there may be invisible structural damage from the crash.
- **WARNING:** Remove this car seat from the vehicle seat when it is not in use.
- **WARNING:** To avoid suffocation, remove plastic bag and packaging materials before using this product.
- **WARNING:** The plastic bag and packaging materials should then be kept away from babies and children.
- **WARNING:** Consult the retailer for issues concerning maintenance repair and part replacement.
- **WARNING:** DO NOT install this car seat under the following conditions: vehicle seats facing sideways or rearward with respect to the running direction of the vehicle. Vehicle seats movable during installation.
- **WARNING:** In case of emergency or accidents, it is most important to have your child taken care of with first aid and medical treatment immediately.

The Puggle Maxi Gro Comfort Plus 9-36kg Eco Car Seat is suitable for:

Group	Weight	Approx. Age	Child Restraint Direction	Fittings Methods
I	9-18 kg	9 mths - 4 yrs	Forward-facing	3-point seat belt
II	15-25 kg	3 to 7 yrs		
III	22-36 kg	6 to 12 yrs		

4. Installation Positions

In the vehicle rear seats. ✓

This child safety seat may only be installed in front seats in the following circumstances:

1. If the vehicle is not equipped with rear seats.
2. If all rear seats are already occupied by children exceeding 135cm in height.
3. If it is not possible to install all child restraint systems in the rear seats.

Notice

- **If your center rear passenger seat is only fitted with a 2-point lap belt the child safety seat must not be used. It is only suitable with a 3-point safety belt.** ?1

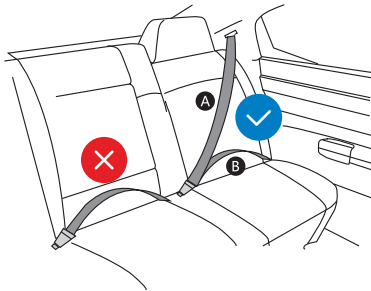

- ✓ 3-point belt
- ✗ 2-point belt
- A Diagonal belt
- B Lap belt

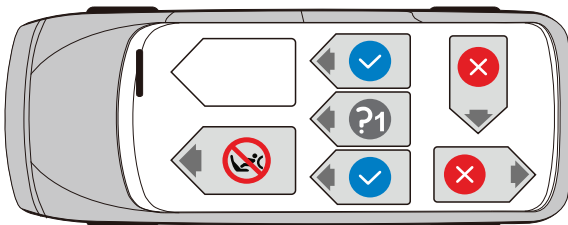

⚠ WARNING!
Refer to the vehicle's instruction manual to install the seat in the front seat.

5. Parts List

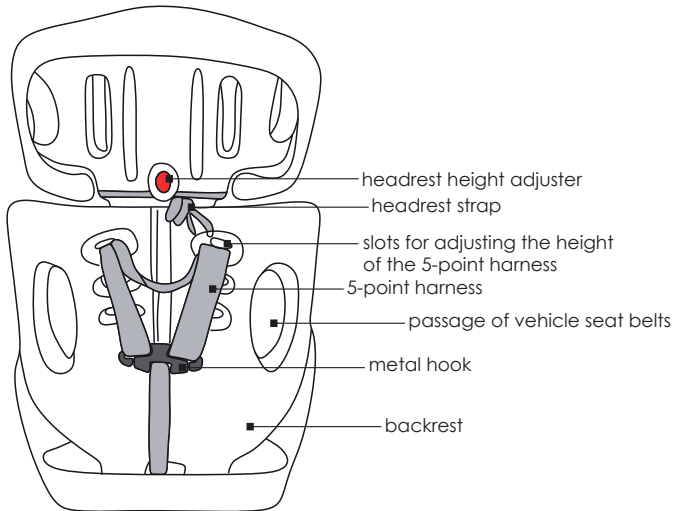
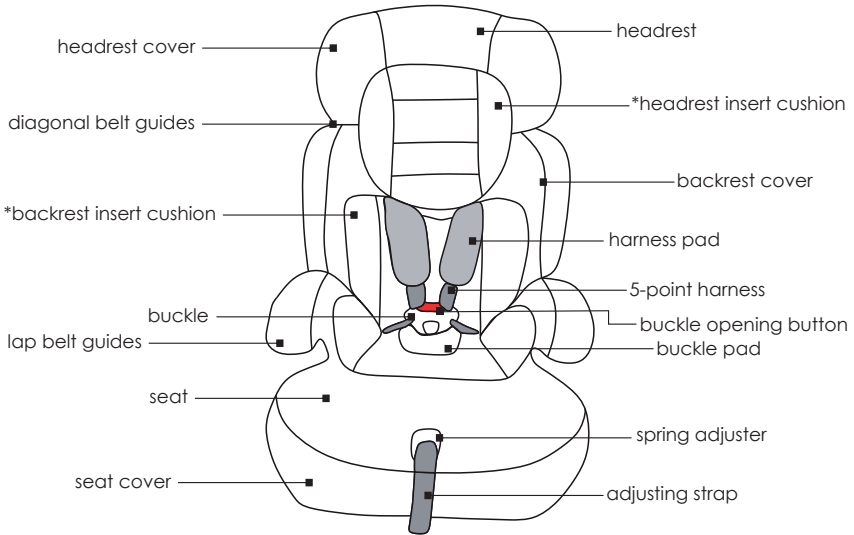

*not included with all models

6. Adjusting the Car Seat

6.1. ADJUSTING BUCKLE

Open buckle:

Press red button until buckle latches are released from the buckle (fig. 1)

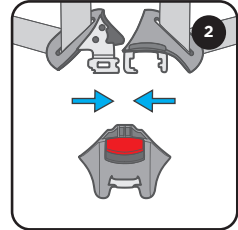
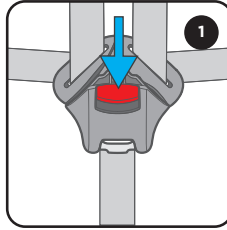

Lock buckle:

Guide the two buckle latches together (fig. 2), putting them into the harness buckle house (fig. 3). A "click" will signal when locked.

Note. The buckle will not lock with one latch only.

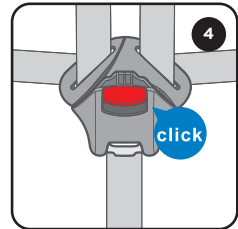
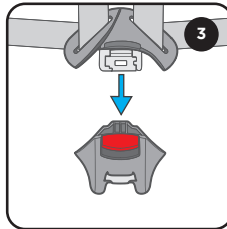

6.2. ADJUSTING HARNESS

Tighten harness:

Pull the adjuster strap until the harness lies flat and close against your child's body (fig. 5).

Note. The harness should allow 1 finger width, approx. 1cm at the top of the shoulders for ideal fit.



WARNING!

Do not add additional items such as blankets or padded clothing.

Bulky items can lead to incorrect harness tightening.

In an accident the child can slip out of the restraint if not properly tightened.

Loosen harness:

Press the centre adjuster and at the same time pull both shoulder belts forwards (fig. 6)

DO NOT pull on the shoulder pads.

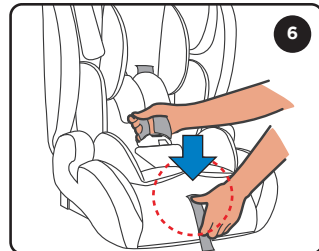
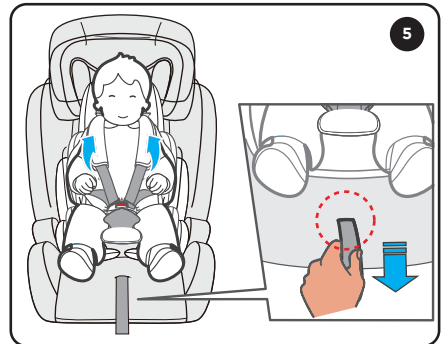

6. Adjusting the Car Seat

6.3. ADJUSTING HEADREST

1. Loosen the harness (see section 6.2.)
2. Adjust the headrest to the correct height by pushing the height adjuster and lift or push the headrest to the desired position (fig. 7).

3. The headrest must be adjusted so that there is a space two fingers wide between the headrest and your child's shoulders (fig. 8).

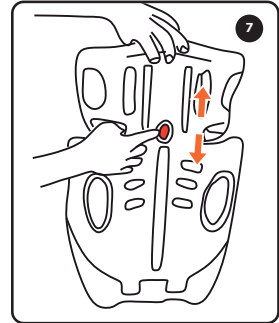

IMPORTANT

A correctly adjusted headrest ensures optimal protection for your child in the safety seat.

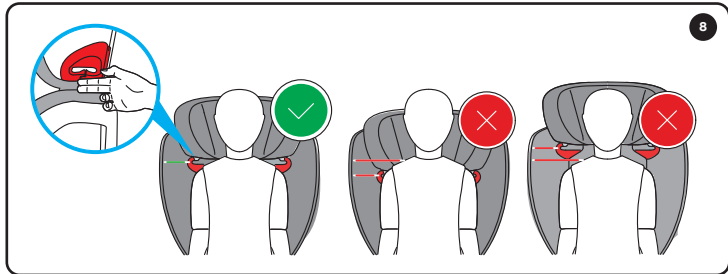

6.4. REMOVE AND INSTALL HARNESS

1. Unhook the shoulder belts from the metal hook on the back side of the child seat (fig. 9).

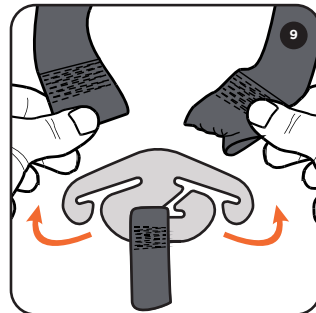

6. Adjusting the Car Seat

6.4. REMOVE AND INSTALL HARNESS

2. Pull out the shoulder straps from the back of the child seat (fig. 10).

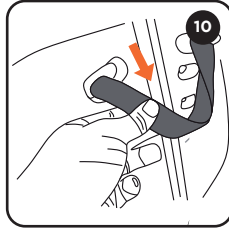

3. Remove the shoulder pads out through the backrest (fig. 11).

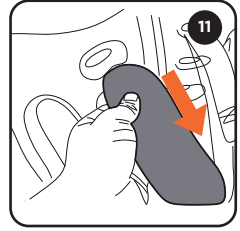

4. Press the red button on the buckle to open it (fig. 12).

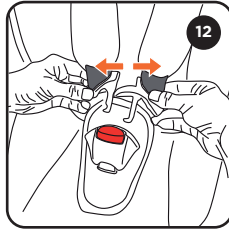

5. Lift the cover of the seat and remove the harness completely (fig. 13).

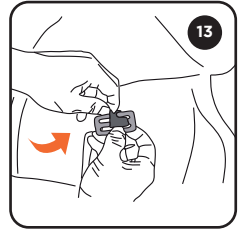

6. Pass the metal clip of the buckle through the slot in the seat and remove the buckle from the child seat (fig. 14).

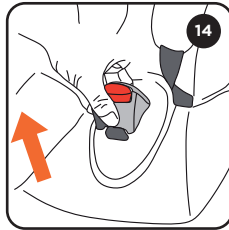

7. Remove the metal hook from the strap (fig. 15).

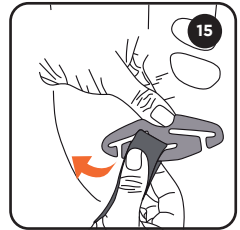

8. Remove the adjuster strap (fig. 16).

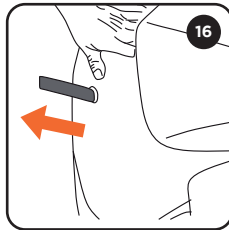

9. To re-fit the harness:
Simply follow the steps in the opposite order. Make sure the belt is not twisted.

7. Installation

7.1. GROUP 1 (9-18kg) 3-POINT VEHICLE SEAT BELT

1. Place the child seat on the vehicle seat so that it rests fully on the seat and against the backrest without leaving any space (fig. 17).

Note. Do not place the child seat on a vehicle seat that is reclined.

2. Open buckle and remove the infant cushion (fig. 18).

Note. the infant cushion is not included with all models.

3. Pull out the vehicle seat belt and insert the diagonal belt through the diagonal belt guide (fig. 19).

Thread the diagonal belt under the seat covers and over the arm rest (lap belt guide) (fig. 20).

4. Position the lap belt under the arm rest (lap belt guide) and engage the buckle tongue in the vehicle seat belt buckle (fig. 21/ 22).

5. Guide the vehicle lap belt through the base belt guide (under the fabric flap) (fig. 23).

6. Pull on the diagonal belt to tighten the vehicle belts and replace the infant cushion (fig. 24).

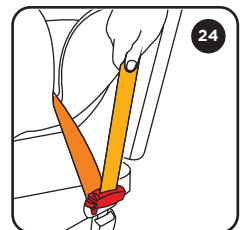
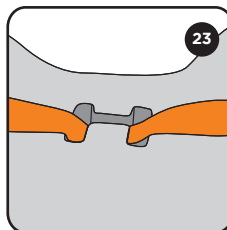
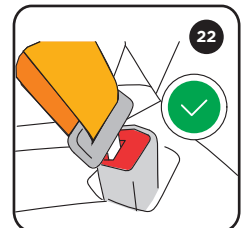
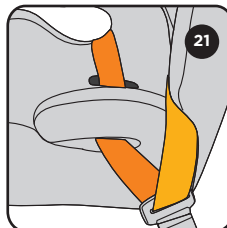
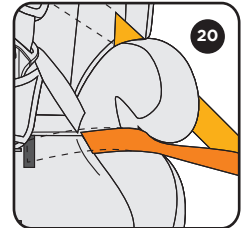
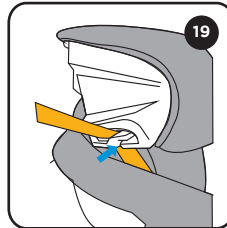
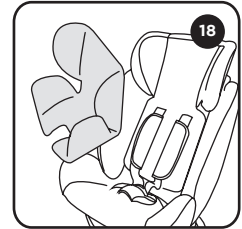
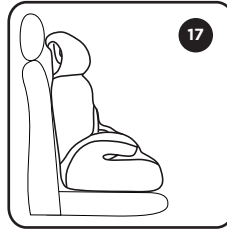

CAUTION!

Make sure belt is not twisted and buckle is engaged.

7. Installation

7.1. GROUP 1 (9-18kg) 3-POINT VEHICLE SEAT BELT

7. Shake the child safety seat to make sure it is firmly installed in the vehicle (fig. 25).

8. Have your child sit down in the child seat. Adjust the headrest to required height (see section 6.3), adjust the harness and lock buckle (see section 6.1), and tighten harness (see section 6.2).



7.2. GROUP 2/3 (15-36kg) 3-POINT VEHICLE SEAT BELT

1. Remove the harness when using for Group 2/3 (see section 6.4).

2. Place the child seat on the vehicle seat so that it rests fully on the seat and against the backrest without leaving any space (fig. 26).

Note. Do not place the child seat on a vehicle seat that is reclined.

2. Open buckle (fig. 27) (see section 6.1).

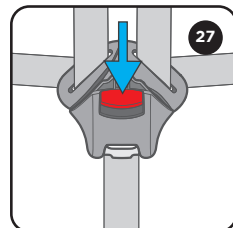
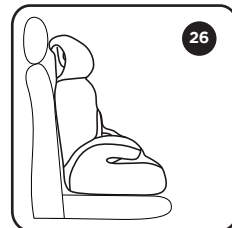

7. Installation

7.2. GROUP 2/3 (15-36kg) 3-POINT VEHICLE SEAT BELT

3. Sit your child in the child seat.
Adjust headrest to required height
(see section 6.3).

4. Pull out the vehicle seat belt and
guide it in front of your child to the
vehicle seat buckle.
Engage the buckle tongue into the
vehicle seat buckle (fig. 28).

5. Place the diagonal belt section
over the arm rest (lap belt guide)
(fig. 29).

5. Place both lap belt sections
under the arm rests (lap belt guide)
(fig. 30).

CAUTION!

The lap belt section must lie as low
as possible over the child's hips on
both sides.

7. Guide the diagonal seat belt section
into the shoulder belt guide and
ensure it is not twisted (fig. 31).

CAUTION!

Make sure belt is not twisted
and buckle is engaged (fig. 32).

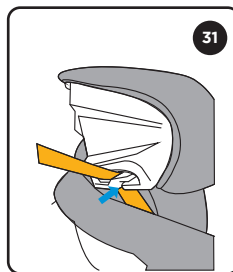
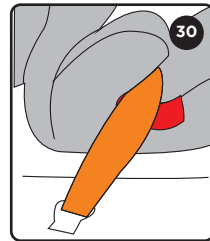
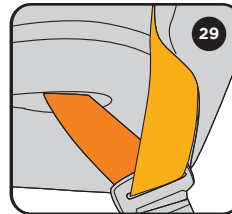
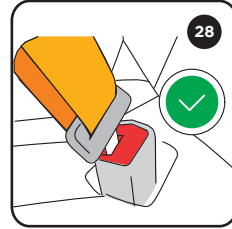

7. Installation

7.3. GROUP 2/3 (15-36kg) 3-POINT VEHICLE SEAT BELT WITHOUT THE BACKREST

1. Hold the seat base with one hand and push against the seat backrest with the other hand until the backrest detaches from the base (fig. 34/ 35).

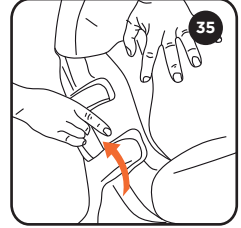
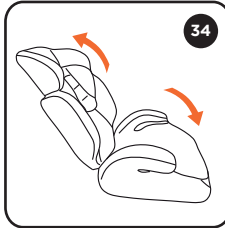

2. Sit your child in the booster seat.
Note. the booster seat must be placed as close as possible to the vehicle seat backrest, to allow the most comfortable position for the child.

3. Pull out the vehicle seat belt and guide it in front of your child to the vehicle seat buckle. Engage the buckle tongue into the vehicle seat buckle (fig. 36).

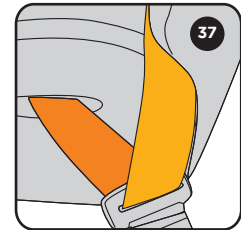
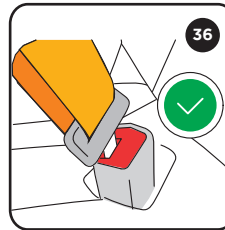

4. Place the diagonal belt section over the arm rest (lap belt guide) (fig. 37).

5. Place both lap belt sections under the arm rests (lap belt guide) (fig. 38).



CAUTION!

The lap belt section must lie as low as possible over the child's hips on both sides and the diagonal belt section must be positioned over the center of the child's shoulder.

8. Care and Maintenance

8.1. MAINTENANCE

It is important to only use the original upholstery as this is an essential part of the functionality.

Please remove the booster seat from the vehicle seat if not in use.

Put the booster seat in a cool, dry place where your child cannot access it.

8.2. CLEANING

DO NOT wash fabrics. Spot clean only using a soft sponge with diluted detergent or water. Dry in shade and not in the sun. Do not iron. Do not dry clean. Wipe metals and plastic parts with a mild detergent and lukewarm water. DO NOT use chemical cleaners or bleaches (ammonia, petrol, solvents etc.) under any circumstances.



If you have any questions or concerns regarding this product,
do not hesitate to contact our expert team online
via online4baby.com/contact-us

Feeling social?  
online4baby.com

Imported by Online4baby Ltd,
Meadowbank, Tweedale Way, Oldham, OL9 8EH, UK