

PUGGLE

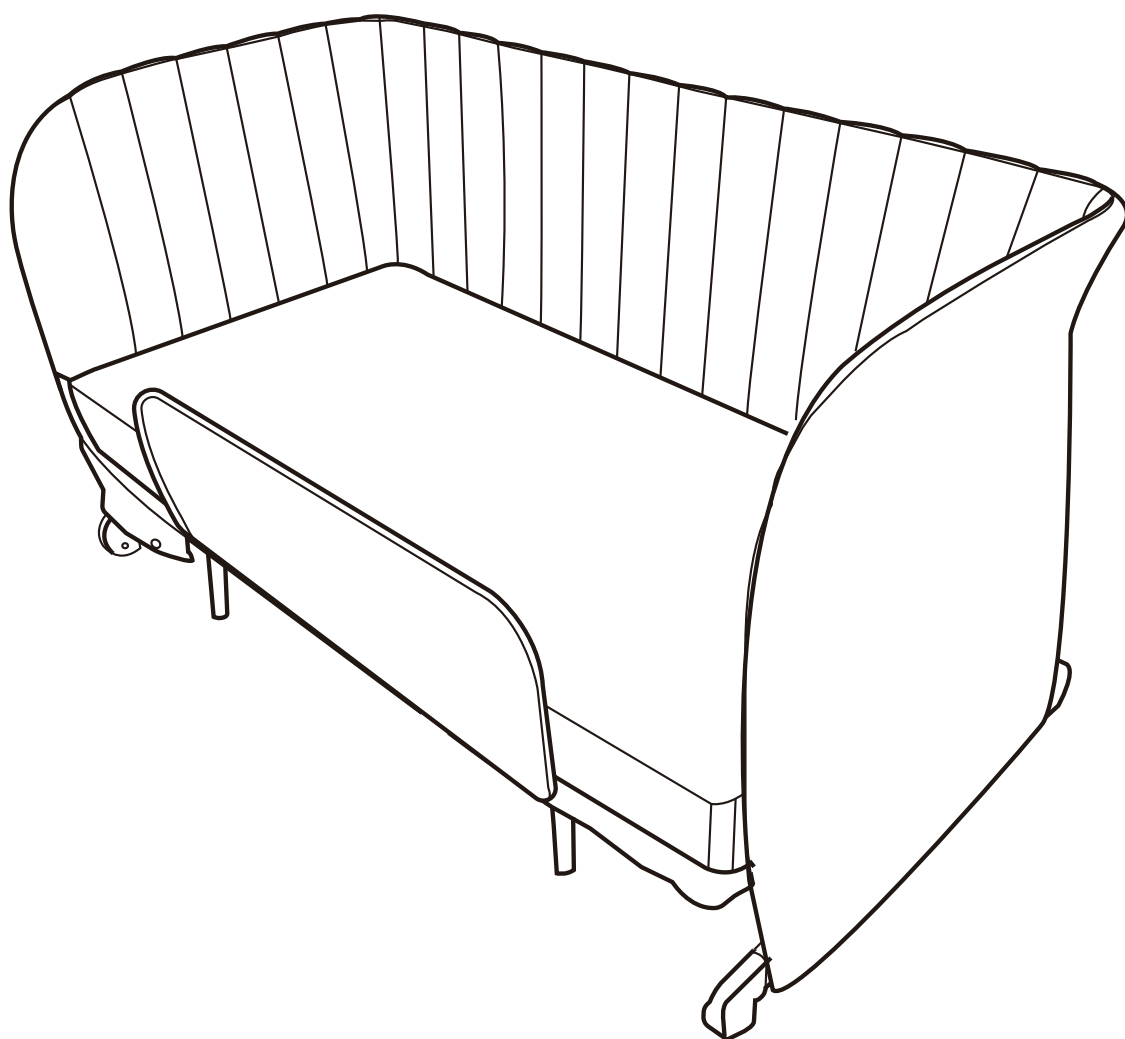

Puggle 4 in 1 Dreamy Sleeper Bedside Crib & Toddler Bed
Instruction Manual

IMPORTANT! READ CAREFULLY AND KEEP FOR FUTURE REFERENCE

Thank you for purchasing the **Puggle 4 in 1 Dreamy Sleeper Bedside Crib & Toddler Bed**.

This instruction manual will guide you through the setup, use, and maintenance of your new product, ensuring you get the most out of its versatile features. Please read through the following information and safety warnings carefully to fully understand and enjoy all the benefits your **Puggle 4 in 1 Dreamy Sleeper Bedside Crib & Toddler Bed** has to offer, and to ensure its safe operation.

We're here to help!

If you have a query with this product or require replacement parts, please contact us at:
support@pugglebaby.co.uk

Important Information

Important Information

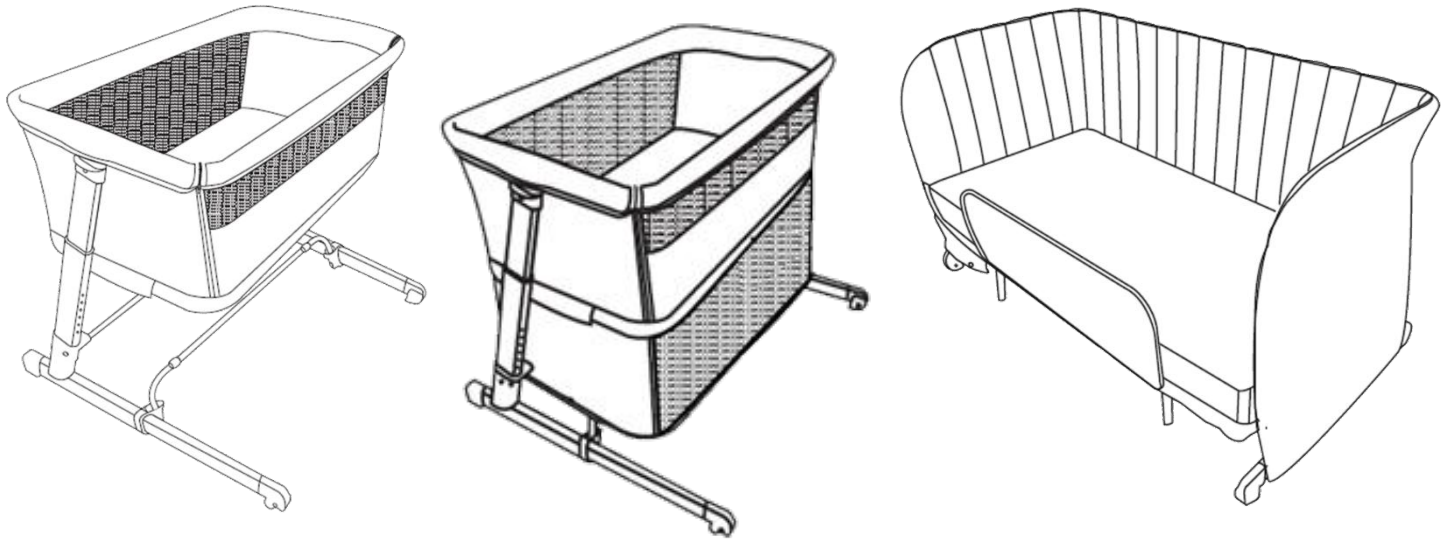

IMPORTANT! Your Dreamy Sleeper Crib and Toddler Bed may differ slightly from images shown above and throughout, as the images used are for illustration purposes only.

Your Dreamy Sleeper Crib and Toddler Bed is tested to comply with EN 1130:2019, EN 12227:2010 and BS 8509:2008+A1:2011.

- DO NOT use parts or accessories which are not approved or supplied by the manufacturer.
- DO NOT allow your child to play with this product without adult supervision.

Safety Instructions

IMPORTANT – Read the instructions carefully before use and keep for future reference.

- **WARNING:** A child's safety is your responsibility, never leave the child unattended.
- **WARNING:** Before use, remove and dispose of all plastic bags and packaging materials and keep them out of reach of children.
- **WARNING:** Adult assembly is required.
- **WARNING:** Before assembly, check that the product and all of its components have not been damaged during transportation. Should any part be damaged, do not use and keep out of reach of children.
- **WARNING:** DO NOT allow other children to play unattended near the crib.
- **WARNING:** This product is suitable for use by one child at a time only.

Warnings

- **WARNING:** “Crib Mode” is intended for use for babies from birth upto 6 months, a maximum weight of 9kg.
- **WARNING:** “Crib Mode” is not intended for children who are able to sit up unaided, pull itself up or push on its hands and knees.
- **WARNING:** When a child is able to sit, kneel or to pull itself up, “Crib Mode” shall not be used anymore for this child and the product should be converted to the next age mode.
- **WARNING:** DO NOT use in “Bedside Mode” on adult beds with a protruding bedframe, where there is a gap created between the crib and the adult bed.
- **When in “Bedside Mode”, only use with standard type adult beds, as shown below**

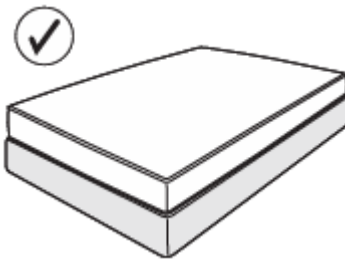

- **DO NOT use with atypical shaped beds as shown below;**

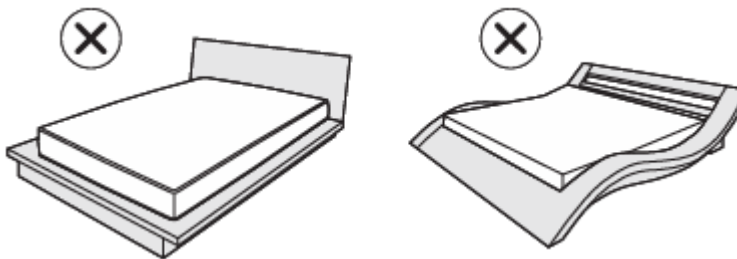

- **The height from the floor of the adult bed on which the crib may be installed in “Bedside Mode” shall be between 56 and 72cm, as shown below:**

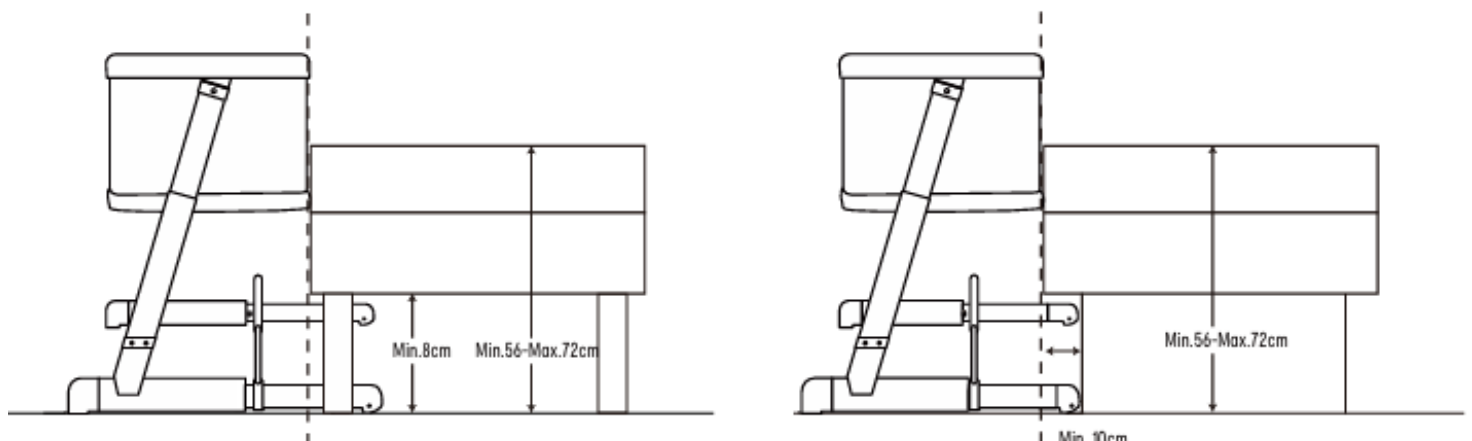

- **WARNING:** Always completely raise the drop side when not attached to the adult bed.
- **WARNING:** “Playpen Mode” is intended for use by one child who is unable to climb out of it and is less than 15kg in weight (approximately 3 years old).

Warnings

- **WARNING:** “Toddler Bed Mode” is intended for use for children from 18 months upto a maximum of 4 years old approximately, or maximum weight of 20kg.
- **WARNING:** Only use the mattress sold with this crib. DO NOT add a second mattress on top of this one – suffocation hazards.
- **WARNING:** DO NOT use more than one mattress in the product.
- **WARNING:** The zipper shall be locked completely during the use of the product, regardless of the configuration used.
- **WARNING:** Be aware of the risk of burning cigarettes, open fires and other sources of strong heat, such as electric bar fires, gas fires etc. near the crib.
- **WARNING:** DO NOT place the product close to another product, which could present a danger of suffocation or strangulation, e.g. strings, blind/curtain cords etc.
- When not in use, the crib must be kept out of the reach of children.
- **WARNING:** Make sure the users of this product are knowledgeable on its proper operation.
- **WARNING:** The product is ready for use only when all locking mechanisms are engaged. Check carefully that these are engaged before use.
- **WARNING:** Placing additional items in the product may cause suffocation.
- **WARNING:** When the child is left unattended in the product, in “crib mode”, always make sure that the side rail is raised and the zips are completely closed.
- **WARNING:** When the child is left unattended in the product, in “crib mode”, the wheels must always be locked.
- **WARNING:** Always ensure that the rocker feet are folded when a child is unsupervised.
- **WARNING:** DO NOT use the product without the frame.
- The mattress length and width shall be such that the maximum gap between the mattress and crib sides and ends does not exceed 30mm.
- Crib mattress size: 85cm length x 52cm width x 2cm thickness.
- The thickness of the mattress must be such that the vertical height (upper surface of the mattress until the upper edge of the product’s sides) is at least 200mm.
- The reference mark on the product’s interior indicates the maximum thickness of the crib mattress that shall be used.
- DO NOT leave any object inside the product that could reduce its depth.
- **WARNING:** The “Toddler Bed Mode” is suitable for a mattress 120cm length and 60cm width and 10cm thickness.
- **WARNING:** DO NOT use a water mattress.
- **WARNING:** DO NOT use plastic bags or other plastic films as a mattress cover as they can cause suffocation.
- **WARNING:** DO NOT position near heat sources, windows or other furniture.
- **WARNING:** Children are likely to play, bounce, jump and climb on beds, therefore when in “Toddler Bed Mode” it should not be placed too close to other furniture or windows, and

Warnings

should be paced either tight to any wall or have a gap of 300mm between the wall and the side of the bed.

- **WARNING:** Strings can cause strangulation. Do not place items with a string around a child's neck. Do not suspend string over the bed or attach strings to toys.
- The product must always be placed on a horizontal surface. Never leave the product on an inclined surface with the child inside of it.
- DO NOT position the product near walls and obstacles to prevent trapping hazards.
- DO NOT leave small objects inside the product to prevent choking hazards.
- DO NOT adjust the product with the child inside.
- DO NOT move the product with the child inside.
- Never use the product without first carefully checking ALL locking mechanism are fully engaged.
- All opening, adjusting, anchoring and positioning operations of the product must be carried out exclusively by an adult.
- All assembly fittings should always be tightened properly and fittings should be checked regularly and re-tightened as necessary.
- Never sit or lean on the top rails, or hang objects from them as this will likely damage the product and it's mechanisms.
- The product must be kept away from electric cables and cords: do not place the product near windows where cords, curtains or similar objects could pose choking or strangulation hazards for the child. To avoid strangulation hazards, do not give to your child or place near her/him, objects equipped with cords.
- **WARNING:** Choking hazard due to small parts.
- **WARNING:** DO NOT use the product if any part is broken, torn or missing. Contact thenurserystore.com/contact-us for replacement parts and instructional literature
- DO NOT use accessories or replacement parts other than those approved by the manufacturer.
- **WARNING:** Before assembly, check that the product and all of its components have not been damaged during transportation. Should any part be damaged, do not use and keep out of reach of children.
- This product is designed to be dismantled when adjusting the configuration.
- This Crib and Toddler Bed conforms to EN 1130:2019, EN 12227:2010 and BS 8509:2008+A1:2011.

Symbols and their meaning

There are a number of symbols used through this manual, please find below breakdown of what each symbol is and what it means.



Direction indicator showing direction of assembly, rotation, function.

Before Assembly

Before assembly, please ensure that you have read and understood the instructions. Then carefully unpack your crib and ensure that all parts are present, please see parts list as follows.

Discard packaging in accordance with your local authority guidelines.

What's in the box

x1 Puggle Dreamy Sleeper Crib and Toddler Bed

x1 Instruction Manual

Parts

Parts List

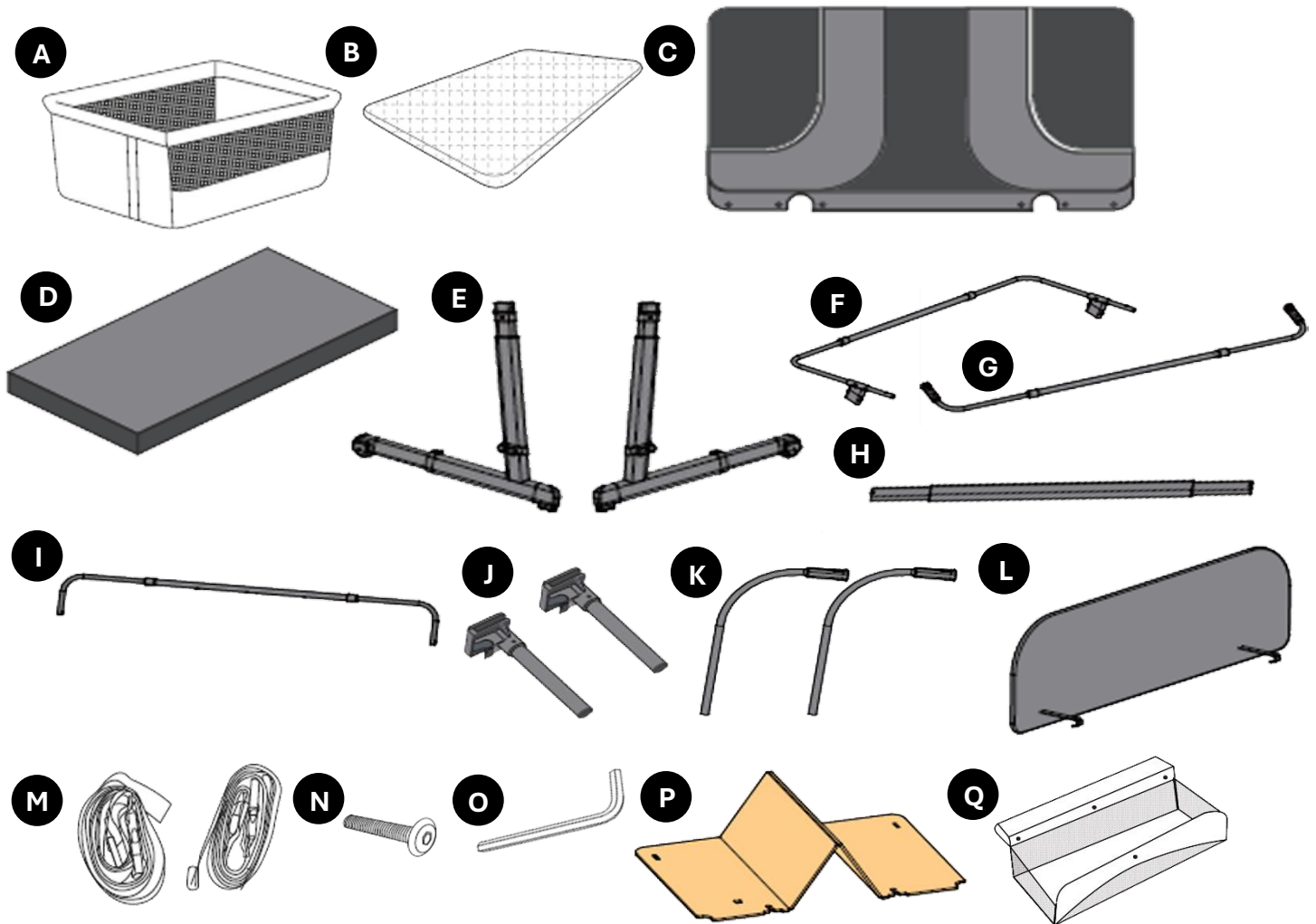

Parts included with your Dreamy Sleeper Crib and Toddler Bed are:

Part	Description	Quantity	Part	Description	Quantity
A	Crib Body	1	J	Support Feet	2
B	Crib Mattress	1	K	Lateral Support	2
C	Toddler Bed Body	1	L	Guardrail	1
D	Toddler Bed Mattress	1	M	Safety Straps	2
E	Side Frames	2	N	Bolt	4
F	Long Top Railing	1	O	Allen Key	1
G	Short Top Railing	1	P	Base Board	1
H	Rear Support Bar	1	Q	Basket	1
I	Front Brace Bar	1			

Assembling the Dreamy Sleeper – Crib Mode

1. Insert the Rear Support Bar (H) into both of the Side Frames (E) as shown right, when fully inserted it will click into place.

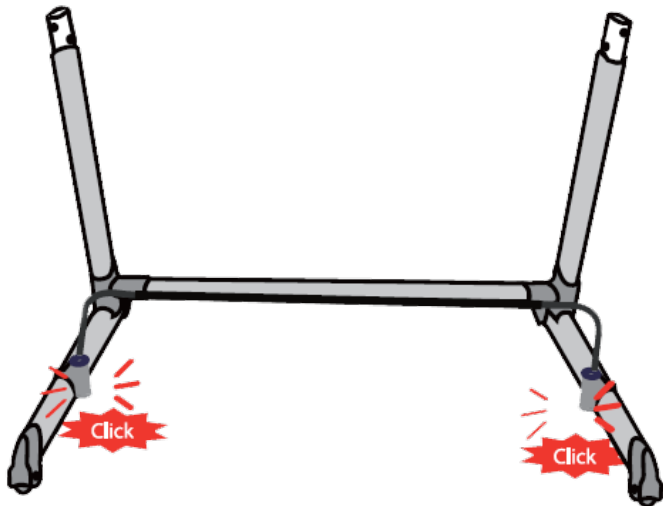
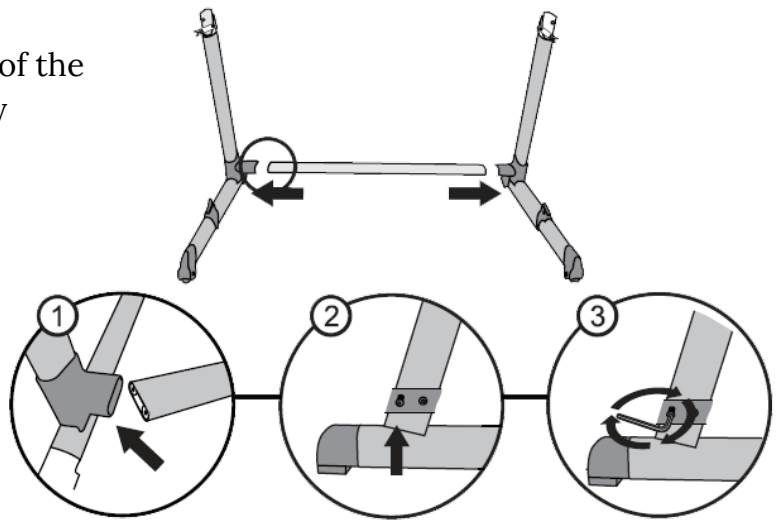

2. Insert the Front Brace Bar (I) into both of the Side Frames (E) as shown left. When fully inserted the Front Brace Bar (I) should click into place and the spring pin will pop out of the corresponding holes on the Side Frames (E).

3. Attach the Basket (Q) to both the Front Brace Bar (I) and the Rear Support (H) as shown right. When the Basket (Q) is fully inserted, secure in place using the press studs.

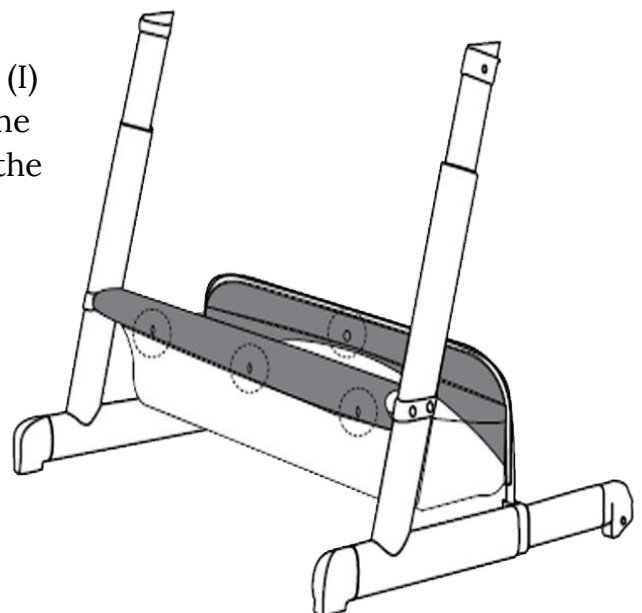

Assembling the Dreamy Sleeper – Crib Mode

3. Attach the Long Top Railing (F) onto the Side Frames (E). Attach the Crib Body (A) to the assembled frame and then seal the zip to ensure The Crib Body (A) is in place. Insert the Short Top Railing (G) into the front fabric of the Crib Body (A).
4. If using the crib in one of the higher positions, the feet will need to be extended to provide counter balance. To extend the feet, press the springs pins in on either side and pull the feet out. The feet will click in place when secure.

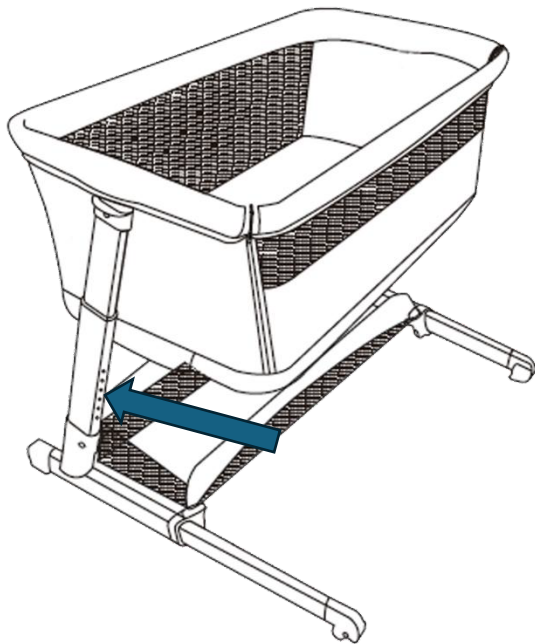
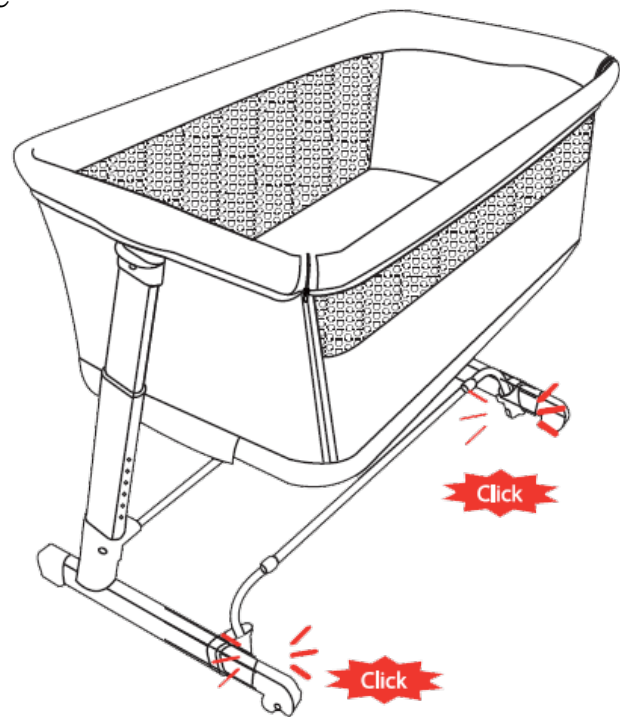

5. To adjust the crib position, simply press the spring pins either side and lower or raise the Crib Body (A). The crib will click into place and the spring pin will protrude through the frame.
6. The crib can be placed on a slight incline by placing one side higher than the other, to do this simply adjust one side at a time.

WARNING: If the crib is positioned on an incline, the head of the child should always be positioned on the highest side.

WARNING: The crib can be inclined with a maximum variance of 2 positions between one leg and the other leg (e.g. the right leg in position 3 and the left leg in position 1).

WARNING: When not attached to an adult bed, all sides should be placed in the highest of the 7 height settings as shown right.

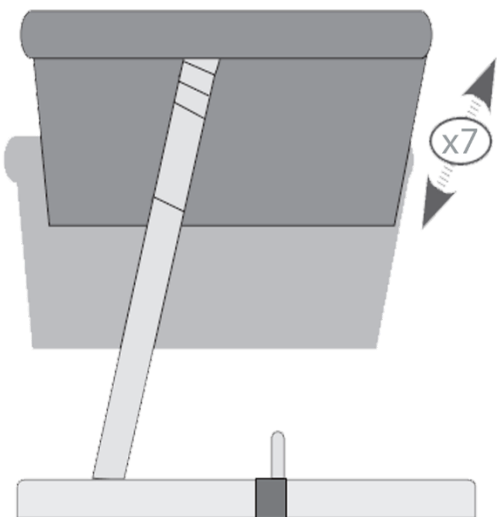

Assembling the Dreamy Sleeper – Bedside Mode

7. Unlock the zipper as shown right on both sides of the Crib Body (A).

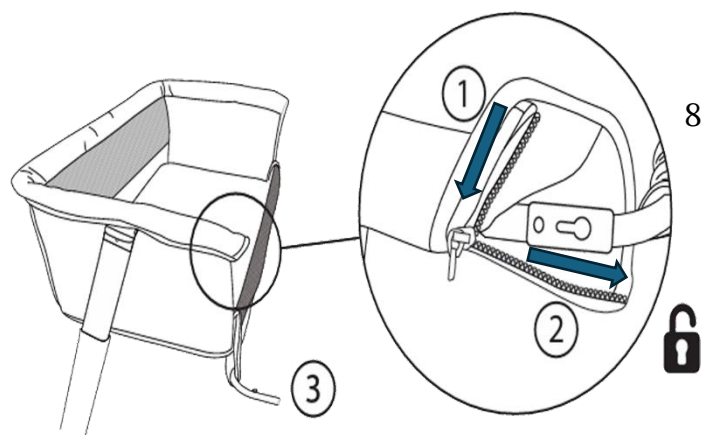
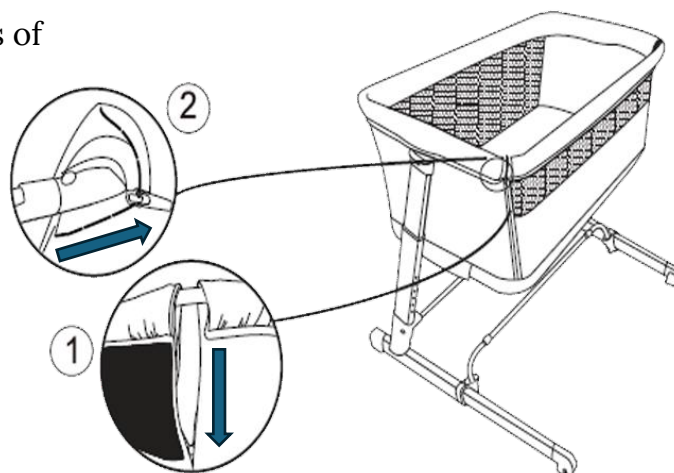

8. Release the Short Top Railing (G) by pressing the release catch from both the top and bottom. Then pull the Short Top Railing (G) out and away from the Long Top Railing (F). Fold the front of the Crib Body (A) as shown left.

9. Move the crib close to the adult bed to be attached to and then check the height of the crib compared with the mattress. The height of the crib should be adjusted where necessary to ensure that the mattress of the adult bed is aligned with or above the height of the crib dropside in the lowest position.

WARNING: In “Bedside Mode” both crib legs should always be adjusted to the same height position. **DO NOT** install on an incline.

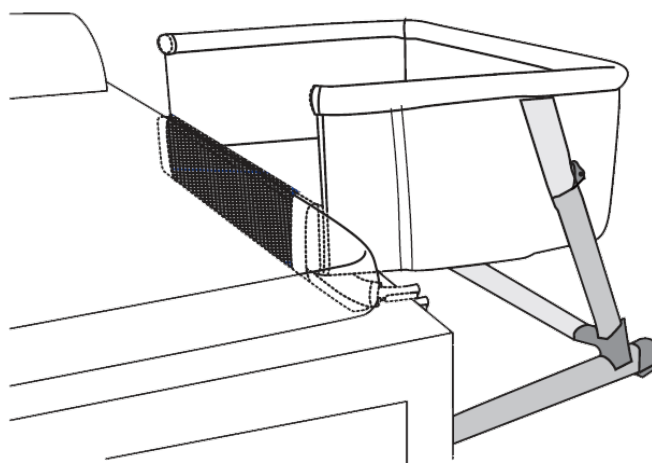

Assembling Dreamy Sleeper – Bedside Mode

- Secure the crib to the adult bed, using the Safety Straps (M). Loop the Safety Straps (M) around the mattress and clip into place on the Crib Body (A).

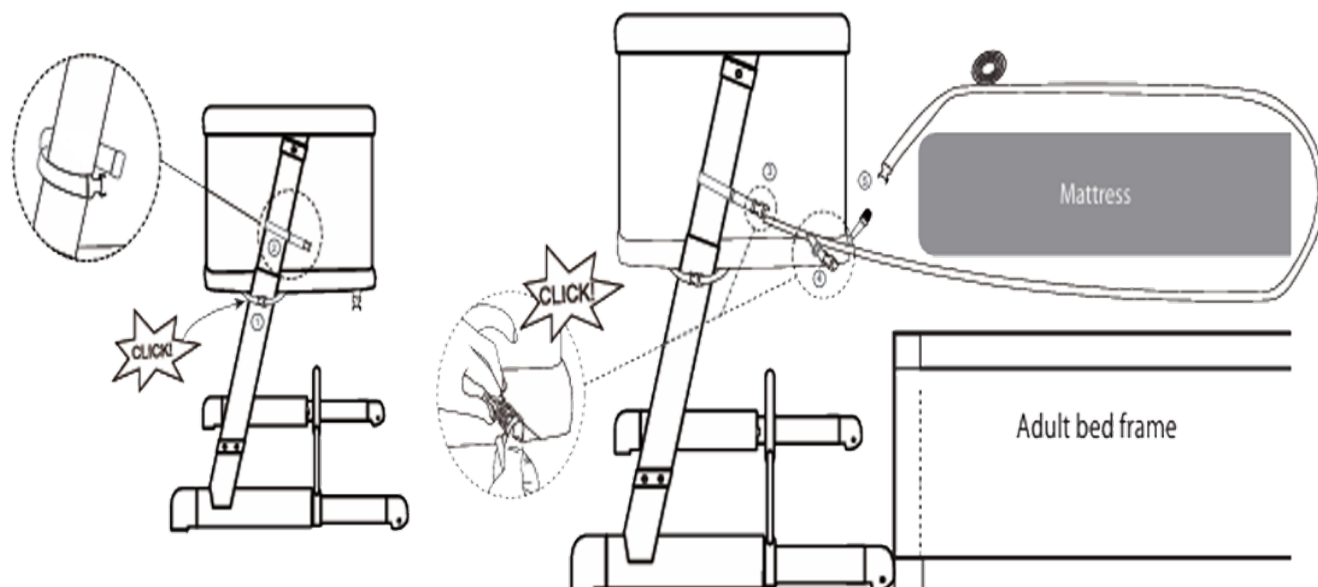

WARNING: Before using in “Bedside Mode” ensure that there is no space between the adult mattress and the side of the crib. If there is, pull the Safety Straps (M) to tighten until there is no space. **DO NOT** use if there is any gap between the crib and adult bed. Gaps should not be filled with pillows, blankets or other items.

WARNING: During use, ensure that the adult bed sheet, blankets etc. do not enter and/or cover the interior of the crib.

Check the tightness of the attachment system before each and every use by pulling the crib away from the adult bed.

WARNING: To avoid strangulation hazards, ensure that the top rail on the side that is next to the adult bed is not higher than the adult bed mattress.

WARNING: To avoid strangulation hazards, ensure that the Safety Straps (M) are always kept away from the crib and reach of children.

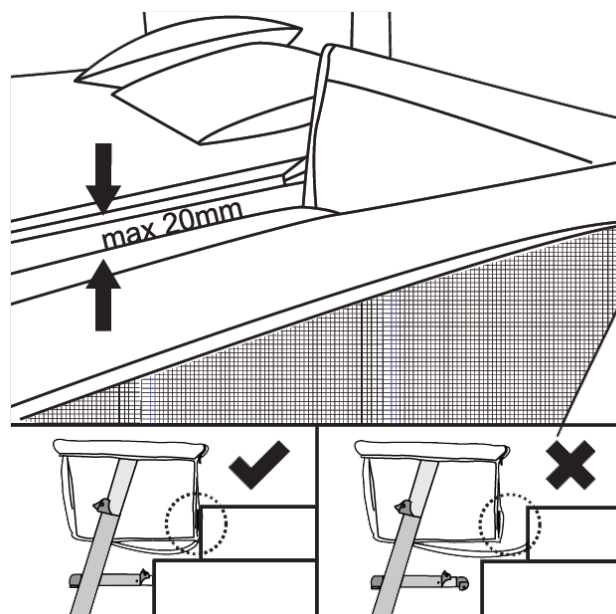

Assembling Dreamy Sleeper – Playpen Mode

11. To convert the crib to “Playpen Mode”, simply unzip the 2 zips around the base of the Crib Body (A) as shown right. Ensure that the crib is in the highest setting as shown below.

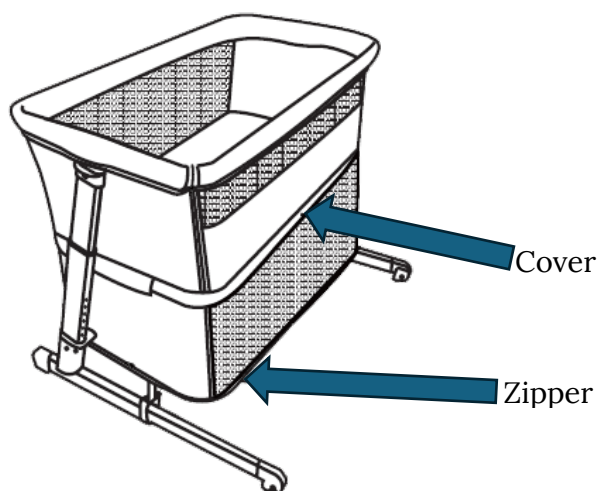
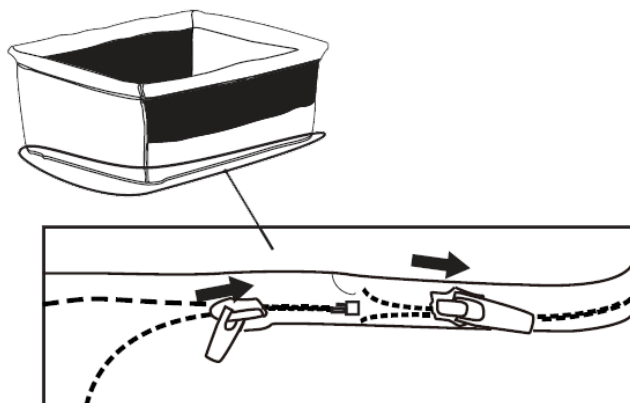
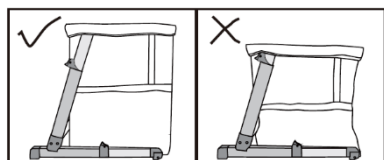

12. Pull the zipper cover down in the centre of the Crib Body (A) as shown left.
13. Secure the buckles in place on the Crib Body (A) to the Side Frames (E).

14. Secure the velcro straps on the underside of the Crib Body (A) to the corresponding cutouts on the Basket (Q) as shown right.

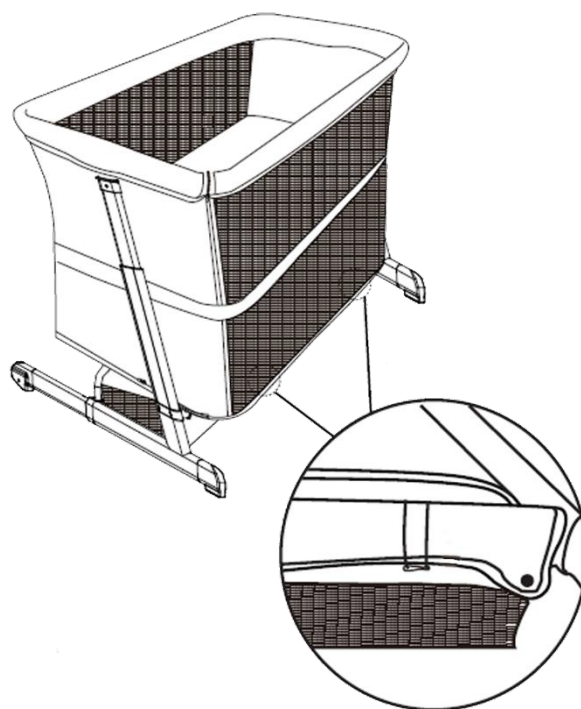

Assembling Dreamy Sleeper – Toddler Bed Mode

14. Extend the feet on the Side Frames (E). To extend the feet, press the springs pins in on either side and pull the feet out. The feet will click in place when secure, ensure the feet are fully extended.

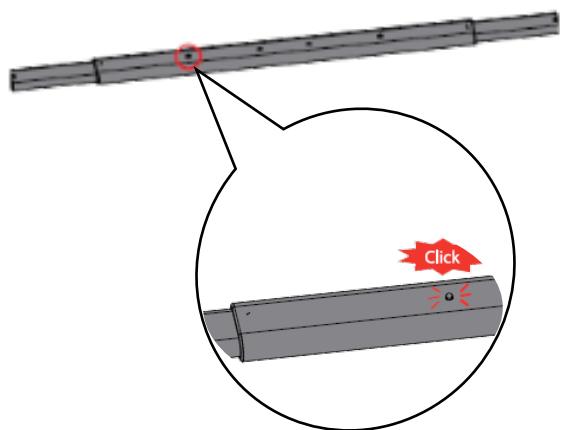
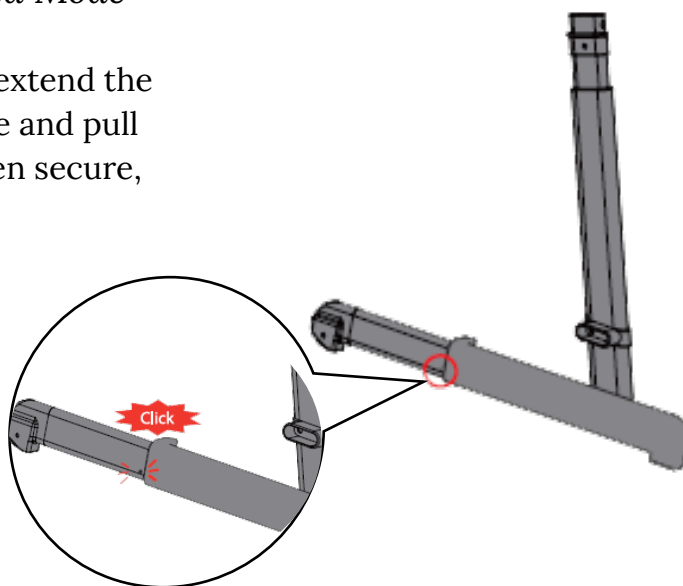

15. Extend the Rear Support Bar (H). To extend press the springs pins in on either side and pull the telescopic part out. The bar will click into place when secure, as shown left.

16. Attach the Rear Support Bar (H) to both Side Frames (E). Raise the Rear Support Bar (H) and the corresponding brackets on both Side Frames (E). Align with the pre-drilled holes on the Side Frames (E) and then fix into place with the Bolts (N). Tighten with the Allen Key (O) as shown below.

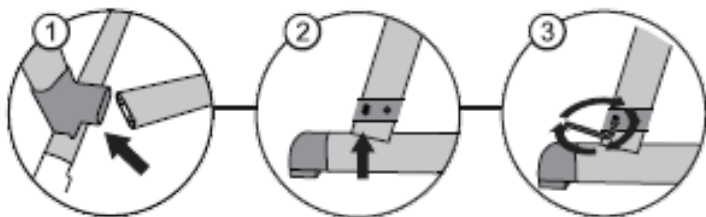

Assembling Dreamy Sleeper – Toddler Bed Mode

17. Extend the Front Brace Bar (I). To extend press the springs pins in on either side and pull the telescopic part out. The bar will click into place when secure, as shown right.

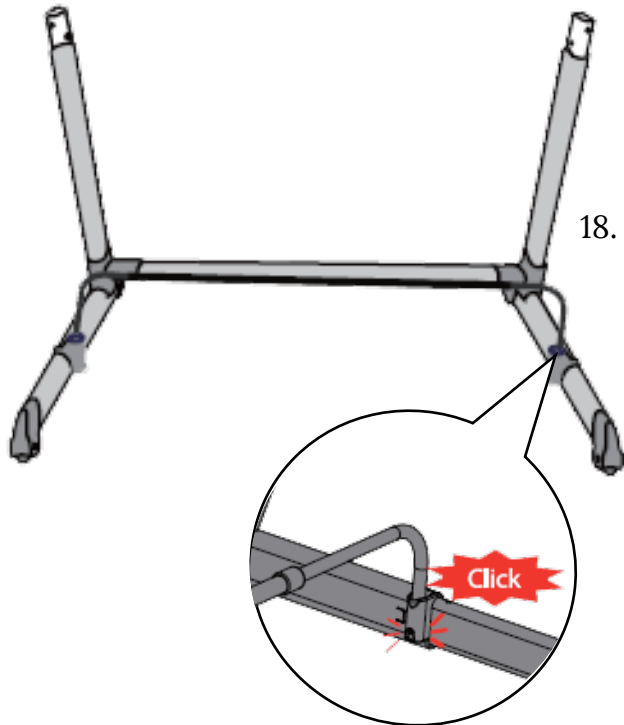
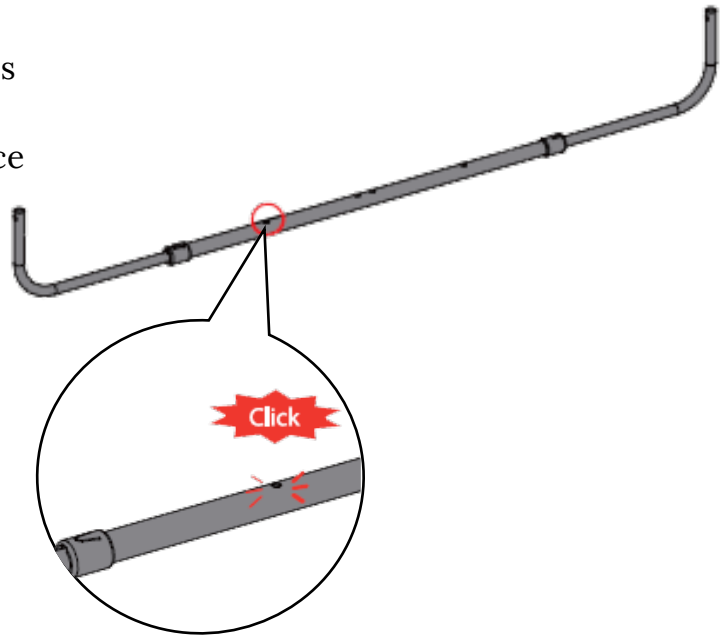

18. Insert the Front Brace Bar (I) into both Side Frames (E) as shown left. The bar will click into place when secure, as shown left.

19. Extend the Long Top Railing (F). To extend press the springs pins in on either side and pull the telescopic part out. The bar will click into place when secure, as shown right.

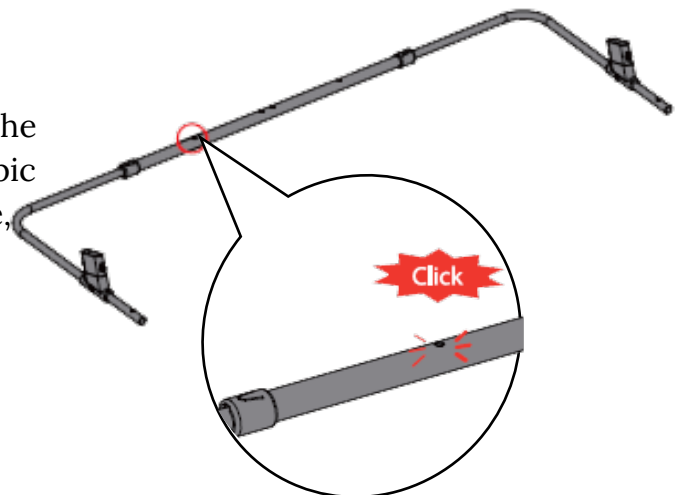

Assembling Dreamy Sleeper – Toddler Bed Mode

20. Insert the Long Top Railing (F) into both Side Frames (E) as shown right. The bar will click into place when secure, as shown right.

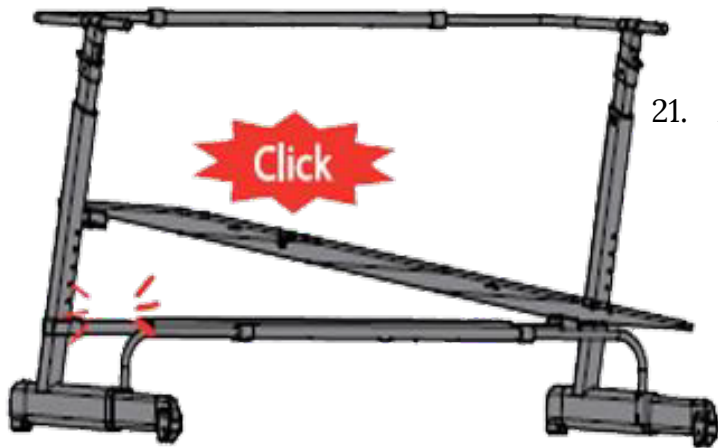
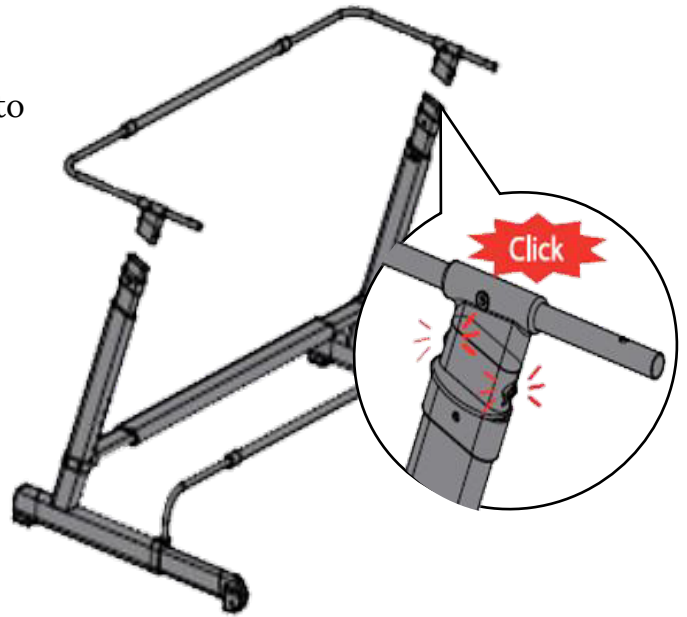

21. Attach the Base Board (P) onto the Rear Support Bar (H) as shown left. The board will click into place when secure, as shown left.

22. Attach the Support Feet (J) to the Base Board (P) into the corresponding slots. The feet will click into place when secure, as shown right.

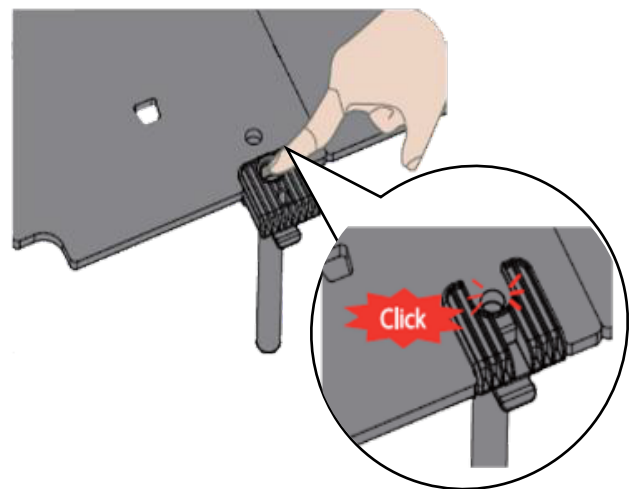

Assembling Dreamy Sleeper – Toddler Bed Mode

23. Attach both of the Lateral Support (K) to the Long Top Railing (F) as shown right. The support will click into place when secure, as shown right.

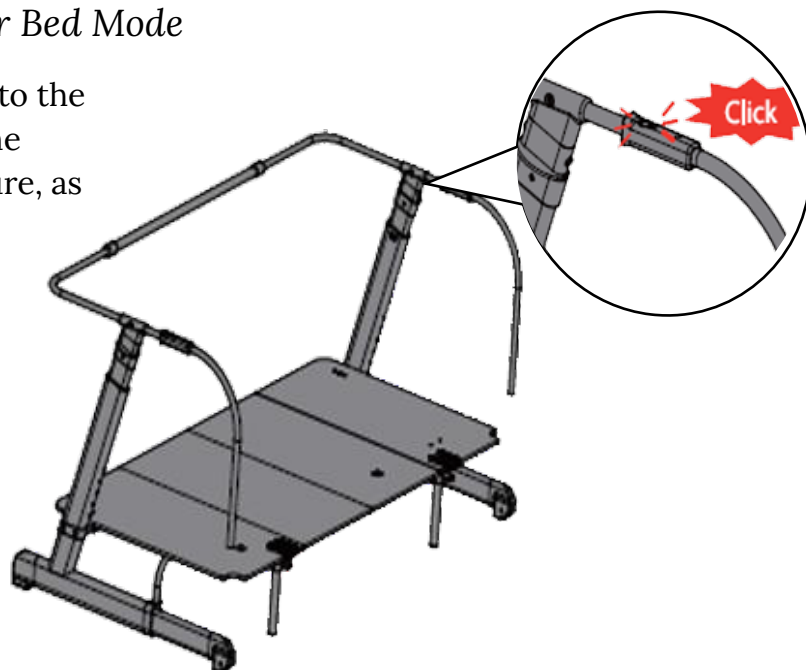

24. Attach the Short Top Railing (G) to both of the Lateral Support (K) as shown left. The bar will click into place when secure, as shown left.

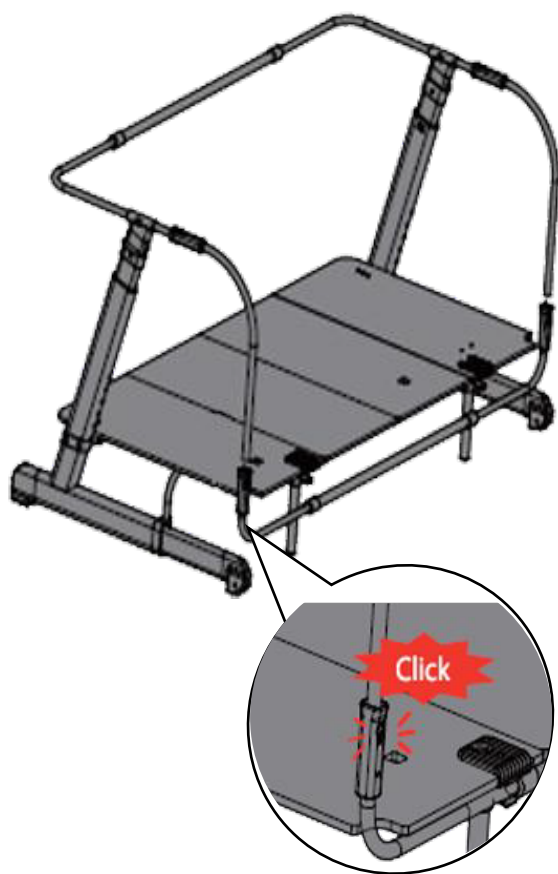

24. Attach the Short Top Railing (G) to the Support Feet (J), simply slot the bar into the corresponding brackets on the Support Feet (J). The bar will click into place when secure, as shown right.

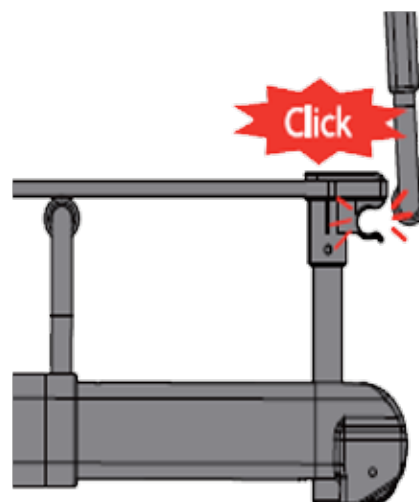

Assembling Dreamy Sleeper – Toddler Bed Mode

25. Attach the Toddler Bed Body (C) to the frame, simply slot the fabric over the frame and then fix the zip into place around the rear of the Toddler Bed Body (C).



26. Pull the side flaps of the Toddler Bed Body (C) down and hook the holes over the corresponding buttons on the base of the Side Frames (E).

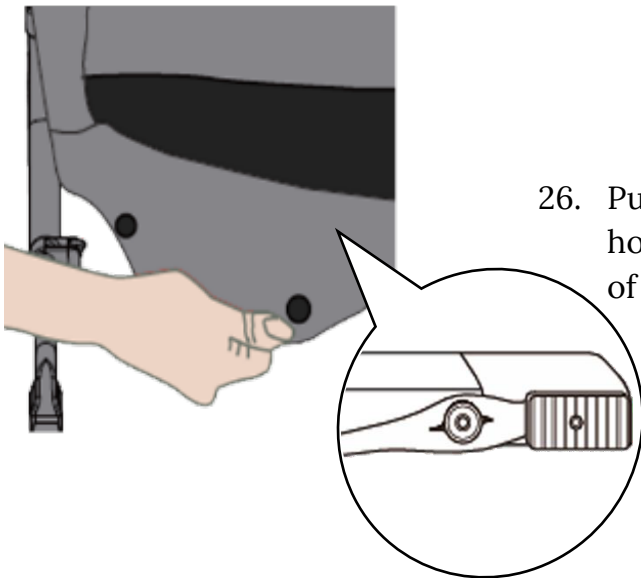

27. Secure the front of the Toddler Bed Body (C) to the Base Board (P) using the press studs as shown right.

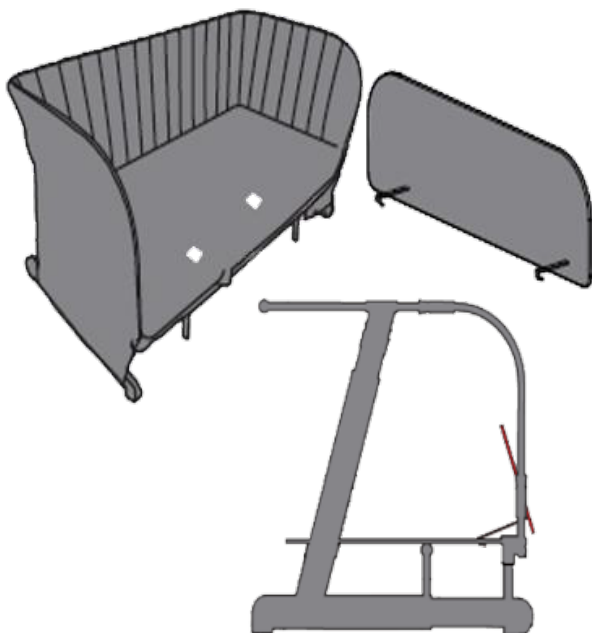
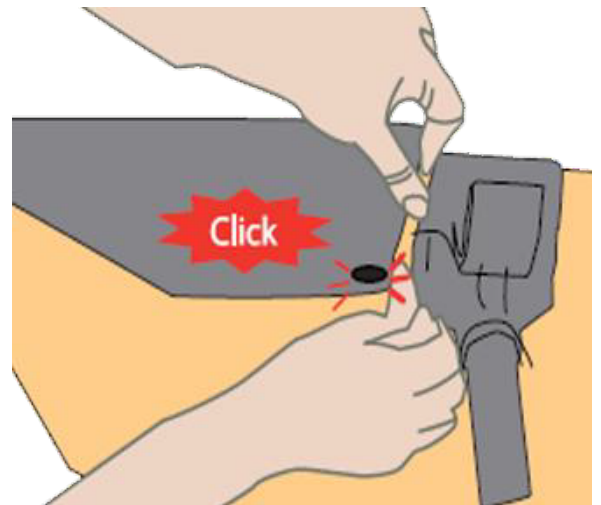

28. Attach the Guardrail (L) to the Toddler Bed Body (C) and Base Board (P) using the 'L shaped' metal bar at the rear of the Guardrail (L) as shown left.

Assembly

Assembling Dreamy Sleeper – Toddler Bed Mode

29. Attach the safety strap attached to the Guardrail (L) to the buckles on the underside of the Front Brace Bar (I) and click into place as shown right.

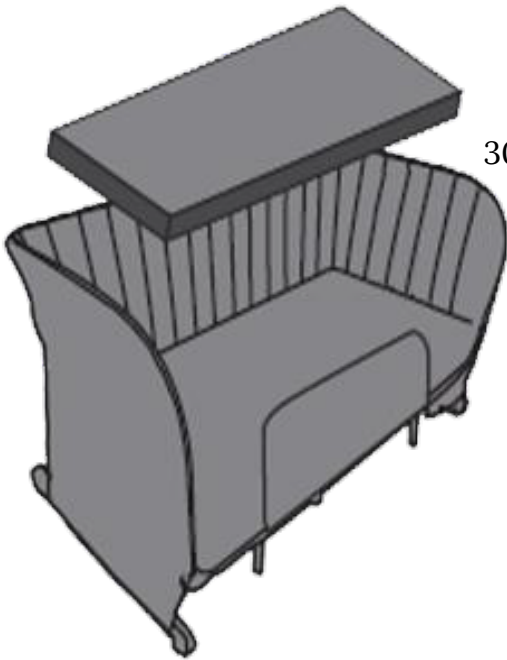
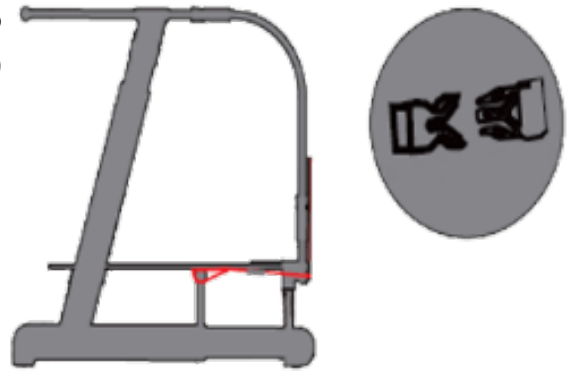

30. Insert the Toddler Bed Mattress (D) onto the Toddler Bed Body (C) as shown left.

Care and Maintenance

Cleaning

- Clean the plastic parts with a soft damp cloth.
- DO NOT use harsh or abrasive cleaners or bleaches on this product, as they may damage the product.
- If the sleeper crib and toddler bed comes into contact with water, dry the metal parts to prevent the formation of rust.

Maintenance

- Cleaning and maintenance should be carried out by an adult, do not allow a child to do this unless supervised and correct instruction has been provided.
- Periodically check all fixings to ensure they remain tight and tighten where required.
- DO NOT use this product if any part is broken, torn or missing and use only spares provided by the manufacturer.
- If parts become stiff or difficult to operate, ensure dirt is not the cause, then try a light application of a silicon lubricant, ensuring it penetrates between the components. Regular lubrication of moving parts will extend the life of your product and make opening and folding easier.
- After exposure to damp conditions, dry off with a soft cloth and leave fully open in a warm environment. Storing damp will encourage mildew to form.
- Store in a dry place.
- DO NOT leave in sunlight for prolonged periods as some colours may fade.

Troubleshooting Tips

Issue	Possible Root Cause	Solution
Joints are not clicking into place.	Joints are misaligned, spring pin is missing, joints have not been fully pressed in.	Ensure assembly instructions are followed in detail.
Spring Pin is missing	The spring pin when depressed has become lodged within the shaft.	Using a pair of long nose pliers, gently pull the spring pin up and guide back into position.
There is a gap between the crib and the adult bed in “Bedside Mode”	The safety straps have not been sufficiently tightened.	Ensure that the assembly instructions (Step 7-10.) have been correctly followed and tighten accordingly where required.
	The bed frame is not suitable for “Bedside Mode”	Where the design of the adult bedframe creates a gap between the adult bed and the crib, do not use in “Bedside Mode”.

For any and all other product issues not covered in the above please contact our dedicated customer services team at the below web address and they will endeavour to resolve any queries that you may have as soon as possible.

thenurserystore.com/contact-us

Recycling the packaging

When you’ve unpacked your product and have ensured that all parts are present, please discard packaging components in accordance with your local authority guidelines, for further information please check the material and your postcode at

<https://www.recyclenow.com/recycle-an-item>. Your packaging will include the following materials;

Carton – 5Ply Corrugated Paper – Widely recycled in your card and paper bin

Polybag – PE Plastic – Recycle with bags at large supermarkets

Notes

[illegible]

Notes

