

PUGGLE

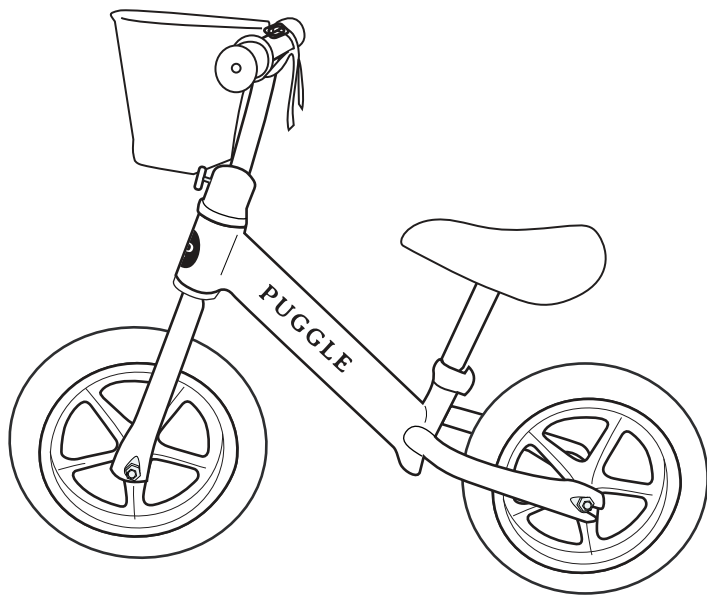

Retro 12" Balance Bike & Basket

Instruction Manual

Welcome

Thank you for purchasing the Puggle Retro 12" Balance Bike & Basket.

This instruction manual will guide you through the setup, use, and maintenance of your new product, ensuring you get the most out of its versatile features. Please read through the following information and safety warnings carefully to fully understand and enjoy all the benefits your Puggle Retro 12" Balance Bike & Basket has to offer, and to ensure its safe operation.

We're here to help!

If you have a query with this product or require replacement parts, please contact us at:
support@pugglebaby.co.uk

Important Information

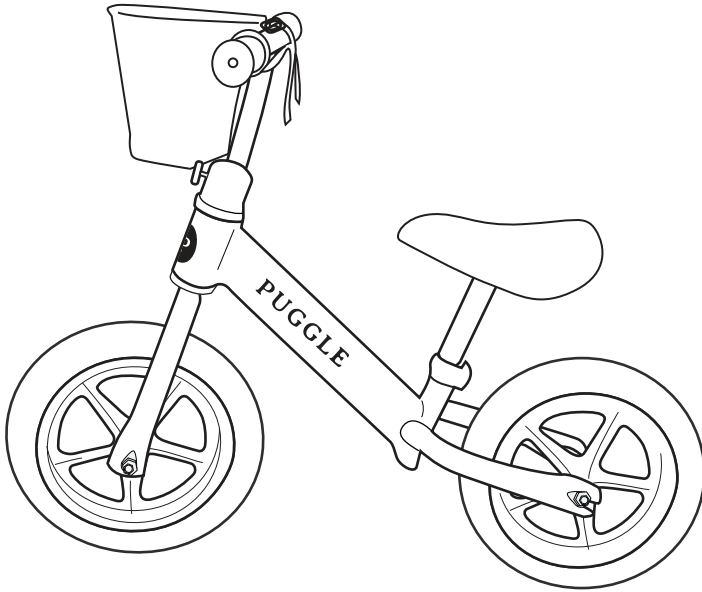

IMPORTANT!

Your Puggle Retro 12 Inch Balance Bike with Basket may differ slightly from images shown above and throughout, as the images used are for illustration purposes only.

Your Puggle Retro 12 Inch Balance Bike with Basket is tested to comply with EN 71.



- Bags and other items should not be hung from the handles as this can affect the stability of the product.
- DO NOT use parts or accessories which are not approved or supplied by the manufacturer.
- DO NOT allow your child to play with this product without adult supervision.

IMPORTANT – Read the instructions carefully before use and keep for future reference.

- **WARNING:** A child's safety is your responsibility.
- **WARNING:** Adult assembly is required.
- **WARNING:** Ensure that all components are fitted securely into place and tightened where applicable before allowing your child to play with the balance bike.
- **WARNING:** Ensure that the child is supervised by an adult when using the balance bike at all times, and is taught about the correct usage of the product.
- **WARNING:** Ensure that all locking devices are engaged before usage.
- **WARNING:** This product is suitable for use by one child at a time only.
- **WARNING:** DO NOT overload this product, maximum capacity is 50kg.
- Approximate age range is 2 to 6 years.
- **WARNING:** Keep hands and other limbs away from moving parts such as the wheel to prevent entrapment and injury.
- **WARNING:** Protective equipment should be worn. Children should wear approved protective equipment e.g. helmet and correct fitting is required.
- **WARNING:** DO NOT allow a child to ride on roadways, public highways or alleys. Not to be used in traffic.
- **WARNING:** DO NOT allow a child to ride on steeply sloped areas, near steps, swimming pools, or other bodies of water.
- For use on smooth, paved surfaces only.
- Ensure that the rider keeps both hands on the handlebar at all time for proper control.
- **WARNING:** DO NOT allow a child to ride the product at dusk, at night or at times of limited visibility.
- Children should be reminded that the toy should be used with caution, since it requires skill, so as to avoid falls or collision causing injury to the user and third parties. They should also be reminded of the dangers of using this product on public highways.
- All assembly fittings should always be tightened properly, checked periodically and the care should be taken that no bolts are loose, because a child could trap parts of the body or clothing (e.g. strings, necklaces, ribbons for babies' dummies), which could pose a risk of suffocation and strangulation.
- Replace broken or worn parts immediately, only use parts supplied or approved by the manufacturer.
- This Puggle Retro 12 Inch Balance Bike conforms to BS EN 71.

Symbols and their meaning

There are a number of symbols used through this manual, please find below breakdown of what each symbol is and what it means.

	European conformity – This mark is applied to both physical product and product packaging, indicating conformity with the relevant European testing standards.
	UK Conformity Assessed – This mark is applied to both physical product and product packaging, indicating conformity with the relevant UKSI testing standards.
	Direction indicator showing direction of assembly, rotation, function.

What’s in the box

- x1 Puggle retro 12" Inch Balance bike
- x1 Instruction Manual

Before Assembly

Before assembly, please ensure that you have read and understood the instructions. Then carefully unpack your balance bike and ensure that all parts are present, please see parts list as follows.

Discard packaging in accordance with your local authority guidelines.

The balance bike should be assembled on a clean surface, free from any sharp objects that could mark or damage the product.

CAUTION: There are many small components used in the construction of this balance bike. These items should be kept out of reach of young children whilst assembling the unit.

Parts List

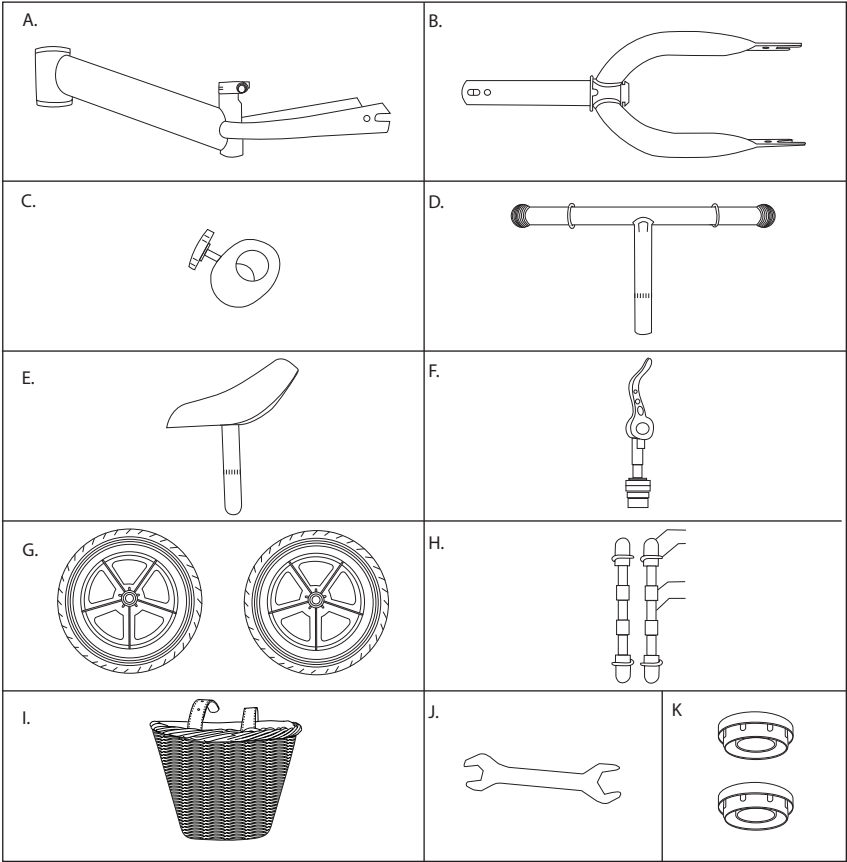

Part	Description	Quantity
A	Bike frame	1
B	Front wheel u fork	1
C	Front bar adjuster	1
D	Handlebar	1
E	Seat unit	1
F	Seat adjuster clamp	1
G	Wheels	2
H	Wheel Axle	2
I.	Basket	1
J.	Spanner	1
K.	Tubing collars	2
i.	Domed locking nut (not shown above)	4
ii.	Clip washer (not shown above)	4
iii.	Nut (not shown above)	4
iv.	Sleeve (not shown above)	4
iv.	Axle Bolt (not shown above)	2

Assembling the Balance Bike

1. Insert tubing collars into the front of the bike frame.

Insert the Front Wheel U Fork (B) into the front of the bike frame (A)



2. With the screw loosened, place the front bar adjuster (C) over the top of the Front Wheel U Fork (B)

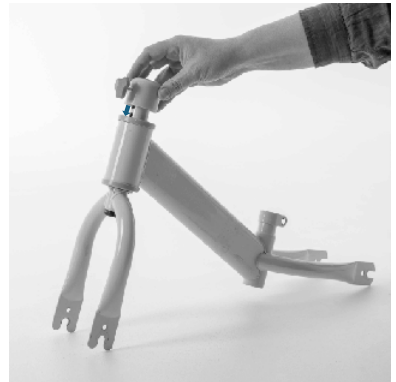

3. Insert the handlebar (D) through the front bar adjuster (C) into the top of the Front wheel u fork (B). Ensure the bar is inserted until the minimum depth markings are hidden

Tighten the front bar adjuster screw

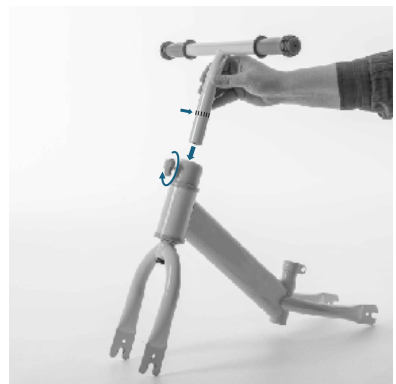

Assembling the Balance Bike

4. Disassemble the wheel axle (H), leaving a sleeve (iv) and nut(iii) on one side. Insert the free end of the axle bolt (v) through the middle of the wheel (G) and replace the sleeve (iv) and nut(iii) on the other side the nut and tighten fully



5. Slide the wheel axle (H) into the wheel fork. The sleeve and nut should be on the inside of the fork.

Secure both sides of the wheel axle to the bike frame with the clip washer (ii) and domed locking nut (i). Ensure that the clip part of the washer is inserted into the hole just above the fork.



6. Use the spanner (J) to tighten the domed locking nuts equally on each side of the bike, until the wheel forks are pulled together and there is no axle rod visible.

The wheel should not move from side to side on the axle

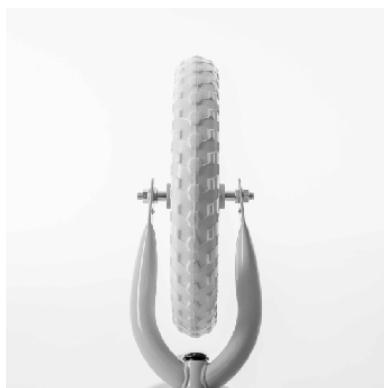

Assembling the Balance Bike

7. Unscrew the clamp nut (i) on the seat adjuster clamp (F)



8. Insert the clamp (F) through the holes in the central seat frame. Replace the nut and tighten as much as possible by hand

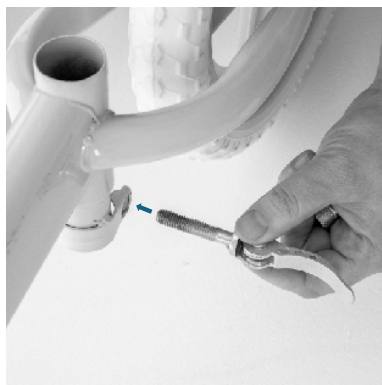

9. Insert the seat unit (E) into the bike frame (A) when it is at the desired height, push the seat adjuster clamp (F) forward until it completely closes. The bar must be inserted until the minimum depth markings are hidden.



10. Ensure that the seat post is secure and does not move. The bike is now ready for use.

Maintenance & Extra Bits

Cleaning

- Scuff marks may be removed with a soft, damp cloth.
- DO NOT use harsh or abrasive cleaners or bleaches on this product, as they may damage the product.

Maintenance

- Periodically check all fixings to ensure they remain tight and tighten where required.
- Regularly inspect the wheels, locks, harness, catches, seat adjusters, joints and fixings to ensure they are clean, operating correctly and in full working order.
- Do not use this product if any part is broken, torn or missing and use only spares provided by the manufacturer.
- If parts become stiff or difficult to operate, ensure dirt is not the cause, then try a light application of a silicon lubricant, ensuring it penetrates between the components. Regular lubrication of moving parts will extend the life of your product and make opening and folding easier.
- After exposure to damp conditions, dry off with a soft cloth and leave fully open in a warm environment. Storing damp will encourage mildew to form.
- Store in a dry place.
- Do not leave in sunlight for prolonged periods as some colours may fade.

Troubleshooting Tips

Issue	Possible Root Cause	Solution
Moving parts are stiff, in particular axle, handlebars etc.	Lack of lubricant.	Lubricate joint as per the instructions in the maintenance section.
The seat clamp is not tight enough to hold the seat post securely.	Loose clamp nut	Tighten the clamp nut using a tool, such as a pair of plyers or adjustable spanner

Recycling the packaging

When you've unpacked your product and have ensured that all parts are present, please discard packaging components in accordance with your local authority guidelines, for further information please check the material and your postcode at <https://www.recyclenow.com/recycle-an-item>.

Your packaging will include the following materials;

Carton - 5Ply Corrugated Paper - Widely recycled in your card and paper bin

PolybagPE Plastic - Recycle with bags at large supermarkets.

Notes

Handwriting practice lines consisting of 18 horizontal dashed lines.

